

NEW MEXICO OIL CONSERVATION COMMISSION
Santa Fe, New Mexico

Form G-101
Revised (12/1/55)

NOTICE OF INTENTION TO DRILL

Notice must be given to the District Office of the Oil Conservation Commission and approval obtained before drilling or recompletion begins. If changes in the proposed plan are considered advisable, a copy of this notice showing such changes will be returned to the sender. Submit this notice in QUINTUPPLICATE. One copy will be returned following approval. See additional instructions in Rules and Regulations of the Commission. If State Land submit 6 Copies Attach Form G- 128 in triplicate to first 3 copies of form G-101

Midland, Texas

May 15, 1957

(Place)

(Date)

OIL CONSERVATION COMMISSION
SANTA FE, NEW MEXICO

Gentlemen:

You are hereby notified that it is our intention to commence the Drilling of a well to be known as

Standard Oil Company of Texas

(Company or Operator)

J. H. Everest

(Lease)

Well No. 1, in L. The well is

(Unit)

located 660 feet from the West line and 1980 feet from the

South line of Section 14, T. 18-S, R. 26-E, NMPM.

(GIVE LOCATION FROM SECTION LINE) 660 West Pool, 1980 Eddy County

If State Land the Oil and Gas Lease is No.

If patented land the owner is J. H. Everest Est.

Address Liberty National Bank & Trust, Oklahoma City, Okla.

We propose to drill well with drilling equipment as follows: Rotary O - TD

The status of plugging bond is Blanket Bond

Drilling Contractor Delta Drilling Company

We intend to complete this well in the Lower Pennsylvanian formation at an approximate depth of 9800 feet.

CASING PROGRAM

We propose to use the following strings of Casing and to cement them as indicated:

| Size of Hole | Size of Casing | Weight per Foot | New or Second Hand | Depth | Sacks Cement |
|--------------|----------------|-----------------|--------------------|-----------------|-----------------------|
| 17-1/2" | 13-3/8" | 48# | New | 1200' or deeper | Circ. to surface |
| 12-1/4" | 9-5/8" | 36# | New | 3300' | Bring back to 13-3/8" |
| 8-3/4" | 7" | 23# and 26# | New | 9800 | 500 |

If changes in the above plans become advisable we will notify you immediately.

ADDITIONAL INFORMATION (If recompletion give full details of proposed plan of work.)

Approved _____, 19____
Except as follows:

OIL CONSERVATION COMMISSION

By M. L. Armstrong

Sincerely yours,

Standard Oil Company of Texas

(Company or Operator)

By

E. O. Holloway

Position Petroleum Engineer
Send Communications regarding well to

Name Standard Oil Company of Texas

Address P. O. Box 1660, Midland, Texas

NEW MEXICO
OIL CONSERVATION COMMISSION

Form C-128

Well Location and/or Gas Proration Plat

Date 4-24-1957

Operator STANDARD OIL CO. OF TEXAS

Lease J. H. EVEREST

Well No. 1 Section 14 Township 18 S Range 26 E NMPM

Located 1980 Feet From SOUTH Line, 660 Feet From WEST Line,

EDDY County, New Mexico. G. I. Elevation Will Report Later

Name of Producing Formation Lower Pennsylvanian Pool Wildcat Dedicated Acreage 40

(Note: All distances must be from outer boundaries of Section)

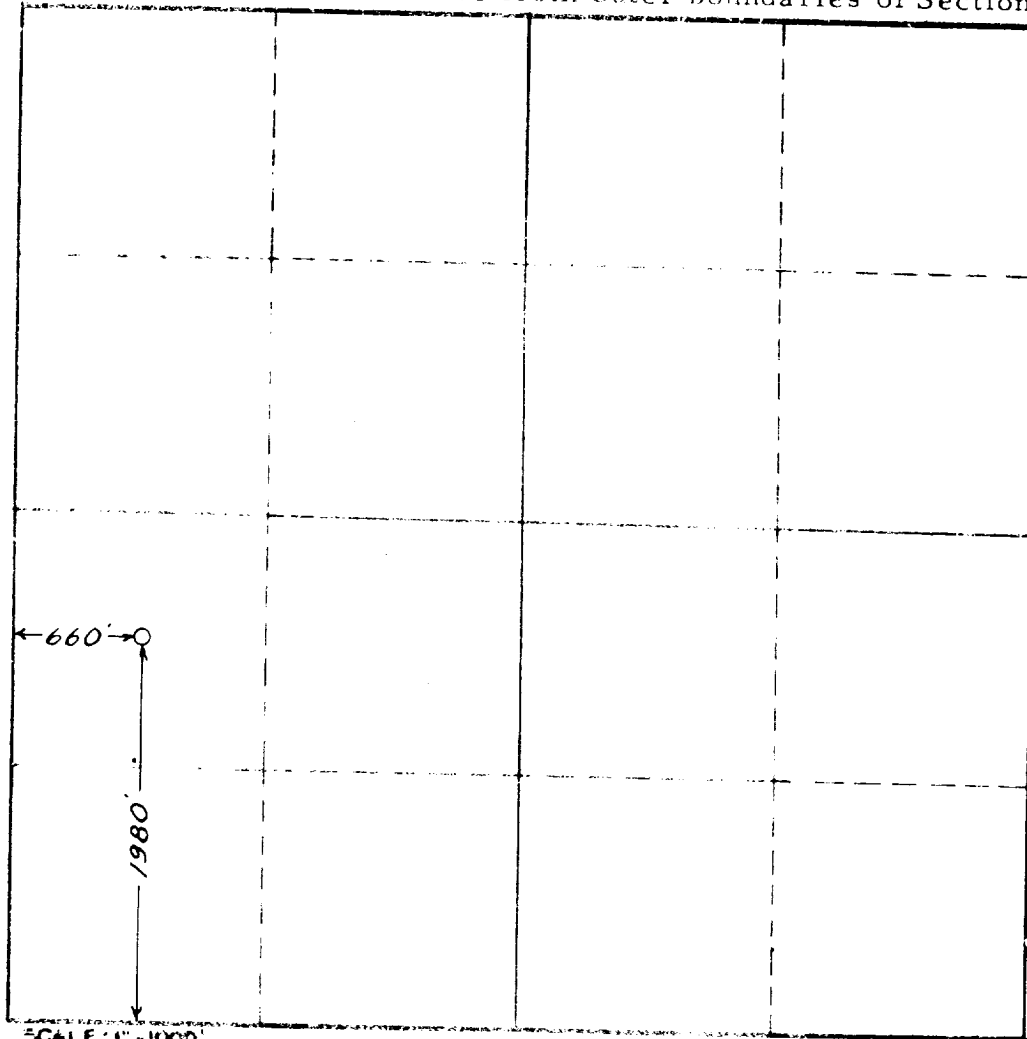

Is this Well a Dual Comp? Yes ☐ No ☐

If the answer to Question 1 is yes, are there any other dually completed wells within the dedicated acreage? Yes ☐ No ☐

This is to certify that the above plat was prepared from field notes of actual surveys made by me or under my supervision and that the same are true and correct to the best of my knowledge and belief.

Date Surveyed 4-24-57

Registered Professional Engineer and/or Land Surveyor John W. West

APR 19
STANDARD INDUSTRIAL

1
2
3
4
5
6
7
8
9
10
11
12

5
1
1
2
1

✓