

NEW MEXICO
OIL CONSERVATION COMMISSION

Form C-128

Well Location and/or Gas Proration Plat

Date 1-25-57

Operator Standard Oil Co. of Texas

Lease Block E. Vinther, et al

Well No. 2 Section 12 Township 18 S Range 26 E NMPM

Located 1650 Feet From West Line, 2310 Feet From South Line,

Eddy County, New Mexico. G. L. Elevation 5512 Report Station

Name of Producing Formation San Andres Pool Undertaken Dedicated Acreage 1/4

(Note: All distances must be from outer boundaries of Section)

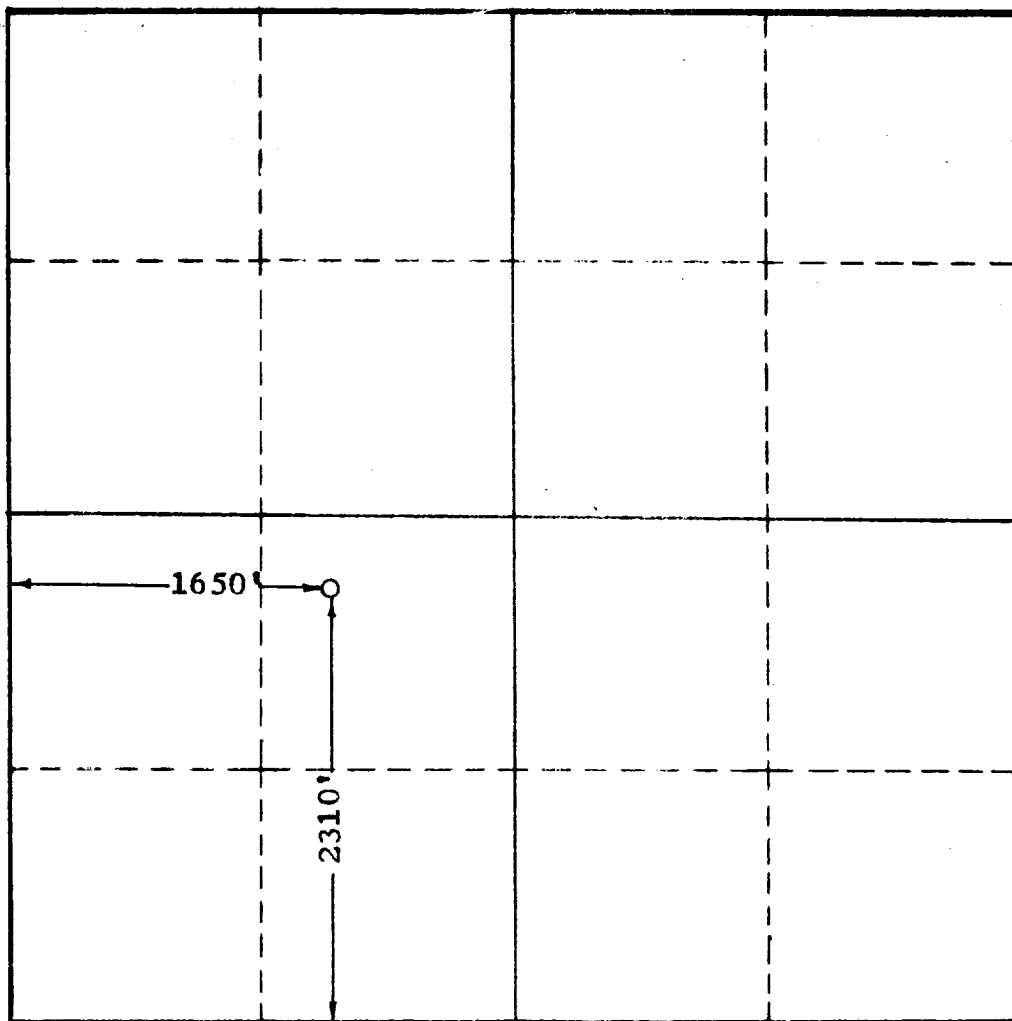

SCALE: 1"=1000'

1. Is this Well a Dual Comp. ? Yes No
2. If the answer to Question 1 is yes, are there any other dually completed wells within the dedicated acreage? Yes No

This is to certify that the above plat was prepared from field notes of actual surveys made by me or under my supervision and that the same are true and correct to the best of my knowledge and belief.

Name
Position
Representing
Address

Date Surveyed 1-25-57
John W. West
Registered Professional Engineer and/or
Land Surveyor