

Form 9-331a
(Feb. 1961)

(SUBMIT IN TRIPLICATE)

UNITED STATES
DEPARTMENT OF THE INTERIOR
GEOLOGICAL SURVEY

Land Office Las Cruces

Lease No. LC 065478 (B)

Unit _____

30-015-00754

SUNDRY NOTICES AND REPORTS ON WELLS

NOTICE OF INTENTION TO DRILL.....	<input checked="" type="checkbox"/>	SUBSEQUENT REPORT OF WATER SHUT-OFF.....	
NOTICE OF INTENTION TO CHANGE PLANS.....		SUBSEQUENT REPORT OF SHOOTING OR ACIDIZING.....	
NOTICE OF INTENTION TO TEST WATER SHUT-OFF.....		SUBSEQUENT REPORT OF ALTERING CASING.....	
NOTICE OF INTENTION TO RE-DRILL OR REPAIR WELL.....		SUBSEQUENT REPORT OF RE-DRILLING OR REPAIR.....	
NOTICE OF INTENTION TO SHOOT OR ACIDIZE.....		SUBSEQUENT REPORT OF ABANDONMENT.....	
NOTICE OF INTENTION TO PULL OR ALTER CASING.....		SUPPLEMENTARY WELL HISTORY.....	
NOTICE OF INTENTION TO ABANDON WELL.....			

(INDICATE ABOVE BY CHECK MARK NATURE OF REPORT, NOTICE, OR OTHER DATA)

USA HALCO REFINERIES "H"

November 5, 1958

Well No. 1 is located 1980 ft. from N line and 660 ft. from E line of sec. 3

NE 1/4 SE 1/4 Sec. 3
(1/4 Sec. and Sec. No.)

T-18-S
(Twp.)

R-27-E
(Range)

N.M.P.M.
(Meridian)

Empire Abo
(Field)

Eddy
(County or Subdivision)

New Mexico
(State or Territory)

RECEIVED

The elevation of the derrick floor above sea level is _____ ft. furnish later. NOV 10 1958

DETAILS OF WORK

(State names of and expected depths to objective sands; show sizes, weights, and lengths of proposed casings; indicate mudding jobs, cementing points, and all other important proposed work)

We propose to drill the above well with rotary tools to an approximate depth of 6200' to test the Abo. Casing program will be as follows:

Size of Hole	Size of Casing	Depth	Comment
11"	8-5/8"	950	Circulate 2% Gel w/100 sacks neat on bottom.
7-7/8"	5-1/2"	6200	150 sacks neat.

I understand that this plan of work must receive approval in writing by the Geological Survey before operations may be commenced.

Company Pan American Petroleum Corporation

Address Post Office Box 68

Hobbs

New Mexico

By Ralph H. Hendrickson

Title Field Superintendent

NEW MEXICO OIL CONSERVATION COMMISSION
Well Location and Acreage Dedication Plat

Section A.

Date October 18, 1958

Operator Pan American Pet. Corp. Lease Malco Refineries 'H'
Well No. 1 Unit Letter I Section 3 Township 18 South Range 27 East NMFM
Located 660 Feet From East Line, 1980 Feet From South Line
County Eddy C. L. Elevation furnish later Dedicated Acreage 40 Acres
Name of Producing Formation Abo Pool Empire Abo

1. Is the Operator the only owner* in the dedicated acreage outlined on the plat below?
Yes ☒ No ☐.
2. If the answer to question one is "no," have the interests of all the owners been consolidated by communitization agreement or otherwise? Yes ☐ No ☐. If answer is "yes," Type of Consolidation _____
3. If the answer to question two is "no," list all the owners and their respective interests below:

Owner

Land Description

Section B

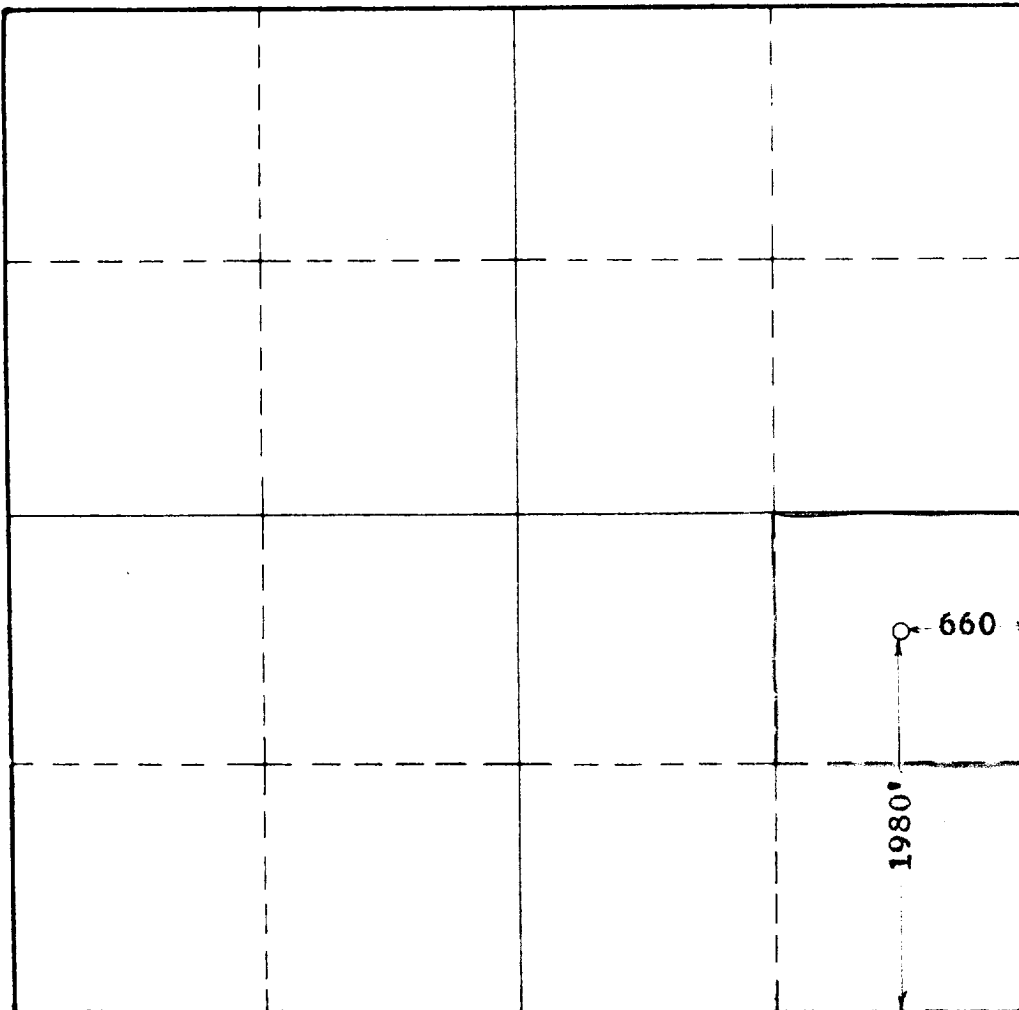

This is to certify that the information in Section A above is true and complete to the best of my knowledge and belief.

Pan American Petroleum Corporation
(Operator)

K. H. Hendrickson
(Representative) Field Supt.

Box 68, Hobbs, New Mexico
Address

This is to certify that the well location shown on the plat in Section B was plotted from field notes of actual surveys made by me or under my supervision and that the same is true and correct to the best of my knowledge and belief.

Date Surveyed 10-17-58

John W. West
Registered Professional
Engineer and/or Land Surveyor.

Certificate No. 676

(See instructions for completing this form on the reverse side)

JOHN W. WEST ENGINEERING COMPANY
412 NORTH DAL PASO
HOBBS, NEW MEXICO

October 22, 1958

Pan American Pet. Corp.
Hobbs, New Mexico

Gentlemen:

On October 17, 1958 a survey was made to locate your No. 1 location on the Malco Refineries "H" lease at a point 1980 feet from the South line and 660 feet from the East line of Section 3, Township 18 South, Range 27 East, N.M.P.M., Eddy County, New Mexico.

A flag was set at the USGLO Quarter corner common to Sections 2 and 3 and the Transit was set up at the USGLO Section corner common to Sections 2, 3, 10 and 11. Thence chaining North 1980 feet from Transit thence West 660 feet to the location site of the Malco Refineries "H" No. 1. As a check we chained South from location site 1980 feet and thence East 660 feet to the USGLO Section corner marker common to Sections 2, 3, 10 and 11. Check-in within the minnum error allowed for this survey.

I hereby certify that the foregoing survey was made in the field under my supervision and that the same is true and correct to the best of my knowledge and belief.

Respectfully submitted,

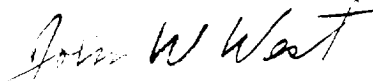

John W. West