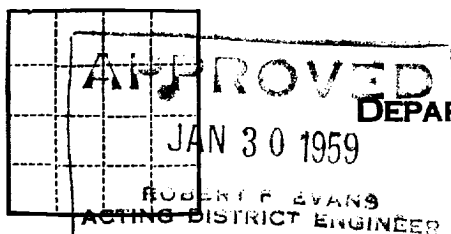

Form 9-551a
(Feb. 1961)

(SUBMIT IN TRIPLICATE)

Land Office Las CrucesLease No. LC 065478 (B)

Unit _____

30-015-00755

UNITED STATES
DEPARTMENT OF THE INTERIOR
GEOLOGICAL SURVEY

SUNDRY NOTICES AND REPORTS ON WELLS

NOTICE OF INTENTION TO DRILL.....	<input checked="" type="checkbox"/>	SUBSEQUENT REPORT OF WATER SHUT-OFF.....	
NOTICE OF INTENTION TO CHANGE PLANS.....		SUBSEQUENT REPORT OF SHOOTING OR ACIDIZING.....	
NOTICE OF INTENTION TO TEST WATER SHUT-OFF.....		SUBSEQUENT REPORT OF ALTERING CASING.....	
NOTICE OF INTENTION TO RE-DRILL OR REPAIR WELL.....		SUBSEQUENT REPORT OF RE-DRILLING OR REPAIR.....	
NOTICE OF INTENTION TO SHOOT OR ACIDIZE.....		SUBSEQUENT REPORT OF ABANDONMENT.....	
NOTICE OF INTENTION TO PULL OR ALTER CASING.....		SUPPLEMENTARY WELL HISTORY.....	
NOTICE OF INTENTION TO ABANDON WELL.....			

(INDICATE ABOVE BY CHECK MARK NATURE OF REPORT, NOTICE, OR OTHER DATA)

MALCO ARTESIA, N.M.January 26, 1959Well No. 2 is located 1980 ft. from N line and 660 ft. from E line of sec. 3SE 1/4, NE 1/4, Section 3
(1/4 Sec. and Sec. No.)T-18-S
(Twp.)R-27-E
(Range)RMPM
(Meridian)Empire Abo
(Field)Hddy
(County or Subdivision)New Mexico
(State or Territory)The elevation of the derrick floor above sea level is furnish later ft.

RECEIVED
JAN 30 1959
U. S. GEOLOGICAL SURVEY
ARTESIA, NEW MEXICO

DETAILS OF WORK

(State names of and expected depths to objective sands; show sizes, weights, and lengths of proposed casings; indicate mudding jobs, cementing points, and all other important proposed work)

We propose to drill the above well with rotary tools to an approximate depth of 6200' to test the Abo. Casing program will be as follows:

Size of Hole	Size of Casing	Depth	Cement
11	8-5/8	950	Circulate 2 1/2 Gal plus 100 sacks neat on bottom
7-7/8	5-1/2	6200	150 sacks neat

I understand that this plan of work must receive approval in writing by the Geological Survey before operations may be commenced.

Company Pan American Petroleum CorporationAddress Post Office Box 68Hobbs, New MexicoBy Reph LemmingsTitle Field Superintendent

NEW MEXICO OIL CONSERVATION COMMISSION
WELL LOCATION AND ACREAGE DEDICATION PLAT

FORM C-128
 Revised 5-1-57

SEE INSTRUCTIONS FOR COMPLETING THIS FORM ON THE REVERSE SIDE

SECTION A

Operator Pan American Pet. Corp.		Lease U.S.A. Malco Refining "H"		Well No. 2
Unit Letter H	Section 3	Township 18 S	Range 27 E	County Eddy
Actual Footage Location of Well. 1980 feet from the North line and 660 feet from the East line				
Ground Level Elev. Purnish Later	Producing Formation Abo	Pool Empire Abo	Dedicated Acreage: 40 Acres	

1. Is the Operator the only owner in the dedicated acreage outlined on the plat below? YES ☒ NO ☐. ("Owner" means the person who has the right to drill into and to produce from any pool and to appropriate the production either for himself or for himself and another. (65-3-29 (e) NMSA 1935 Comp.)
2. If the answer to question one is "no," have the interests of all the owners been consolidated by communitization agreement or otherwise? YES ☐ NO ☐. If answer is "yes," Type of Consolidation _____
3. If the answer to question two is "no," list all the owners and their respective interests below:

Owner	Land Description

RECEIVED
JAN 30 1959
 U. S. GEOL. SURV.
 ARTESIA, NEW MEXICO

SECTION B

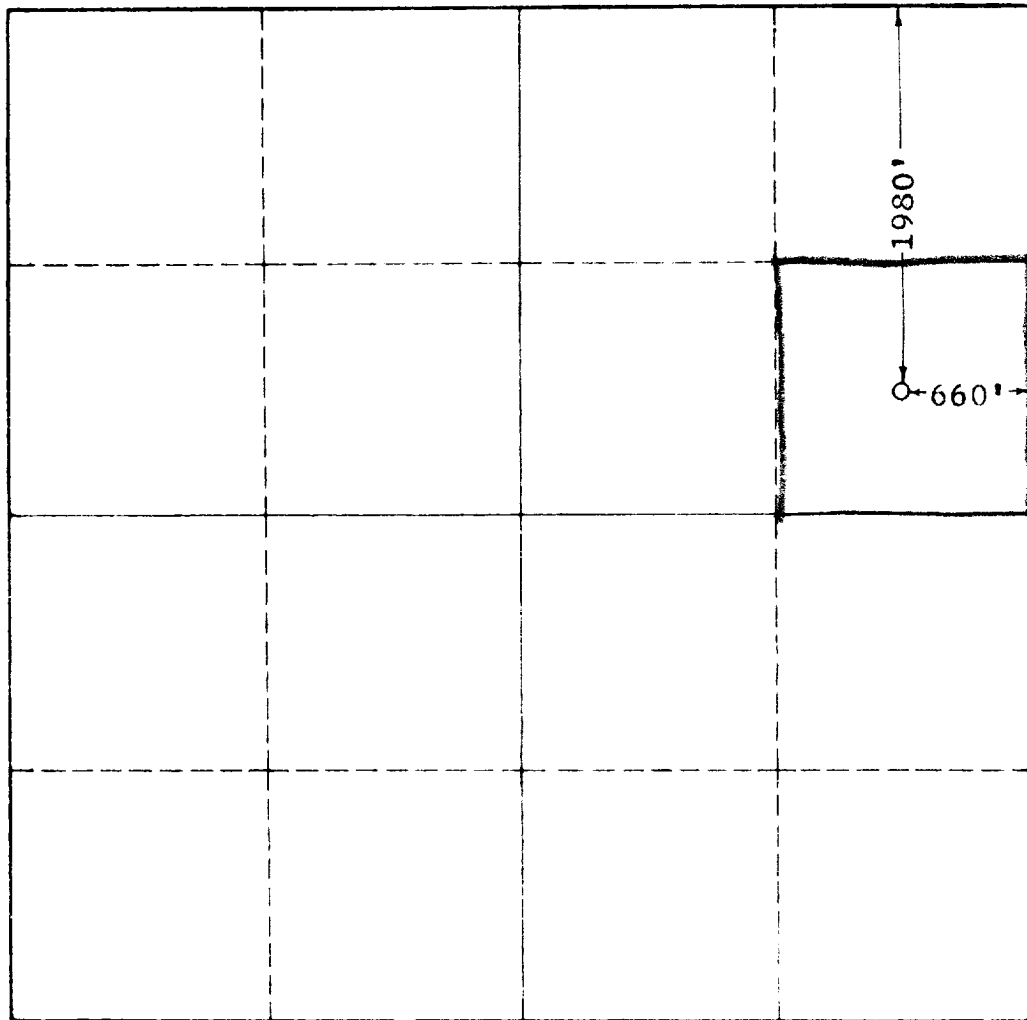

CERTIFICATION

I hereby certify that the information in SECTION A above is true and complete to the best of my knowledge and belief.

Rae H. Henderson
 Name

Field Superintendent

Position

Pan American Petr. Corp.

Company

1/26/59

Date

I hereby certify that the well location shown on the plat in SECTION B was plotted from field notes of actual surveys made by me or under my supervision, and that the same is true and correct to the best of my knowledge and belief.

Date Surveyed

1-23-59

Registered Professional Engineer and/or Land Surveyor, **JOHN W. WEST**

John W. West

Certificate No.

N.M. - P.E. & L.S. NO. 676

0 330 660 990 1320 1650 1980 2310 2640 2000 1500 1000 500 0

JOHN W. WEST ENGINEERING COMPANY

412 NORTH DAL PASO
HOBBS, NEW MEXICO

January 24, 1959

Pan American Pet. Corp.
Hobbs, New Mexico

Gentlemen:

On January 23, 1959 a survey was made to locate your USA Malco Refining No. 2 Well site at a point 1980 feet from the North line and 660 feet from the East line of Section 3, Township 18 South, Range 27 East, N.M.P.M., Eddy County, New Mexico.

A flag was set at the USGLO Quarter corner marker common to Sections 2 and 3. The Transit was set up at the USGLO Section corner marker common to Sections 2, 3, 34 and 35. Thence chaining $S0^{\circ}51'E$ from Transit a distance of 1980 feet and thence $S89^{\circ}53'W$ 660 feet to the location site of the USA Malco Refining Co. "H" No. 2. As a check on our survey we chained East 660 feet and thence South to the USGLO Quarter corner marker common to Sections 2 and 3 checking in within 0.50 feet of the distance (617') as shown on the USGLO township plat.

I hereby certify that the foregoing survey was made in the field under my supervision, and that the same is true and correct to the best of my knowledge and belief.

Respectfully submitted,

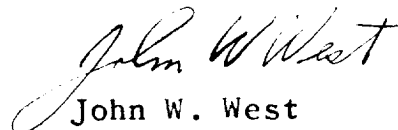
John W. West