

UNITED STATES
DEPARTMENT OF THE INTERIOR
GEOLOGICAL SURVEY

APPLICATION FOR PERMIT TO DRILL, DEEPEN, OR PLUG BACK

1a. TYPE OF WORK

DRILL ☐DEEPEN ☐PLUG BACK ☒

b. TYPE OF WELL

OIL
WELL ☐GAS
WELL ☐OTHER ☒ P & A WellSINGLE
ZONE ☐MULTIPLE
ZONE ☐

2. NAME OF OPERATOR

Hondo Oil & Gas Company

3. ADDRESS OF OPERATOR

P. O. Box 1976, Roswell, New Mexico

4. LOCATION OF WELL (Report location clearly and in accordance with any State requirements*)

At surface

1592' FSL & 2302' FSL

At proposed prod. zone

14. DISTANCE IN MILES AND DIRECTION FROM NEAREST TOWN OR POST OFFICE

ARTESIA, OFFICE

15. DISTANCE FROM PROPOSED*

LOCATION TO NEAREST
PROPERTY OR LEASE LINE, FT.
(Also to nearest drlg. line, if any)

18. DISTANCE FROM PROPOSED LOCATION*

TO NEAREST WELL, DRILLING, COMPLETED,
OR APPLIED FOR, ON THIS LEASE, FT.

16. NO. OF ACRES IN LEASE

116.13

19. PROPOSED DEPTH

17. NO. OF ACRES ASSIGNED
TO THIS WELL

49.62

20. ROTARY OR CABLE TOOLS

21. ELEVATIONS (Show whether DF, RT, GR, etc.)

3597' DF

22. APPROX. DATE WORK WILL START*

3/12/65

23.

PROPOSED CASING AND CEMENTING PROGRAM

SIZE OF HOLE	SIZE OF CASING	WEIGHT PER FOOT	SETTING DEPTH	QUANTITY OF CEMENT

Note: This well formerly known as Pan-American J. E. Simon Federal #2

Casing was set at 5618' & cemented w/850 sx to a point 100 feet from the surface.
We now propose a San Andres completion attempt as follows:

1. Clean out to 2300' and set CIBP at 2300'.
2. Log & perforate San Andres from 2037' to 2159'.
3. Treat w/3000 gallons acid. 40,000 gallons slick water containing 60,000# of 20/40 sand.
4. Test well and put on pump.

IN ABOVE SPACE DESCRIBE PROPOSED PROGRAM: If proposal is to deepen or plug back, give data on present productive zone and proposed new productive zone. If proposal is to drill or deepen directionally, give pertinent data on subsurface locations and measured and true vertical depths. Give blowout preventer program, if any.

24.

SIGNED

A. L. S. T. H. E.

TITLE

District Drilling Supervisor

DATE

3-1-65

(This space for Federal or State office use)

PERMIT NO.

APPROVAL DATE

APPROVED BY

CONDITIONS OF APPROVAL, IF ANY:

TITLE

DATE

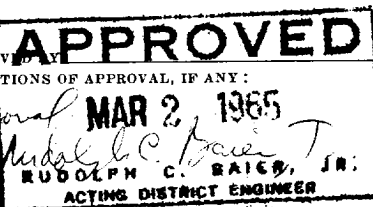

*See Instructions On Reverse Side

Instructions

General: This form is designed for submitting proposals to perform certain well operations, as indicated, on all types of lands and leases for appropriate action by either a Federal or a State agency, or both, pursuant to applicable Federal and/or State laws and regulations. Any necessary special instructions concerning the use of this form and the number of copies to be submitted, particularly with regard to local, area, or regional procedures and practices, either are shown below or will be issued by, or may be obtained from, the local Federal and/or State office.

Item 1: If the proposal is to redrill to the same reservoir at a different subsurface location or to a new reservoir, use this form with appropriate notations. Consult applicable State or Federal regulations concerning subsequent work proposals or reports on the well.

Item 4: If there are no applicable State requirements, locations on Federal or Indian land should be described in accordance with Federal requirements. Consult local State or Federal office for specific instructions.

Item 14: Needed only when location of well cannot readily be found by road from the land or lease description. A plat, or plats, separate or on this reverse side, showing the roads to, and the surveyed location of, the well, and any other required information, should be furnished when required by Federal or State agency offices.

Items 15 and 18: If well is to be, or has been directionally drilled, give distances for subsurface location of hole in any present or objective production zone.

Item 22: Consult applicable Federal or State regulations, or appropriate officials, concerning approval of the proposal before operations are started.

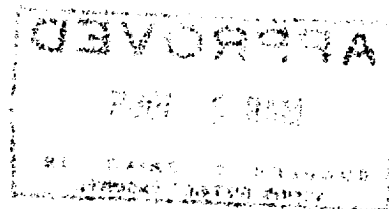

U. S. G. O. COPY
MEXICO OIL CONSERVATION COMMISS. N
WELL LOCATION AND ACREAGE DEDICATION PLAT

Form C-102
Supersedes C-128
Effective 1-1-65

All distances must be from the outer boundaries of the Section.

Operator Hondo Oil & Gas Company			Lease Federal "DC"		Well No. 1
Unit Letter I	Section 4	Township 18-S	Range 27-E	County Idaho	
Actual Footage Location of Well: 1592 feet from the South line and 2302 feet from the West line					
Ground Level Elev:	Producing Formation San Andres ✓		Pool Red Lake ✓		Dedicated Acreage: 38.64 Acres

1. Outline the acreage dedicated to the subject well by colored pencil or hachure marks on the plat below.
2. If more than one lease is dedicated to the well, outline each and identify the ownership thereof (both as to working interest and royalty).
3. If more than one lease of different ownership is dedicated to the well, have the interests of all owners been consolidated by communitization, unitization, force-pooling, etc?

☐ Yes ☐ No If answer is "yes," type of consolidation MAR 8 1965

If answer is "no," list the owners and tract descriptions which have actually been consolidated. (Use reverse side of this form if necessary.) O. C. B. ARTERIAL OFFICE

No allowable will be assigned to the well until all interests have been consolidated (by communitization, unitization, forced-pooling, or otherwise) or until a non-standard unit, eliminating such interests, has been approved by the Commission. **This is a re-entry of Humble Chalk Bluff Draw Unit Well #21**

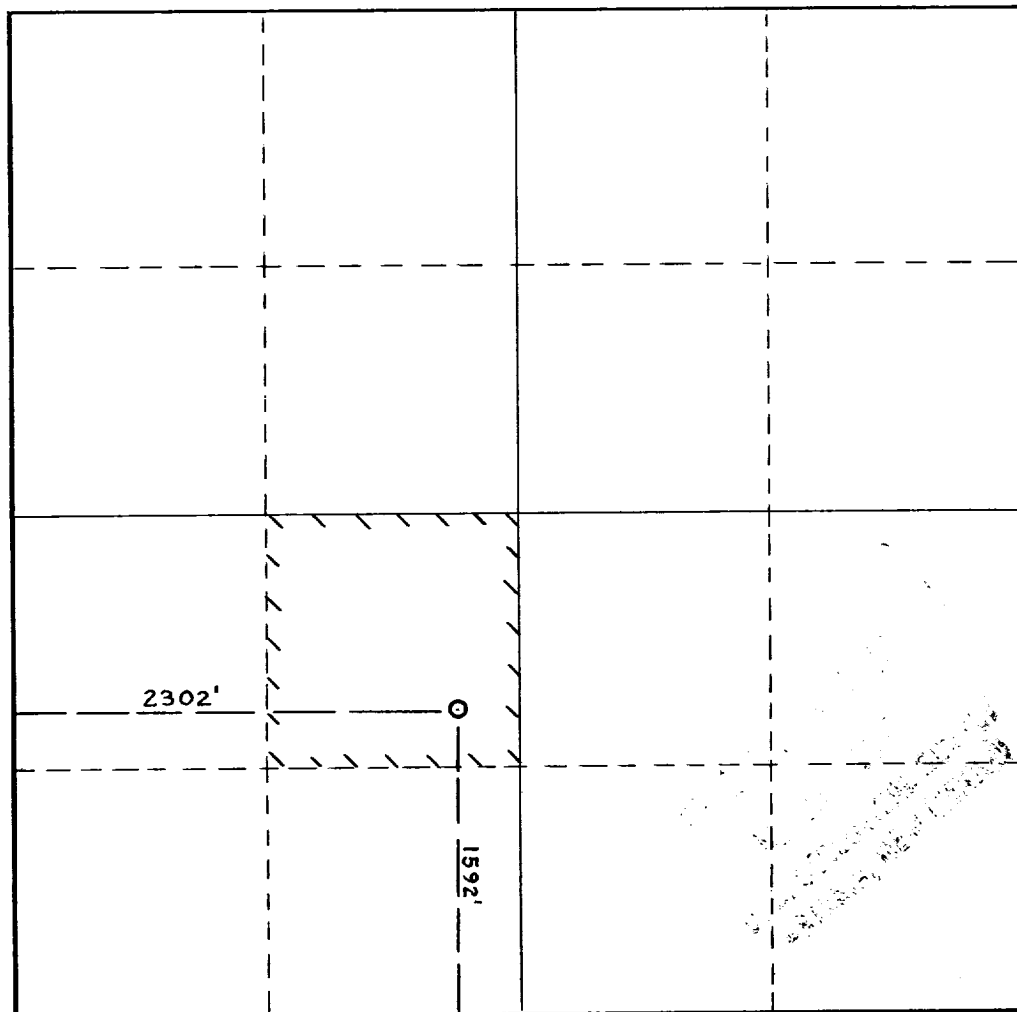

CERTIFICATION

I hereby certify that the information contained herein is true and complete to the best of my knowledge and belief.

C. D. Bretcher

Name
C. D. Bretcher

Position
District Drilling Supervisor

Company
Hondo Oil & Gas Company

Date
3-4-65

I hereby certify that the well location shown on this plat was plotted from field notes of actual surveys made by me or under my supervision, and that the same is true and correct to the best of my knowledge and belief.

Date Surveyed
December 20, 1960

Registered Professional Engineer and/or Land Surveyor
See Original filing for Humble Chalk Bluff Draw Unit Well #21

Certificate No.

0 330 660 990 1320 1650 1980 2310 2640 2000 1500 1000 500 0