

(SUBMIT IN TRIPLICATE)

AUG 10 1961

Field Office

Lease No.

NM C 22825

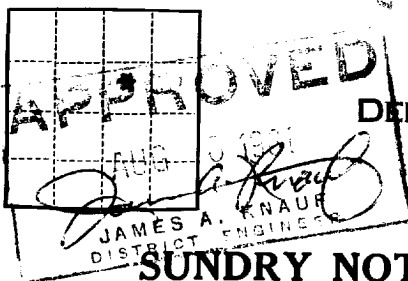
UNITED STATES  
DEPARTMENT OF THE INTERIOR  
GEOLOGICAL SURVEYN. M. O. C. C. CORP  
ARTESIA, NEW MEXICO

30-015-60772

Contact U.S.G.S. Cementing casing

## SUNDRY NOTICES AND REPORTS ON WELLS

NOTICE OF INTENTION TO DRILL	<input checked="" type="checkbox"/>	SUBSEQUENT REPORT OF WATER SHUT-OFF	
NOTICE OF INTENTION TO CHANGE PLANS		SUBSEQUENT REPORT OF SHOOTING OR ACIDIZING	
NOTICE OF INTENTION TO TEST WATER SHUT-OFF		SUBSEQUENT REPORT OF ALTERING CASING	
NOTICE OF INTENTION TO RE-DRILL OR REPAIR WELL		SUBSEQUENT REPORT OF RE-DRILLING OR REPAIR	
NOTICE OF INTENTION TO SHOOT OR ACIDIZE		SUBSEQUENT REPORT OF ABANDONMENT	
NOTICE OF INTENTION TO PULL OR ALTER CASING		SUPPLEMENTARY WELL HISTORY	
NOTICE OF INTENTION TO ABANDON WELL			

(INDICATE ABOVE BY CHECK MARK NATURE OF REPORT, NOTICE, OR OTHER DATA)

U S A MALCOO REFINERIES "N" GAS UNIT June 13, 1961

Well No. 1 is located 2190 ft. from <sup>[N]</sup>~~XX~~ line and 1650 ft. from <sup>[E]</sup>~~XX~~ line of sec. 4SW/4, NE/4, Section 4, T-18-S, R-27-E, NMPM  
(1/4 Sec. and Sec. No.) (Twp.) (Range) (Meridian)  
Red Lake Penn Hobbs Eddy New Mexico  
(Field) (County or Subdivision) (State or Territory)

RECEIVED

AUG 2 1961

The elevation of the derrick floor above sea level is ft. Not Yet Available.

U. S. GEOLOGICAL SURVEY  
ARTESIA, NEW MEXICO

## DETAILS OF WORK

(State names of and expected depths to objective sands; show sizes, weights, and lengths of proposed casings; indicate mudding jobs, cementing points, and all other important proposed work)

It is proposed to drill a 9600' Penn test gas well. Rotary tools will be used from surface to TD. Logs will be run. If indicated to be productive, casing will be run; indicated pays perforated, stimulated and evaluated. Casing program to be as follows:

Hole Size	Casing Size & Wt.	Approx. Depth	Comment
12 1/2-11"	9-5/8" 32.34-36#	1500	Circulated
7-7/8"	4-1/2" 9.54-11.6#	9600	600' above Abo if productive

APPROVAL IS SUBJECT TO STATE  
ENGINEERS AND IS NOT REQUIRED  
ON "APPLIED" CASING LIMIT TO  
DRILL FOR SURFACE WATER BASIN.

I understand that this plan of work must receive approval in writing by the Geological Survey before operations may be commenced.

Company Pan American Petroleum Corporation

Address Box 68

Hobbs, New Mexico

Original Signed by:  
By V. E. STALEY

Title Area Superintendent

NEW MEXICO OIL CONSERVATION COMMISSION  
WELL LOCATION AND ACREAGE DEDICATION PLAT

FORM C-128  
Revised 5/1/57

RECEIVED

AUG 10 1961

SEE INSTRUCTIONS FOR COMPLETING THIS FORM ON THE REVERSE SIDE

SECTION A

ARTESIA, OFFICE

Operator <b>Pan American Pet. Corp.</b>	Lease <b>Gas Unit</b>	Well No. <b>1</b>
Unit Letter <b>G</b>	Section <b>4</b>	Township <b>18 South</b>
Range <b>27 East</b>	County <b>Eddy</b>	
Actual Footage Location of Well: <b>2190</b> feet from the <b>North</b> line and <b>1650</b> feet from the <b>East</b> line		
Ground Level Elev. Not Yet Avail.	Producing Formation <b>Penn</b>	Pool <b>Red Lake Penn</b>
Dedicated Acreage: <b>320</b> Acres		

1. Is the Operator the only owner in the dedicated acreage outlined on the plat below? YES ☒ NO ☐ ("Owner" means the person who has the right to drill into and to produce from any pool and to appropriate the production either for himself or for himself and another. (65-3-29 (e) NMSA 1935 Comp.)
2. If the answer to question one is "no," have the interests of all the owners been consolidated by communitization agreement or otherwise? YES ☐ NO ☐ If answer is "yes," Type of Consolidation \_\_\_\_\_
3. If the answer to question two is "no," list all the owners and their respective interests below:

RECEIVED

Owner	Land Description
	<b>AUG 2 1961</b>
	<b>U. S. GEOLOGICAL SURVEY</b>
	<b>ARTESIA, NEW MEXICO</b>

SECTION B

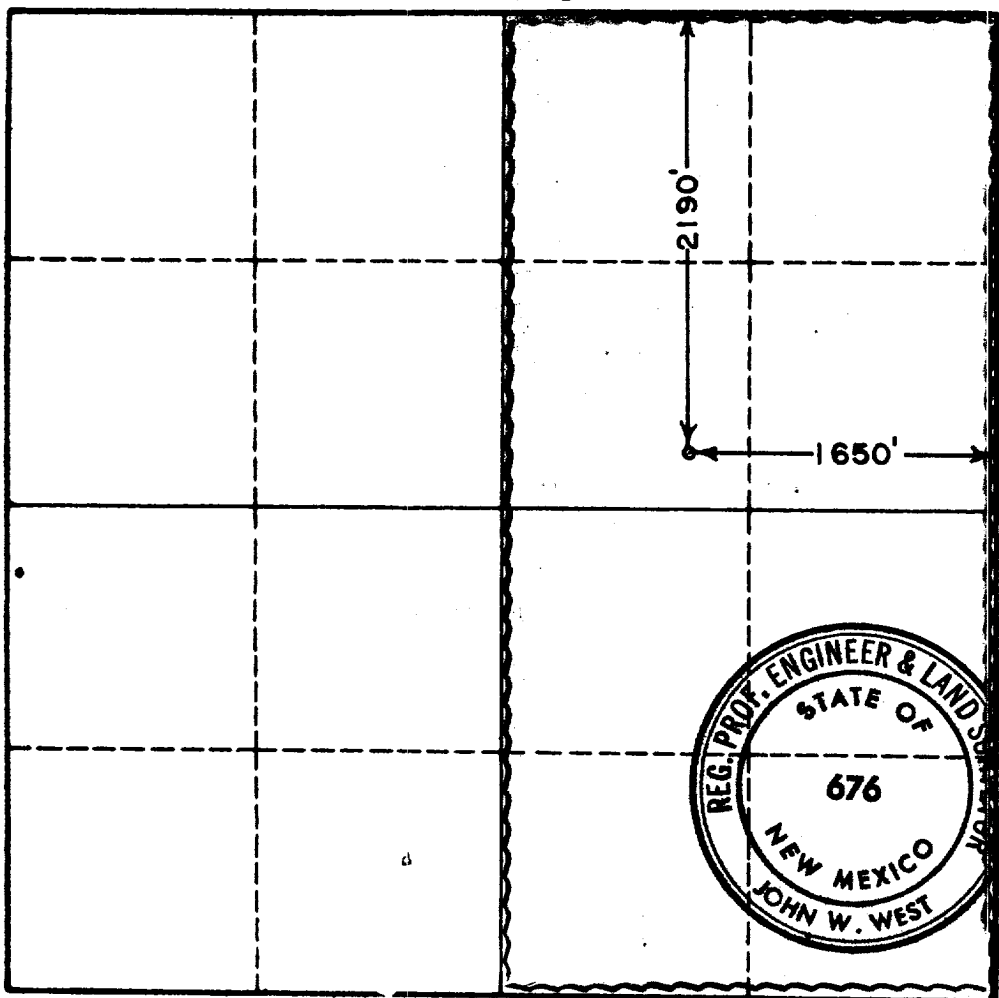

CERTIFICATION

I hereby certify that the information in SECTION A above is true and complete to the best of my knowledge and belief.

Name Original Signed by: <b>V. E. STALEY</b>
Position <b>Area Superintendent</b>
Company <b>Pan American Petroleum Corp.</b>
Date <b>June 14, 1961</b>

I hereby certify that the well location shown on the plat in SECTION B was plotted from field notes of actual surveys made by me or under my supervision, and that the same is true and correct to the best of my knowledge and belief.

Date Surveyed <b>6-8-61</b>
Registered Professional Engineer and/or Land Surveyor, <b>JOHN W. WEST</b>
Certificate No. <b>John W. West</b>
<b>N. M. - P. E. &amp; L. S. NO. 676</b>

0 330 660 990 1320 1650 1980 2310 2640 2000 1500 1000 500

RECEIVED EX. 3-6770

JOHN W. WEST ENGINEERING COMPANY

412 NORTH DAL PASO

HOBBS, NEW MEXICO

AUG 10 1961

O. C. C.  
ARTESIA, OFFICE

June 12, 1961

Pan American Petroleum Corp.  
Box 68  
Hobbs, New Mexico

Gentlemen:

June 8, 1961, a survey was made to stake the location for your USA Malco Refineries "M" No. 1 at a point 2190 feet from the North and 1650 feet from the East lines of Sec. 4, Twp. 18 South, Range 27 East, N.M.P.M., Eddy County, New Mexico.

A flag was set at the corner marker common to sections 33, 34, 3 and 4, and the transit was set up over the quarter corner marker common to sections 3 and 4 and the survey was started from that point; thence  $N0^{\circ}38'W$  along the section line 330.0 feet, thence  $N89^{\circ}32'W$  1650.0 feet to the location. To check we then chained  $S89^{\circ}32'E$  1650.0 feet and  $S00^{\circ}38'E$  330.0 feet, missing the quarter corner marker 0.4 feet, which is within the allowable limits of this survey.

I hereby certify that the foregoing survey was made in the field under my supervision and that the same is true and correct to the best of my knowledge and belief.

Respectfully submitted,

  
John W. West