

(SUBMIT IN TRIPLICATE)

UNITED STATES
DEPARTMENT OF THE INTERIOR
GEOLOGICAL SURVEY

Land Office **Las Cruces**
Lease No. **LC 069274**
Unit _____

30-015-00289

SUNDRY NOTICES AND REPORTS ON WELLS

NOTICE OF INTENTION TO DRILL	<input checked="" type="checkbox"/>	SUBSEQUENT REPORT OF WATER SHUT-OFF	
NOTICE OF INTENTION TO CHANGE PLANS		SUBSEQUENT REPORT OF SHOOTING OR ACIDIZING	
NOTICE OF INTENTION TO TEST WATER SHUT-OFF		SUBSEQUENT REPORT OF ALTERING CASING	
NOTICE OF INTENTION TO RE-DRILL OR REPAIR WELL		SUBSEQUENT REPORT OF RE-DRILLING OR REPAIR	
NOTICE OF INTENTION TO SHOOT OR ACIDIZE		SUBSEQUENT REPORT OF ABANDONMENT	
NOTICE OF INTENTION TO PULL OR ALTER CASING		SUPPLEMENTARY WELL HISTORY	
NOTICE OF INTENTION TO ABANDON WELL			

(INDICATE ABOVE BY CHECK MARK NATURE OF REPORT, NOTICE, OR OTHER DATA)

Fred-Federal **January 19** 19**57**
Well No. **1** is located **330** ft. from **[S]** line and **330** ft. from **[E]** line of **Lot 6**
NW/4 of SW/4 Section 6 **128** **27E** **NMPM**
(1/4 Sec. and Sec. No.) (Twp.) (Range) (Meridian)
Artesia **Eddy** **New Mexico**
(Field) (County or Subdivision) (State or Territory)

The elevation of the derrick floor above sea level is **xx Ground El. 3390**

DETAILS OF WORK

(State names of and expected depths to objective sands; show sizes, weights, and lengths of proposed casings; indicate mudding jobs, cementing points, and all other important proposed work)

Queen Sand	500	4-5/8" casing to 1800' and cemented to surface in 10-3/4" hole
Grayburg	860	
San Andres	1100	
Slaughter zone	1730	
TD Approx.	2200	5-1/2" casing to productive formation cemented from bottom to 900' in 7-7/8" hole
		Will frac if necessary on completion.

I understand that this plan of work must receive approval in writing by the Geological Survey before operations may be commenced.

Company **The Box Company**

Address **Box 752**

Brackenridge, Texas

By **LA Ford**

Title **Assistant Prod. Supt.**



John A. Mathis, Jr.
SOUTHEAST ENGINEERING CO.
GENERAL SURVEYING

ARTESIA, NEW MEXICO

807 BULLOCK AVENUE
DIAL SHERWOOD 6-4116

- PHOTOSTATS
- OZALID PRINTS

COMPANY The Ibox Company

LEASE Fred-Federal WELL NO. 1

SEC. 6 T. 18S S., R. 27E E., N. M. P. M.

LOCATION SE¹ Lot 6(1650' from South & 1001' from West Lines)

COUNTY Eddy NEW MEXICO

Ground Elevation 3390'

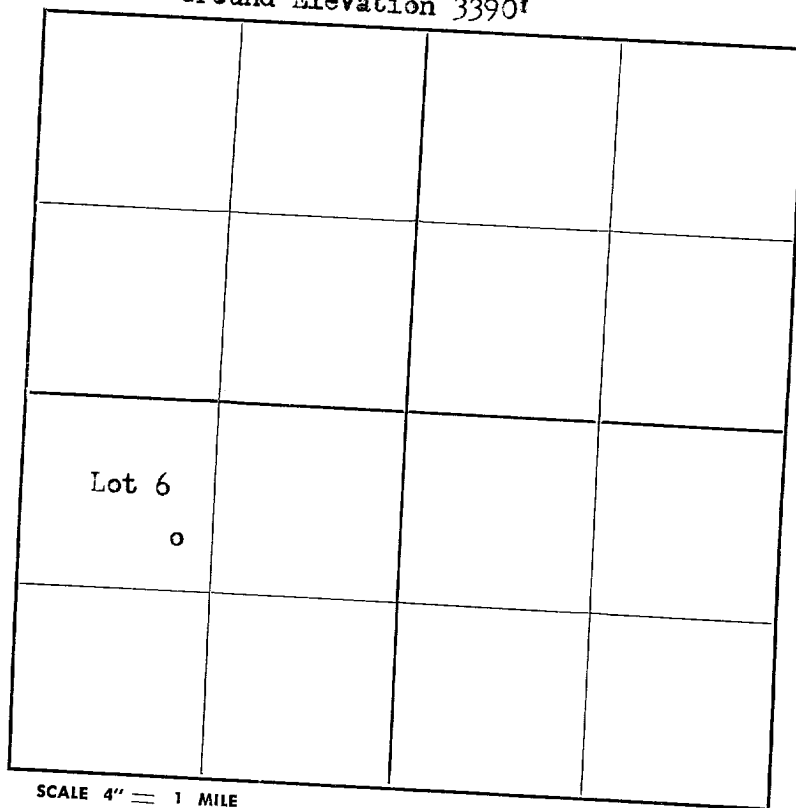

THIS IS TO CERTIFY THAT THE ABOVE PLAT WAS PREPARED FROM FIELD NOTES
OF ACTUAL SURVEYS MADE BY ME OR UNDER MY SUPERVISION AND THAT THE
SAME ARE TRUE AND CORRECT TO THE BEST OF MY KNOWLEDGE AND BELIEF.

SEAL:
ARTESIA, NEW MEXICO

John A. Mathis, Jr.
REGISTERED LAND SURVEYOR.

SURVEYED December 19, 1956

ARTESIA PRINTING CO.