

NEW MEXICO OIL CONSERVATION COMMISSION
Santa Fe, New Mexico

Form C-101
Revised (12/1/55)

JUN 25 1957

NOTICE OF INTENTION TO DRILL

Notice must be given to the District Office of the Oil Conservation Commission and approval obtained before drilling or recompletion begins. If changes in the proposed plan are considered advisable, a copy of this notice showing such changes will be returned to the sender. Submit this notice in **QUINTUPLICATE**. One copy will be returned following approval. See additional instructions in Rules and Regulations of the Commission. If State Land submit 6 Copies Attach Form C-128 in triplicate to first 3 copies of form C-101

June 25, 1957
(Date)

Roswell, New Mexico
(Place)

OIL CONSERVATION COMMISSION
SANTA FE, NEW MEXICO

CONNECTION OF LOCATION

Gentlemen:

You are hereby notified that it is our intention to commence the Drilling of a well to be known as

Malco Refineries, Inc.
(Company or Operator)

William Stirling, Jr.
(Lessee)

Well No. 4, in F (Unit) The well is

located 2310 feet from the North line and 1650 feet from the West line of Section 7, T. 18S, R. 27E, NMPM. County

(GIVE LOCATION FROM SECTION LINE) Red Lake Indian Pool, Edy County

If State Land the Oil and Gas Lease is No.

If patented land the owner is William Stirling, Jr.

Address Box 76, Waterflow, New Mexico

We propose to drill well with drilling equipment as follows: Rotary

The status of plugging bond is Blanket

Drilling Contractor Bonnally Drilling Company

We intend to complete this well in the Atoka (Slaughter) zone, San Andres formation at an approximate depth of 2,000 feet.

CASING PROGRAM

We propose to use the following strings of Casing and to cement them as indicated:

Size of Hole	Size of Casing	Weight per Foot	New or Second Hand	Depth	Sacks Cement
11"	8-5/8"	24 1/2	New	1,000	260
7-7/8"	5 1/2"	14 1/2	New	1,900	150

If changes in the above plans become advisable we will notify you immediately.

ADDITIONAL INFORMATION (If recompletion give full details of proposed plan of work.)

Location corrected from C SE NW Sec. 7-18S-27E to C SW SE NW Sec. 7-18S-27E. Had to move to get out of bog land.

JUN 25 1957

Approved _____, 19____
Except as follows:

OIL CONSERVATION COMMISSION

By M L Armstrong

Sincerely yours,

Malco Refineries, Inc.
(Company or Operator)

By J. R. McMillin

Position Drig. and Prod. Sup't.
Send Communications regarding well to

Name Malco Refineries, Inc.

Address Box 660, Roswell, New Mexico

OIL CONSERVATION COMMISSION		
ARTESIA DISTRICT OFFICE		
No. _____		
RESOLUTION		
Proration Office		
State Land Office		
U. S. G. S.		
Transporter		
File		

N.L.M. MEXICO OIL CONSERVATION COMMISSION
Well Location and Acreage Dedication Plat

Form C-128

Revised 5/1/57

RECEIVED

Section A.

Date June 24, 1957

Operator Malco Refineries, Inc. Lease William Stirling Oil Cons. Comm.
Well No. 4 Unit Letter P Section 7 Township 18N ARTESIA OFFICE NMPPM
Located 2310 Feet From North Line, 1650 Feet From West Line
County Bddy G. L. Elevation _____ Dedicated Acreage 40 Acres
Name of Producing Formation San Andres Pool Red Lake Underway

1. Is the Operator the only owner* in the dedicated acreage outlined on the plat below?
Yes ☒ No ☐
2. If the answer to question one is "no," have the interests of all the owners been consolidated by communitization agreement or otherwise? Yes ☐ No ☐. If answer is "yes," Type of Consolidation _____
3. If the answer to question two is "no," list all the owners and their respective interests below:

Owner

Land Description

Section B

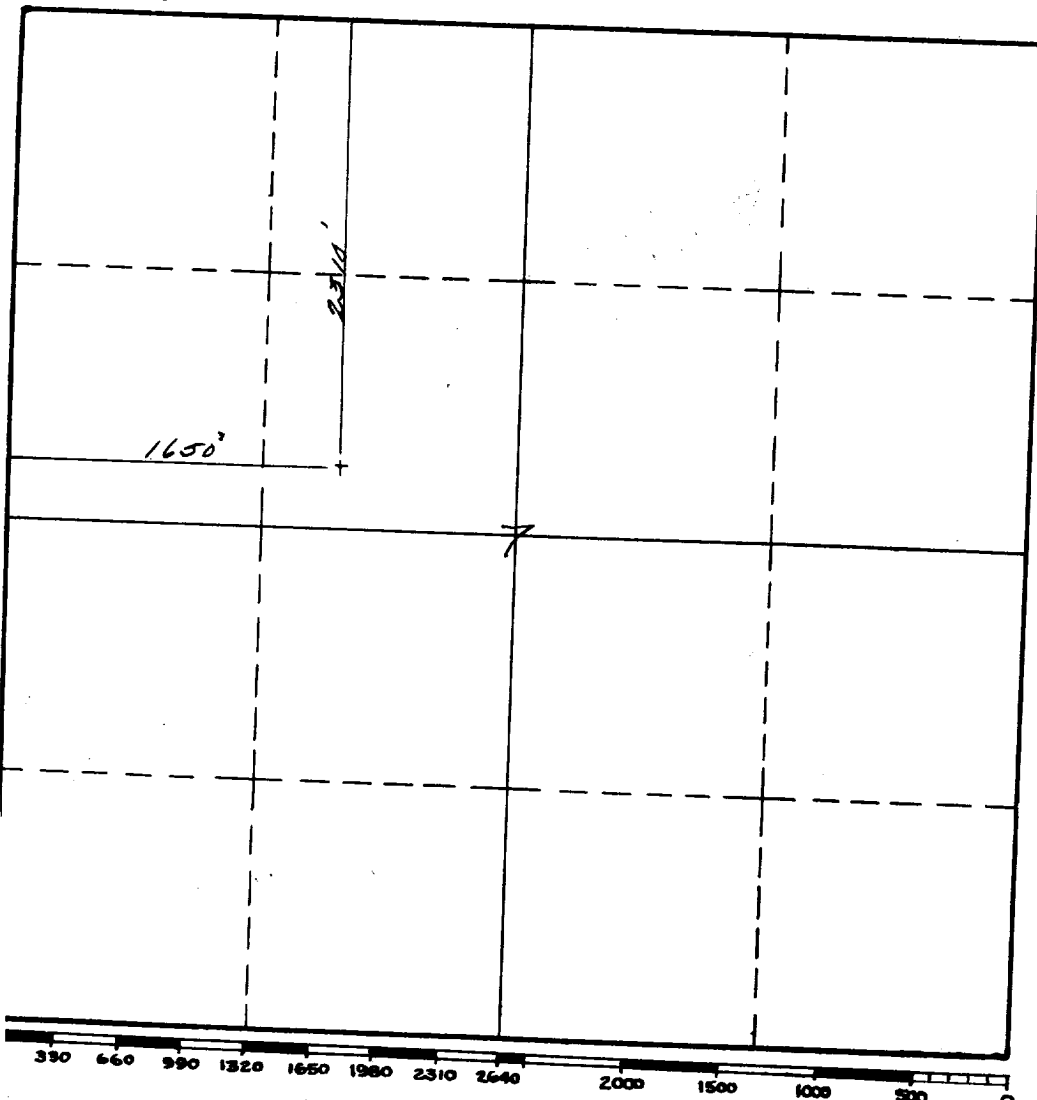

This is to certify that the information in Section A above is true and complete to the best of my knowledge and belief.

Malco Refineries, Inc.
(Operator)
[Signature]
(Representative)

P.O. Box 660, Roswell, New Mex.
Address

This is to certify that the well location shown on the plat in Section B was plotted from field notes of actual surveys made by me or under my supervision and that the same is true and correct to the best of my knowledge and belief.

Date Surveyed June 24, 1957

[Signature]
Registered Professional
Engineer and/or Land Surveyor.

(See instructions for completing this form on the reverse side) Certificate No. 963

INSTRUCTIONS FOR COMPLET :

1. Operator shall furnish and certify to the information called for in Section A.
2. Operator shall outline the dedicated acreage for both oil and gas wells on the plat in Section B.
3. A registered professional engineer or land surveyor registered in the State of New Mexico or approved by the Commission shall show on the plat the location of the well and certify this information in the space provided.
4. All distances shown on the plat must be from the outer boundaries of Section.
5. If additional space is needed for listing owners and their respective interests as required in question 3, Section A, please use space below

OIL CONSERVATION COMMISSION		
ARTESIA DISTRICT OFFICE		
No Copies Received		
DISTRIBUTION		
	NO. FURNISHED	
Operator		
County Engr.		
Proration Office		
State Land Office		
U. S. G. S.		
Transporter		
File		

* "Owner" means the person who has the right to drill into and to produce from any pool and to appropriate the production either for himself or for himself and another. (65-3-29 (e) NMSA 1953 Comp.)