

NEW MEXICO OIL CONSERVATION COMMISSION
Santa Fe, New Mexico

Form O-101
Revised (12/1/55)
RECEIVED

JUL 26 1957

NOTICE OF INTENTION TO DRILL

Notice must be given to the District Office of the Oil Conservation Commission and approval obtained before drilling or recompletion begins. If changes in the proposed plan are considered advisable, a copy of this notice showing such changes will be returned to the sender. Submit this notice in **QUINTUPLICATE**. One copy will be returned following approval. See additional instructions at District Office and Regulations of the Commission. If State Land submit 6 Copies Attach Form G-128 in triplicate to first 3 copies of form G-101

Artesia, New Mexico
(Place)

July 26, 1957
(Date)

OIL CONSERVATION COMMISSION
SANTA FE, NEW MEXICO

Gentlemen:

You are hereby notified that it is our intention to commence the **Drilling** of a well to be known as
Weier Drilling Company

(Company or Operator)

Gilbert

(Lease)

Well No. 2, in K The well is
(Unit)

located 1710 feet from the West line and 2280 feet from the

South line of Section 7, T 18S, R 27E, NMPM.

(GIVE LOCATION FROM SECTION LINE) Red Lake Pool, Eddy County

If State Land the Oil and Gas Lease is No. Feeland

If patented land the owner is Gilbert

Address

We propose to drill well with drilling equipment as follows: Rotary Rig

The status of plugging bond is \$10,000.00 Blanket bond

Drilling Contractor DONNELLY DRILLING COMPANY, Inc.

We intend to complete this well in the Slaughter formation at an approximate depth of 1775 feet.

CASING PROGRAM

We propose to use the following strings of Casing and to cement them as indicated:

Size of Hole	Size of Casing	Weight per Foot	New or Second Hand	Depth	Sacks Cement
8 3/4	7"	20#	New J-55	880	Circulate cement
6 1/4	4 1/2"	9.50#	New J-55	1750	50

If changes in the above plans become advisable we will notify you immediately.

ADDITIONAL INFORMATION (If recompletion give full details of proposed plan of work.)

JUL 26 1957

Approved _____, 19_____
Except as follows:

OIL CONSERVATION COMMISSION

By M. L. Armstrong

Sincerely yours,

Weier Drilling Company
(Company or Operator)

By [Signature]
DONNELLY DRILLING COMPANY, Inc.

Position President

Send Communications regarding well to

Name DONNELLY DRILLING COMPANY, Inc.

Address Box 433, Artesia, New Mexico

OIL CONSERVATION COMMISSION

ARTESIA DISTRICT OFFICE

No. Copies Received

DISTRIBUTION

	FURNISHED	
Operator		
Santa Fe		
Proration Office		
State Land Office		
U. S. G. S.		
Transportation		
File		

NEW MEXICO OIL CONSERVATION COMMISSION

Well Location and Acreage Dedication Plat

Section A.

Date July 26, 1957

RECEIVED

Operator Weier Drilling Company Lease Gilbert JUL 26 1957
Well No. 2 Unit Letter K Section 7 Township 18S Range 27E NMPM
Located 1710 Feet From West Line, 2280 Feet From South Line
County Eddy G. L. Elevation 3289 Dedicated Acreage Oil Cons. Comm. Acres
Name of Producing Formation Slaughter Pool Red Lake ARTESIA OFFICE

1. Is the Operator the only owner* in the dedicated acreage outlined on the plat below?
Yes _____ No _____.
2. If the answer to question one is "no," have the interests of all the owners been consolidated by communitization agreement or otherwise? Yes _____ No _____. If answer is "yes," Type of Consolidation _____
3. If the answer to question two is "no," list all the owners and their respective interests below:

Owner

Land Description

Section B

R27E

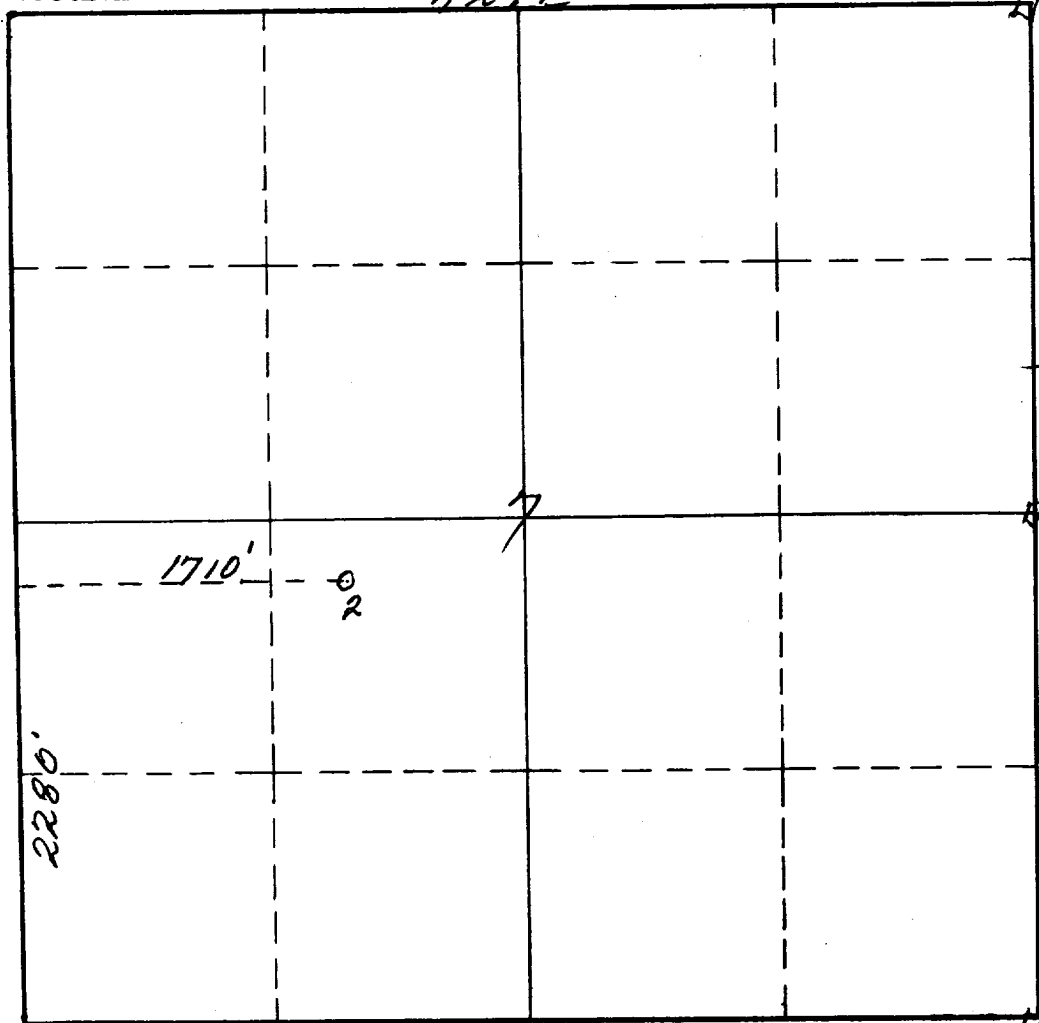

This is to certify that the information in Section A above is true and complete to the best of my knowledge and belief.

Weier Drilling Company
(Operator)

Donnelly Drilling Co., Inc.
Box 433, Artesia, N.M.
Address

This is to certify that the well location shown on the plat in Section B was plotted from field notes of actual surveys made by me or under my supervision and that the same is true and correct to the best of my knowledge and belief.

Date Surveyed July 25th 1957

James H. Brown
Registered Professional
Engineer and/or Land Surveyor.

Certificate No. 542

(See instructions for completing this form on the reverse side)

INSTRUCTIONS FOR COMPLETION:

1. Operator shall furnish and certify to the information called for in Section A.
2. Operator shall outline the dedicated acreage for both oil and gas wells on the plat in Section B.
3. A registered professional engineer or land surveyor registered in the State of New Mexico or approved by the Commission shall show on the plat the location of the well and certify this information in the space provided.
4. All distances shown on the plat must be from the outer boundaries of Section.
5. If additional space is needed for listing owners and their respective interests as required in question 3, Section A, please use space below

OIL CONSERVATION COMMISSION		
ARTESIA DISTRICT OFFICE		
No. Copies Received <u>3</u>		
DISTRIBUTION		
	No. FURNISHED	
Secretary	<u>1</u>	
Gen'l. Inv.	<u>1</u>	
Engineering Office		
State Land Office		
U. S. Dept.		
Transporter		
File		

* "Owner" means the person who has the right to drill into and to produce from any pool and to appropriate the production either for himself or for himself and another. (65-3-29 (e) NMSA 1953 Comp.)