

SEP 19 1960

APPROVED: *[Signature]*
JAMES A. KNAUF, DISTRICT ENGINEER.
SUBJECT TO LIKE APPROVAL BY STATE ENGINEER.
NEEDS OF BOX 1600, RYAN, NEW MEXICO

(SUBMIT IN TRIPLICATE)

UNITED STATES

DEPARTMENT OF THE INTERIOR

GEOLOGICAL SURVEY

Land Office

SEP 26 1960 070678 (a)

Unit P

ARTESIA, OFFICE

30-015-00824

SUNDRY NOTICES AND REPORTS ON WELLS

NOTICE OF INTENTION TO DRILL	X	SUBSEQUENT REPORT OF WATER SHUT-OFF
NOTICE OF INTENTION TO CHANGE PLANS		SUBSEQUENT REPORT OF SHOOTING OR ACIDIZING
NOTICE OF INTENTION TO TEST WATER SHUT-OFF		SUBSEQUENT REPORT OF ALTERING CASING
NOTICE OF INTENTION TO RE-DRILL OR REPAIR WELL		SUBSEQUENT REPORT OF RE-DRILLING OR REPAIR
NOTICE OF INTENTION TO SHOOT OR ACIDIZE		SUBSEQUENT REPORT OF ABANDONMENT
NOTICE OF INTENTION TO PULL OR ALTER CASING		SUPPLEMENTARY WELL HISTORY
NOTICE OF INTENTION TO ABANDON WELL		

(INDICATE ABOVE BY CHECK MARK NATURE OF REPORT, NOTICE, OR OTHER DATA)

Abo-Chalk Bluff Draw Unit September 15, 1960

Well No. 17 is located 660 ft. from ~~SW~~ line and 330 ft. from ~~SW~~ line of sec. 8SE/4 of SE/4 8
(1/4 Sec. and Sec. No.)18-S
(Twp.)27-E
(Range)

(Meridian)

Empire-Abo
(Field)Eddy
(County or Subdivision)New Mexico
(State or Territory)

The elevation of the derrick floor above sea level is later. ft.

DETAILS OF WORK

(State names of and expected depths to objective sands; show sizes, weights, and lengths of proposed casings; indicate mudding jobs, cementing points, and all other important proposed work)

CASING PROGRAM		DEPTH	CEMENTING PROGRAM	CORING PROGRAM
Size	Wt.			
8-5/8	24#	1500	Circulate to surface	None
4-1/2	9.50	6100	Circ to 8-5/8" csg.	

Halliburton method of cementing to be used.

Minimum mud for samples.

Proposed total depth 6100' to test the Abo Formation.

Surf. csg. to be set & cmt'd in accordance with State Engineering Memo No. 63 covering the Artesia Water Basin.

I understand that this plan of work must receive approval in writing by the Geological Survey before operations may be commenced.

Company Humble Oil & Refining Co.

Address Box 1600
Midland, Texas

By

[Signature]

Title Area Adm.

STATE LEASE NO. _____
FEDERAL LEASE NO. 070678
Hondo Lease

RECEIVED

NEW MEXICO OIL CONSERVATION COMMISSION

Form C-128
Revised 5/1/57

Well Location and Acreage Dedication D. C. C.
ARTESIA, OFFICE

Section A.

Date Sept 14, 1960

Operator Humble Oil & Refining Co Lease Abo-chalk Bluff Draw Unit
Well No. 17 Unit Letter "P" Section 8 Township 18 South Range 27 East NMPM
Located 660 Feet From South Line, 330 Feet From East Line
County Eddy G. L. Elevation Later Dedicated Acreage 40 Acres
Name of Producing Formation Abo Pool Empire - Abo

1. Is the Operator the only owner* in the dedicated acreage outlined on the plat below?
Yes _____ No ✓
2. If the answer to question one is "no", have the interests of all the owners been consolidated by communitization agreement or otherwise? Yes ✓ No _____ If answer is "yes," Type of Consolidation Unitization
3. If the answer to question two is "no," list all the owners and thier respective interests below:

Owner

Land Description

Section B

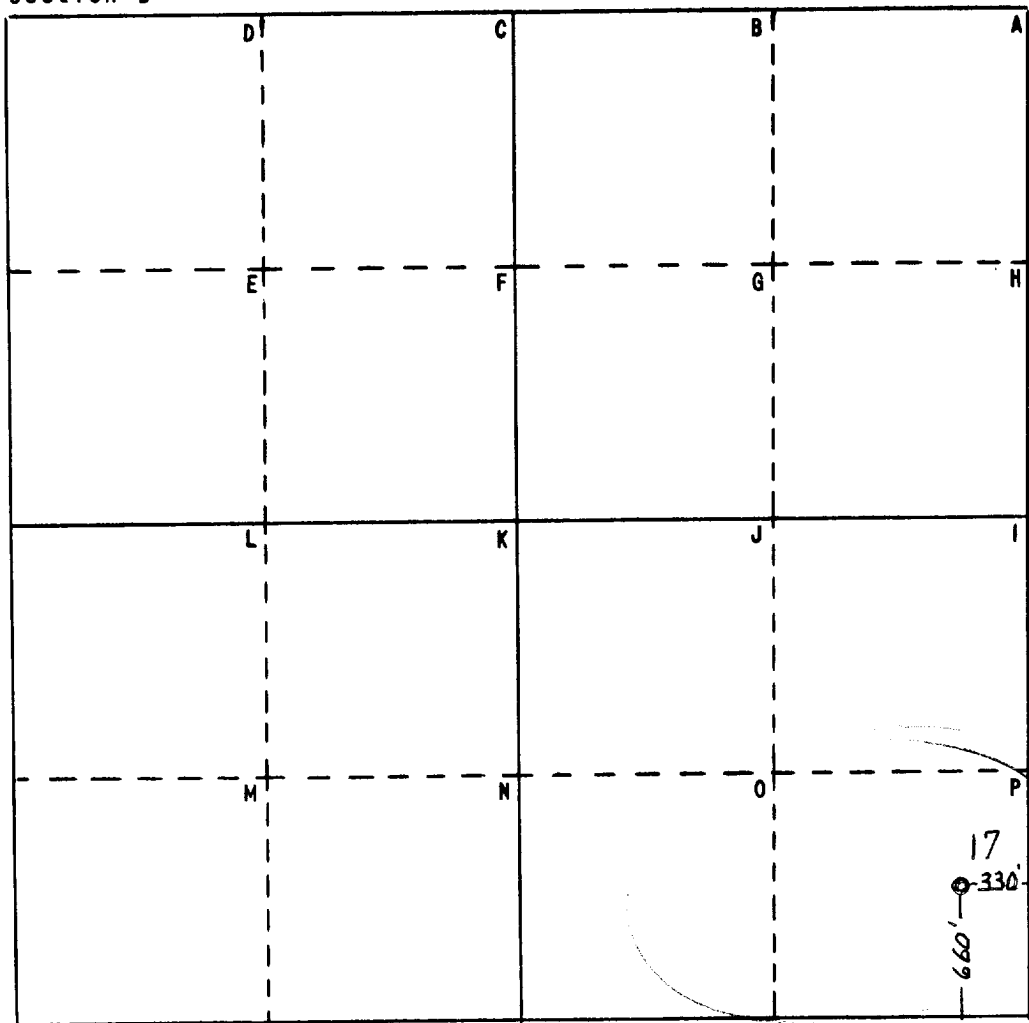

This is to certify that the information in Section A above is true and complete to the best of my knowledge and belief

HUMBLE OIL & REFG. CO.
(Operator)

H. R. Hensley
(Representative)

Box 1600 Midland, Texas
Address

This is to certify that the well location shown on the plat in Section B was plotted from field notes of actual surveys made by me or under my supervision and that the same is true and correct to the best of my knowledge and belief.

Date Surveyed Sept. 13, 1960
H. S. Hesterfeld
Registered Professional
Engineer and/or Land Surveyor

Certificate No. 1382