

(SUBMIT IN TRIPLICATE)

UNITED STATES  
DEPARTMENT OF THE INTERIOR  
GEOLOGICAL SURVEY

Land Office **New Mexico**  
Lease No. **N.M. 031186**  
Unit **C**

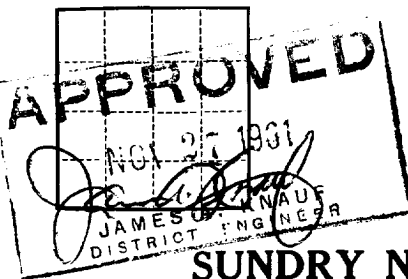

RECEIVED

SUNDRY NOTICES AND REPORTS ON WELLS

NOV 30 1961

NOTICE OF INTENTION TO DRILL	<input checked="" type="checkbox"/>	SUBSEQUENT REPORT OF WATER SHUT-OFF	
NOTICE OF INTENTION TO CHANGE PLANS		SUBSEQUENT REPORT OF SHOOTING OR ACIDIZING	
NOTICE OF INTENTION TO TEST WATER SHUT-OFF		SUBSEQUENT REPORT OF ALTERING CASING	
NOTICE OF INTENTION TO RE-DRILL OR REPAIR WELL		SUBSEQUENT REPORT OF RE-DRILLING OR REPAIR	
NOTICE OF INTENTION TO SHOOT OR ACIDIZE		SUBSEQUENT REPORT OF ABANDONMENT	
NOTICE OF INTENTION TO PULL OR ALTER CASING		SUPPLEMENTARY WELL HISTORY	
NOTICE OF INTENTION TO ABANDON WELL			

(INDICATE ABOVE BY CHECK MARK NATURE OF REPORT, NOTICE, OR OTHER DATA)

November 18, 1961

Well No. **Mann #2** is located **660** ft. from **N** line and **1980** ft. from **W** line of sec. **9**

**NE 1/4 Sec. 9**

**183-27E**

**N.M.P.M.**

(1/4 Sec. and Sec. No.)

(Twp.)

(Range)

(Meridian)

**RED LAKE**

**EDDY**

**NEW MEXICO**

(Field)

(County or Subdivision)

(State or Territory)

RECEIVED

NOV 24 1961

The elevation of the derrick floor above sea level is \_\_\_\_\_ ft.

DETAILS OF WORK

(State names of and expected depths to objective sands; show sizes, weights, and lengths of proposed casings; indicate mudding jobs, cementing points, and all other important proposed work)

We plan to drill to approximately 2300 feet to test the San Andreas Formation. Our program is as follows:

Set one joint of 13-3/8" casing and circulate to surface-  
drill a 7-7/8 rotary hole, setting 9.5 4-1/2" seamless/casing,  
cementing to surface. We will advise Mr. Jim Knauf with the U.S.G.S.  
before cementing. Work to be done by the Donnelly Drilling Company,  
Artesia, New Mexico.

I understand that this plan of work must receive approval in writing by the Geological Survey before operations may be commenced.

Company **MILDRED CRANE HUDSON**

Address **DRAWER T**  
**ARTESIA, NEW MEXICO**

RECEIVED

NOV 22 1961

By *Mildred Crane Hudson*

Title **OPERATOR**

NUMBER OF COPIES RECEIVED	
DISTRIBUTION	
SANTA FE	
FILE	
U.S.G.S.	
LAND OFFICE	
TRANSPORTER	OIL
	GAS
PRODUCTION OFFICE	
OPERATOR	

**NEW MEXICO OIL CONSERVATION COMMISSION**  
**WELL LOCATION AND ACREAGE DEDICATION PLAT**  
 SEE INSTRUCTIONS FOR COMPLETING THIS FORM ON THE REVERSE SIDE

FORM C-128  
Revised 5/1/57

**SECTION A**

Operator <b>Mildred Hudson</b>		Lease <b>Mann</b>		Well No. <b>2</b>
Unit Letter <b>C</b>	Section <b>9</b>	Township <b>18 South</b>	Range <b>27 East</b>	County <b>Eddy</b>
Actual Footage Location of Well: <b>660</b> feet from the <b>North</b> line and <b>1980</b> feet from the <b>West</b> line				
Ground Level Elev. <b>3565</b>	Producing Formation <b>San Andres</b>		Pool <b>Red Lake</b>	Dedicated Acreage: <b>40</b> Acres

1. Is the Operator the only owner in the dedicated acreage outlined on the plat below? YES ☒ NO ☐ . ("Owner" means the person who has the right to drill into and to produce from any pool and to appropriate the production either for himself or for himself and another. (65-3-29 (e) NMSA 1935 Comp.)
2. If the answer to question one is "no," have the interests of all the owners been consolidated by communitization agreement or otherwise? YES ☐ NO ☐ . If answer is "yes," Type of Consolidation \_\_\_\_\_
3. If the answer to question two is "no," list all the owners and their respective interests below:

Owner	Land Description
	<b>RECEIVED</b> <b>NOV 24 1961</b> NEW MEXICO SURVEY

**SECTION B**

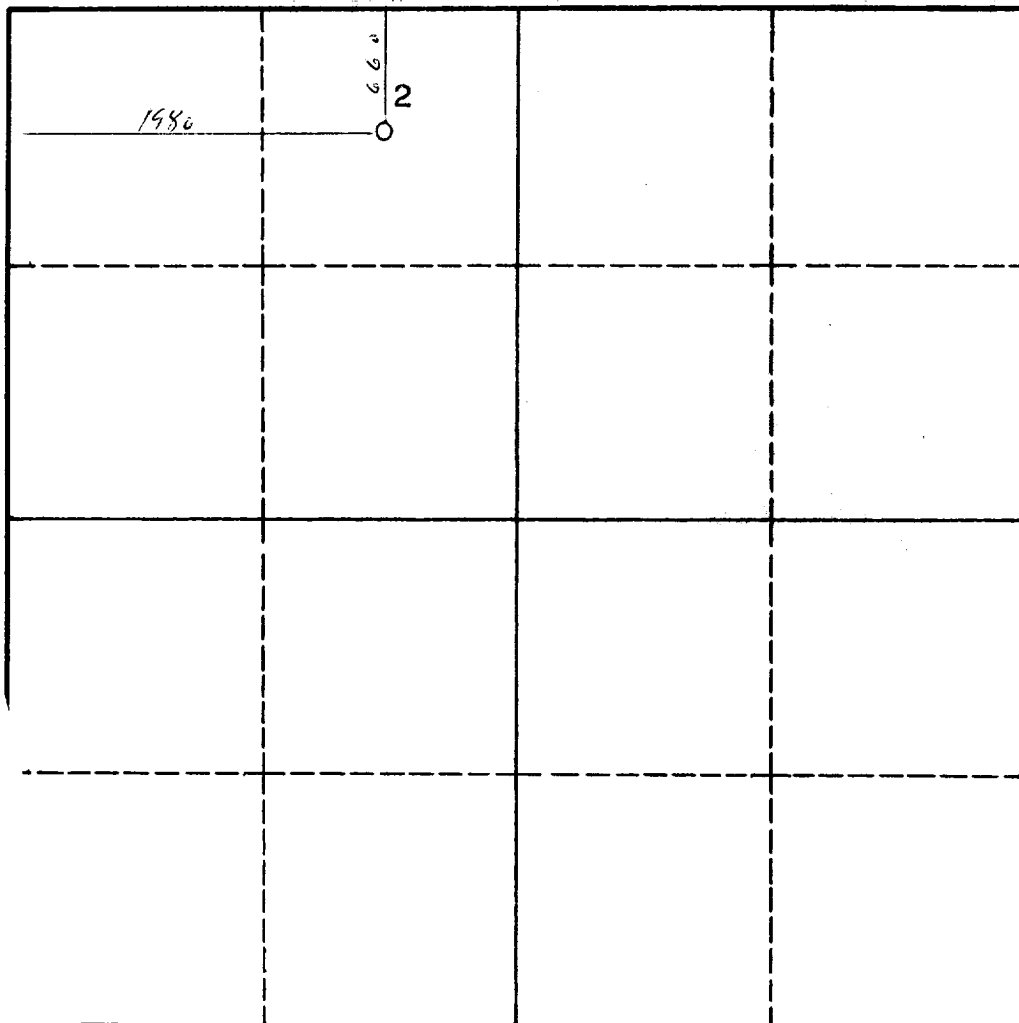

**CERTIFICATION**

I hereby certify that the information in SECTION A above is true and complete to the best of my knowledge and belief.

<b>Mildred Crane Hudson</b>	
Name	<b>Operator</b>
Position	
Company	<b>Crane Hudson</b>
Date	<b>Nov 27, 1961</b>

I hereby certify that the well location shown on the plat in SECTION B was plotted from field notes of actual surveys made by me or under my supervision, and that the same is true and correct to the best of my knowledge and belief.

Date Surveyed	<b>Nov. 19, 1961</b>
Registered Professional Engineer and/or Land Surveyor	<b>John A. Matney Jr.</b>
Certificate No.	<b>1502</b>

## INSTRUCTIONS FOR COMPLETION OF FORM C-128

1. Operator shall furnish and certify to the information called for in Section A.
2. Operator shall outline the dedicated acreage for *both* oil and gas wells on the plat in Section B.
3. A registered professional engineer or land surveyor registered in the State of New Mexico or approved by the Commission shall show on the plat the location of the well and certify this information in the space provided.
4. All distances shown on the plat must be from the outer boundaries of the Section.
5. If additional space is needed for listing owners and their respective interests as required in question 3 of Section A, please use space below.