

(SUBMIT IN TRIPLICATE)

UNITED STATES  
DEPARTMENT OF THE INTERIOR  
GEOLOGICAL SURVEYRECEIVED  
MAY 4 1961  
Office

Lease No. NM 025604

30-215-00851

APPROVAL IS SUBJECT TO STATE  
ENGINEERING DEPARTMENT'S REQUIREMENTS REQUIRED  
ON VARIOUS TYPES OF PERMIT TO  
DRILL FOR OIL AND GAS IN NEW MEXICO

## SUNDRY NOTICES AND REPORTS ON WELLS

NOTICE OF INTENTION TO DRILL.....	<input checked="" type="checkbox"/>	SUBSEQUENT REPORT OF WATER SHUT-OFF.....	
NOTICE OF INTENTION TO CHANGE PLANS.....		SUBSEQUENT REPORT OF SHOOTING OR ACIDIZING.....	
NOTICE OF INTENTION TO TEST WATER SHUT-OFF.....		SUBSEQUENT REPORT OF ALTERING CASING.....	
NOTICE OF INTENTION TO RE-DRILL OR REPAIR WELL.....		SUBSEQUENT REPORT OF RE-DRILLING OR REPAIR.....	
NOTICE OF INTENTION TO SHOOT OR ACIDIZE.....		SUBSEQUENT REPORT OF ABANDONMENT.....	
NOTICE OF INTENTION TO PULL OR ALTER CASING.....		SUPPLEMENTARY WELL HISTORY.....	
NOTICE OF INTENTION TO ABANDON WELL.....			

(INDICATE ABOVE BY CHECK MARK NATURE OF REPORT, NOTICE, OR OTHER DATA)

April 26, 1961

USA Males Refineries "NG"

Well No. 13 is located 2302.08 ft. from ~~1000~~ S line and 1650 ft. from ~~1000~~ W line of sec. 10NR/4, SW/4, Sec. 10  
(1/4 Sec. and Sec. No.)T-18-S, R-27-E  
(Twp.) (Range)NMPM  
(Meridian)Empire Abo  
(Field)Edgy  
(County or Subdivision)New Mexico  
(State or Territory)

The elevation of the derrick floor above sea level is ft. Not Yet Available.

## DETAILS OF WORK

(State names of and expected depths to objective sands; show sizes, weights, and lengths of proposed casings; indicate mudding jobs, cementing points, and all other important proposed work)

It is proposed to drill a 6100' Abo well with rotary tools. Logs will be run and indicated pays perforated, stimulated and evaluated. Casing program to be as follows:

Hole Size	Casing Size & Wt.	APPROX. Depth	Gr. Cement
1 1/8"	8-5/8" - 24#	1500'	Sufficient to circulate
7-7/8"	4-1/2" - 9.5#	6100'	Sufficient to tie into surface casing.

Estimated tops of geological markers, Queen - 1000', Yess - 3200', Abo - 5000', Abo Pay - 5875'.

I understand that this plan of work must receive approval in writing by the Geological Survey before operations may be commenced.

Company Pan American Petroleum Corporation

Address Box 68

Hobbs, New Mexico

By V. E. STALEY

Title Area Superintendent

NEW MEXICO OIL CONSERVATION COMMISSION  
WELL LOCATION AND ACREAGE DEDICATION PLAT

SEE INSTRUCTIONS FOR COMPLETING THIS FORM ON THE REVERSE SIDE

SECTION A

Operator <b>PAN AMERICAN PETROLEUM CORP.</b>		Lease <b>USA MALCO REFINERIES "G"</b>		Well No. <b>D. E. B.</b>	
Unit Letter <b>K</b>	Section <b>10</b>	Township <b>18 SOUTH</b>	Range <b>27 EAST</b>	County <b>EDDY</b>	
Actual Footage Location of Well: <b>2302.08</b> feet from the <b>SOUTH</b> line and <b>1650</b> feet from the <b>WEST</b> line					
Ground Level Elev. <b>Not Yet Avail</b>	Producing Formation <b>Abo</b>		Pool <b>Empire Abo</b>		Dedicated Acreage: <b>40</b> Acres

1. Is the Operator the only owner in the dedicated acreage outlined on the plat below? YES ☒ NO ☐ ("Owner" means the person who has the right to drill into and to produce from any pool and to appropriate the production either for himself or for himself and another. (65-3-29 (e) NMSA 1935 Comp.)
2. If the answer to question one is "no," have the interests of all the owners been consolidated by communization agreement or otherwise? YES ☐ NO ☐ If answer is "yes," Type of Consolidation \_\_\_\_\_
3. If the answer to question two is "no," list all the owners and their respective interests below.

Owner	Land Description

RECEIVED

MAY 1 1961

U. S. GEOLOGICAL SURVEY  
ARTESIA, NEW MEXICO  
CERTIFICATION

I hereby certify that the information in SECTION A above is true and complete to the best of my knowledge and belief.

Original Signed by:  
**V. E. STALEY**

Position  
**Area Superintendent**

Company  
**Pan American Petroleum Corp.**

Date  
**April 27, 1961**

I hereby certify that the well location shown on the plat in SECTION B was plotted from field notes of actual surveys made by me or under my supervision, and that the same is true and correct to the best of my knowledge and belief.

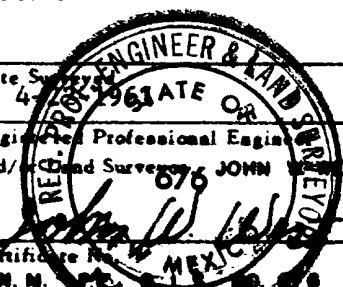
Date Surveyed <b>4-27-1961</b>	
Registered Professional Engineer and/or Land Surveyor <b>JOHN W. WEST</b>	
Certificate No. <b>NEW MEXICO</b>	

SECTION B

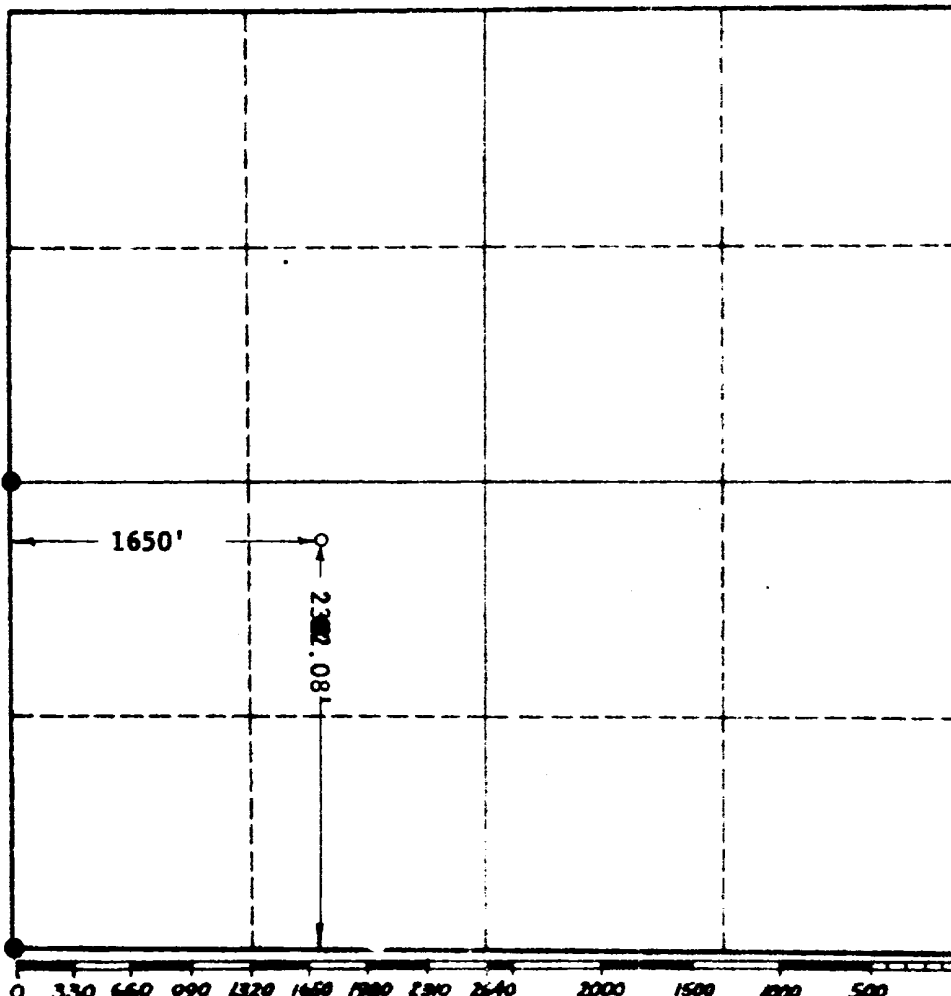

## JOHN W. WEST ENGINEERING COMPANY

412 NORTH DAL PASO  
HOBBS, NEW MEXICO

APRIL 25, 1961

RECEIVED  
MAY 4 1961  
D. C. C.  
ARTESIA, OFFICEPAN AMERICAN PETROLEUM CORP.  
P. O. Box 68  
HOBBS, NEW MEXICO

GENTLEMEN:

APRIL 22, 1961, A SURVEY WAS MADE TO STAKE THE LOCATION FOR YOUR U. S. A. MALCO REFINERIES G No. 13 IN THE NE $\frac{1}{4}$ SW $\frac{1}{4}$  SEC. 10, TWP 18 SOUTH, RANGE 27 EAST, NMPM, EDDY COUNTY, NEW MEXICO.

THE SURVEY WAS STARTED AT THE USGLO MARKER FOR THE CORNER COMMON TO SECTIONS 9, 10, 15 AND 16, THENCE N0°23'E ALONG THE BOUNDARY LINE COMMON TO SECTIONS 9 AND 10 A DISTANCE OF 2302.08 FEET, THENCE S89°13'E PARALLEL WITH THE SOUTH BOUNDARY LINE OF THE SECTION A DISTANCE OF 1650.0 FEET TO THE LOCATION. TO CHECK WE THEN CHAINED N89°13'W 1650.2 FEET BACK TO THE SECTION LINE, THENCE N0°23'E A DISTANCE OF 330.2 FEET TO THE USGLO QUARTER CORNER MARKER COMMON TO SECTIONS 9 AND 10, MAKING THE CLOSURE WITHIN THE ALLOWABLE LIMITS OF THIS SURVEY.

I HEREBY CERTIFY THAT THE FOREGOING SURVEY WAS MADE IN THE FIELD UNDER MY SUPERVISION AND THAT THE SAME IS TRUE AND CORRECT TO THE BEST OF MY KNOWLEDGE AND BELIEF.

YOURS VERY TRULY,



JOHN W. WEST