

NEW MEXICO OIL CONSERVATION COMMISSION
Santa Fe, New Mexico

Form G-101
Revised (12/1/55)

NOTICE OF INTENTION TO DRILL

Notice must be given to the District Office of the Oil Conservation Commission and approval obtained before drilling or recompletion begins. If changes in the proposed plan are considered advisable, a copy of this notice showing such changes will be returned to the sender. Submit this notice in QUINTUPLICATE. One copy will be returned following approval. See additional instructions in Rules and Regulations of the Commission. If State Land submit 6 Copies Attach Form G-128 in triplicate to first 3 copies of form G-101

Hobbs, New Mexico

(Place)

November 16, 1961

(Date)

OIL CONSERVATION COMMISSION
SANTA FE, NEW MEXICO

Gentlemen:

You are hereby notified that it is our intention to commence the Drilling of a well to be known as

Gulf Oil Corporation

(Company or Operator)

O. C. C.
ARTESIA, OFFICE

Hoby State "BU"

(Lease)

Well No. 1, in J

(Unit)

located 2304 feet from the South line and 2310 feet from the

East

line of Section 16, T. 18-S, R. 27-E, NMPM.

(GIVE LOCATION FROM SECTION LINE)

Empire Abbe

Pool,

Hoby

County

If State Land the Oil and Gas Lease is No. E-3635

If patented land the owner is

Address

We propose to drill well with drilling equipment as follows: Rotary

The status of plugging bond is

Drilling Contractor Will be furnished later. Bids will not be opened until November 21, 1961

We intend to complete this well in the Abbe

formation at an approximate depth of 6000' feet.

CASING PROGRAM

We propose to use the following strings of Casing and to cement them as indicated:

Size of Hole	Size of Casing	Weight per Foot	New or Second Hand	Depth	Sacks Cement
11"	8-5/8"	21#	New	1550	380
7-7/8"	4-1/2"	9.5#	New	6000	200

If changes in the above plans become advisable we will notify you immediately.

ADDITIONAL INFORMATION (If recompletion give full details of proposed plan of work.)

NOV 17 1961

Approved....., 19.....
Except as follows:

OIL CONSERVATION COMMISSION

By M. L. Armstrong

Sincerely yours,

Gulf Oil Corporation
(Company or Operator)

By J. H. Russell

Position Area Production Manager

Send Communications regarding well to

Name Gulf Oil Corporation

Address Box 2167, Hobbs, New Mexico

OIL CONSERVATION COMMISSION	
ARTESIA DISTRICT OFFICE	
No. Copies Received 6	
DISTRIBUTION	
NO. FURNISHED	OPERATOR
1	SANTA FE
1	PROPRATION OFFICE
2	ARTESIA DISTRICT OFFICE
1	FILE
BUREAU OF MINES	

NEW MEXICO OIL CONSERVATION COMMISSION

FORM C-128
Revised 5/1/57

WELL LOCATION AND ACREAGE DEDICATION PLAT

SEE INSTRUCTIONS FOR COMPLETING THIS FORM ON THE REVERSE SIDE

SECTION A

Operator Gulf Oil Corp.		Lease Eddy State "BU"		Well No. 1
Unit Letter J	Section 16	Township 18 South	Range 27 East	County Eddy
Actual Footage Location of Well: 2304 feet from the South line and 2310 feet from the East line				
Ground Level Elev. 3444	Producing Formation Abbo	Pool Expire Abbo 2 miles	Dedicated Acreage: 10 Acres	

1. Is the Operator the only owner in the dedicated acreage outlined on the plat below? YES ☒ NO ☐ ("Owner" means the person who has the right to drill into and to produce from any pool and to appropriate the production either for himself or for himself and another. (65-1-29 (N.M.S.A. 1953) comp.)
2. If the answer to question one is "no," have the interests of all the owners been consolidated by communitization agreement or otherwise? YES ☐ NO ☐ If answer is "yes," Type of Consolidation **RECEIVED**
3. If the answer to question two is "no," list all the owners and their respective interests below:

Owner	Land Description	NOV 17 1961
		D. C. C.
		ARTESIA, OFFICE

SECTION B

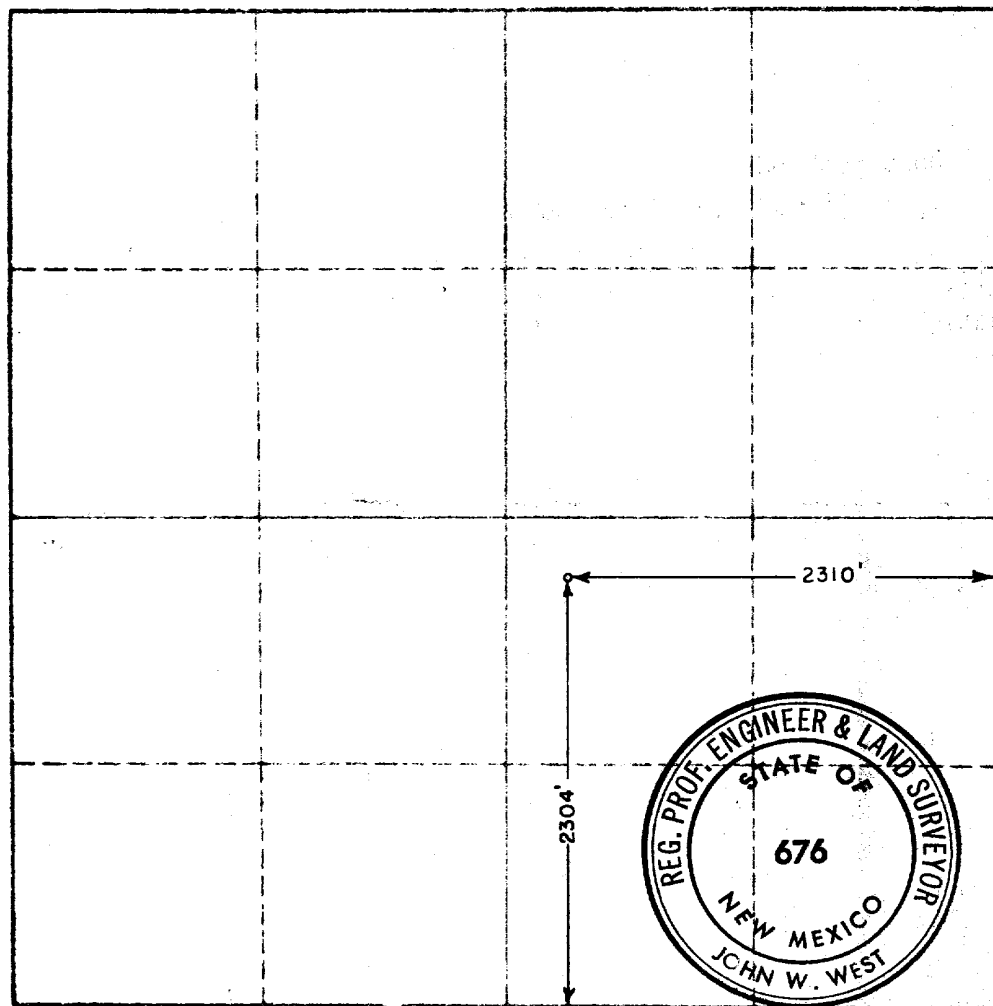

CERTIFICATION

I hereby certify that the information in SECTION A above is true and complete to the best of my knowledge and belief.

Name *John Russell*
Position
Area Production Manager
Company
Gulf Oil Corporation
Date
November 16, 1961

I hereby certify that the well location shown on the plat in SECTION B was plotted from field notes of actual surveys made by me or under my supervision, and that the same is true and correct to the best of my knowledge and belief.

Date Surveyed **9-20-61**
Registered Professional Engineer and/or Land Surveyor, **JOHN W. WEST**
John W. West
Certificate No. **N.M. - P.E. & L.S. NO. 676**

0 330 660 990 1320 1650 1980 2310 2640 2000 1500 1000 500 0

OIL CONSERVATION COMMISSION	
ARTESIA DISTRICT OFFICE	
No. Copies Received	
DISTRIBUTION	
TO	FURNISHED
OPERATOR	
JANITA EL	
ACCOMMODATION OFFICE	
STATE LAND OFFICE	
U. S. G. S.	
TRANSPORTER	
FILE	