

NEW MEXICO OIL CONSERVATION COMMISSION
Santa Fe, New Mexico

RECEIVED
JUN 27 1960

NOTICE OF INTENTION TO DRILL

Notice must be given to the District Office of the Oil Conservation Commission and approval obtained before drilling or recompletion begins. If changes in the proposed plan are considered advisable, a copy of this notice showing such changes will be returned to the sender. Submit this notice in QUINTUPPLICATE. One copy will be returned following approval. See additional instructions in Rules and Regulations of the Commission. If State Land submit 6 Copies Attach Form O-128 in triplicate to first 3 copies of form O-128

Midland, Texas
(Place)

June 23, 1960
(Date)

OIL CONSERVATION COMMISSION
SANTA FE, NEW MEXICO

30-015-00902

Gentlemen:

You are hereby notified that it is our intention to commence the Drilling of a well to be known as

Humble Oil & Refining Company

Continental Oil Co. Lease

Abo-Chalk Bluff Draw Unit

(Company or Operator)

13

"E"

Well No.

(Unit)

The well is

located 1980' feet from the North line and 660' feet from the West line of Section 16, T.-18-S., R.-27-E., NMPM.

(GIVE LOCATION FROM SECTION LINE)

Empire Abo

Pool,

Eddy

County

If State Land the Oil and Gas Lease is No. E-1049 - Continental Oil Co. Lease

If patented land the owner is

Address

We propose to drill well with drilling equipment as follows: Rotary

The status of plugging bond is On file with commission office

Drilling Contractor Lee Drilling Company

We intend to complete this well in the Abo

formation at an approximate depth of 6100 feet

CASING PROGRAM

We propose to use the following strings of Casing and to cement them as indicated:

Size of Hole	Size of Casing	Weight per Foot	New or Second Hand	Depth	Cement Cement
11"	8-5/8"	24#	New	1500'	150*
7-7/8"	4-1/2"	9.5#	New	6100'	200**

If changes in the above plans become advisable we will notify you immediately.

ADDITIONAL INFORMATION (If recompletion give full details of proposed plan of work.)

*Circulate cement to surface

**Circulate cement back to 8-5/8" casing

Minimum mud for samples. HOWCO method of cementing to be used.

Surface casing to be set & cemented in accordance with State Engineering Memo No. 63 covering the Artesia Water Basin.

Approved _____, 19____

Except as follows:

JUL 1 1960

Sincerely yours,

HUMBLE OIL & REFINING COMPANY

(Company or Operator)

By *A. J. Bedford*

Position Area Administrative Coordinator

Send Communications regarding well to

Name Mr. R. R. McCarty

Address Box 1600, Midland, Texas

OIL CONSERVATION COMMISSION

By *M. L. Armstrong*
OIL AND GAS INSPECTOR

NEW MEXICO OIL CONSERVATION COMMISSION

Well Location and Acreage Dedication

RECEIVED
JUN 27 1960

Section A.

Date June 22, 1960
ARTESIA, OFFICE

Operator Humble Oil & Refining Co. Lease Abo-Chalk Bluff Draw Unit
Well No. 13 Unit Letter "E" Section 16 Township 18 South Range 27 East NMPM
Located 1980 Feet From North Line, 660 Feet From West Line
County Eddy G. L. Elevation Later Dedicated Acreage 40 Acres
Name of Producing Formation Abo Pool Empire-Abo

1. Is the Operator the only owner* in the dedicated acreage outlined on the plat below?
Yes _____ No ✓
2. If the answer to question one is "no", have the interests of all the owners been consolidated by communitization agreement or otherwise? Yes ✓ No _____ If answer is "yes," Type of Consolidation Unitization
3. If the answer to question two is "no," list all the owners and thier respective interests below:

Owner

Land Description

<u>Owner</u>	<u>Land Description</u>

Section B

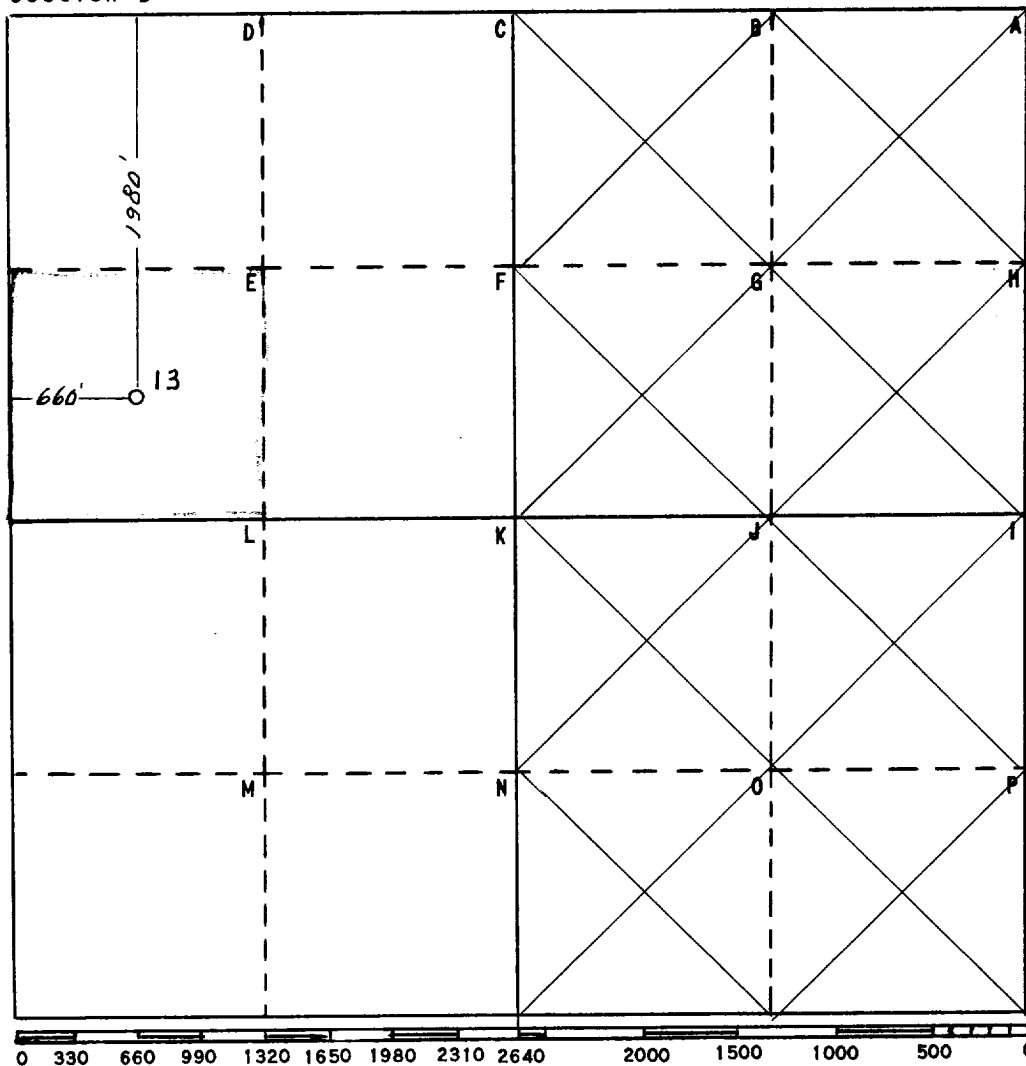

This is to certify that the information in Section A above is true and complete to the best of my knowledge and belief

HUMBLE OIL & REFG. CO.
(Operator)

H. P. Hensley
(Representative)

Box 1600 Midland, Texas
Address

This is to certify that the well location shown on the plat in Section B was plotted from field notes of actual surveys made by me or under my supervision and that the same is true and correct to the best of my knowledge and belief.

Date Surveyed 6-20-60
H. N. Strickland
Registered Professional
Engineer and/or Land Surveyor

Certificate No. 2156

OIL CONSERVATION COMMISSION
ARTESIA DISTRICT OFFICE

No. Copies Received

6

DISTRIBUTION

	NO. FURNISHED	
MANAGER	1	
MANAGER	1	
PRODUCING OFFICE	1	
STATE LAND OFFICE	1	
U. S. G. O.	2	
TRANSPORTER		
FILE	1	
BUREAU OF MINES		