

NEW MEXICO OIL CONSERVATION COMMISSION
Santa Fe, New Mexico

Form C-101
Revised (12/1/55)

RECEIVED

NOTICE OF INTENTION TO DRILL

Notice must be given to the District Office of the Oil Conservation Commission and approval obtained before drilling or recompletion begins. If changes in the proposed plan are considered advisable, a copy of this notice showing such changes will be returned to the sender. Submit this notice in QUINTUPLICATE. One copy will be returned following approval. See additional instructions in Rules and Regulations of the Commission. If State Land submit 6 Copies Attach Form C- 128 in triplicate to first 3 copies of form C-101

Midland, Texas
(Place)

9-22-60
(Date)

OIL CONSERVATION COMMISSION
SANTA FE, NEW MEXICO

Gentlemen:

You are hereby notified that it is our intention to commence the Drilling of a well to be known as

Humble Oil & Refining Co. Gulf Lse. E-3635
(Company or Operator)

Abo-Chalk Bluff Draw Unit, Well No. 18, in M The well is
(Lease) (Unit)

located 660 feet from the South line and 660 feet from the

West line of Section 16, T. 18-S, R. 27-E, NMPM.

(GIVE LOCATION FROM SECTION LINE) Empire Abo Pool, Eddy County

If State Land the Oil and Gas Lease is No. Gulf Lse. E-3635

If patented land the owner is

Address

We propose to drill well with drilling equipment as follows: rotary

The status of plugging bond is on file

Drilling Contractor unknown

We intend to complete this well in the Abo
formation at an approximate depth of 6100 feet.

CASING PROGRAM

We propose to use the following strings of Casing and to cement them as indicated:

Size of Hole	Size of Casing	Weight per Foot	New or Second Hand	Depth	Sacks Cement
11"	8-5/8"	24#	New	1500'	150*
7-7/8	4-1/2	9.50	New	6100'	200**

If changes in the above plans become advisable we will notify you immediately.

ADDITIONAL INFORMATION (If recompletion give full details of proposed plan of work.)

*Circulate cmt to surface.

**Circulate cmt to 8-5/8 casing.

Minimum mud for samples. HOWCO Method of cementing to be used.

Surface casing to be set and cemented in accordance with State Engineering Memo No. 63 covering the Artesia Water Basin.

Approved _____, 19_____
Except as follows: SEP 23 1960

Sincerely yours,

HUMBLE OIL & REFINING COMPANY
(Company or Operator)

By

Position Area Adm.

Send Communications regarding well to

Name R. R. McCarty

Address Box 1600, Midland, Texas

OIL CONSERVATION COMMISSION

By

OIL AND GAS INSPECTOR

RECEIVED

HUMBLE LEASE NO.

NEW MEXICO OIL CONSERVATION COMMISSION

STATE LEASE NO. E3635 "Gulf Lease"

SEP 23 1960

FEDERAL LEASE NO.

Well Location and Acreage Dedication Plat

Revised 5/1/57

Section A.

Date Sept 19 1960 O. C. C.
ARTESIA, N.M.

Operator Humble Oil & Refining Co Lease Abo - Chalk Bluff Draw Unit
Well No. 18 Unit Letter "M" Section 16 Township 18 South Range 27 East NMPM
Located 660 Feet From South Line, 660 Feet From West Line
County Eddy G. L. Elevation Later Dedicated Acreage 40 Acres
Name of Producing Formation Abo Pool Empire Abo

1. Is the Operator the only owner* in the dedicated acreage outlined on the plat below?

Yes No ✓

2. If the answer to question one is "no", have the interests of all the owners been consolidated by communitization agreement or otherwise? Yes ✓ No If answer is "yes," Type of Consolidation Unitization

3. If the answer to question two is "no," list all the owners and thier respective interests below:

Owner

Land Description

Section B

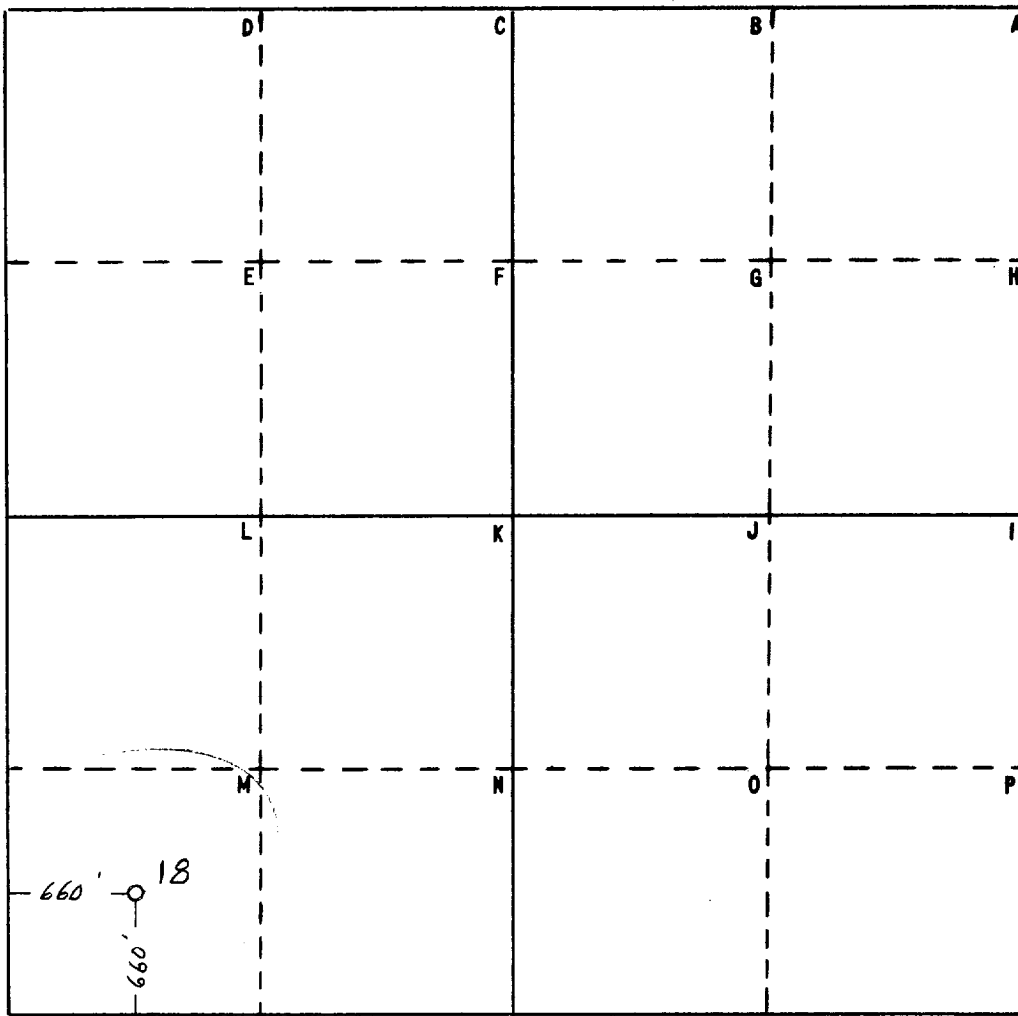

This is to certify that the information in Section A above is true and complete to the best of my knowledge and belief

HUMBLE OIL & REFG. CO.

(Operator)

J. S. Bolchuck
(Representative)

Box 1600 Midland, Texas
Address

This is to certify that the well location shown on the plat in Section B was plotted from field notes of actual surveys made by me or under my supervision and that the same is true and correct to the best of my knowledge and belief.

Date Surveyed Sept. 19 1960

H. S. Winterfield
Registered Professional
Engineer and/or Land Surveyor

Certificate No. 1382

0 330 660 990 1320 1650 1980 2310 2640 2000 1500 1000 500 0

FILE NO. W-A-2814

OIL CONSERVATION COMMISSION		
ARTESIA DISTRICT OFFICE		
No. Copies Received	6	
DISTRIBUTION		
	NO. FURNISHED	
OPERATOR	1	
SANTA FE	1	
PRORATION OFFICE		
STATE LAND OFFICE	1	
U. S. G. S.	2	
TRANSPORTER		
FILE	1	
BUREAU OF MINES		