

RECEIVED

HUMBLE LEASE NO.

NEW MEXICO OIL CONSERVATION COMMISSION

SEP 23 1960

STATE LEASE NO. "7989 Pan American Lease"

Form C-128

FEDERAL LEASE NO.

Well Location and Acreage Dedication Plat

Revised 5/1/57

O. C. T.

ARTESIA, OFFICE

Date Sept 20, 1960

Section A.

Operator Humble Oil & Refining Co Lease Abo-chalk Bluff Draw Unit
Well No. 19 Unit Letter "N" Section 16 Township 18 South Range 27 East NMPH
Located 660 Feet From South Line, 1650 Feet From West Line
County Eddy G. L. Elevation Later Dedicated Acreage 40 Acres
Name of Producing Formation Abo Pool Empire-Abo

1. Is the Operator the only owner* in the dedicated acreage outlined on the plat below?
Yes _____ No ✓
2. If the answer to question one is "no", have the interests of all the owners been consolidated by communitization agreement or otherwise? Yes ✓ No _____ If answer is "yes," Type of Consolidation Unitization
3. If the answer to question two is "no," list all the owners and thier respective interests below:

Owner

Land Description

Section B

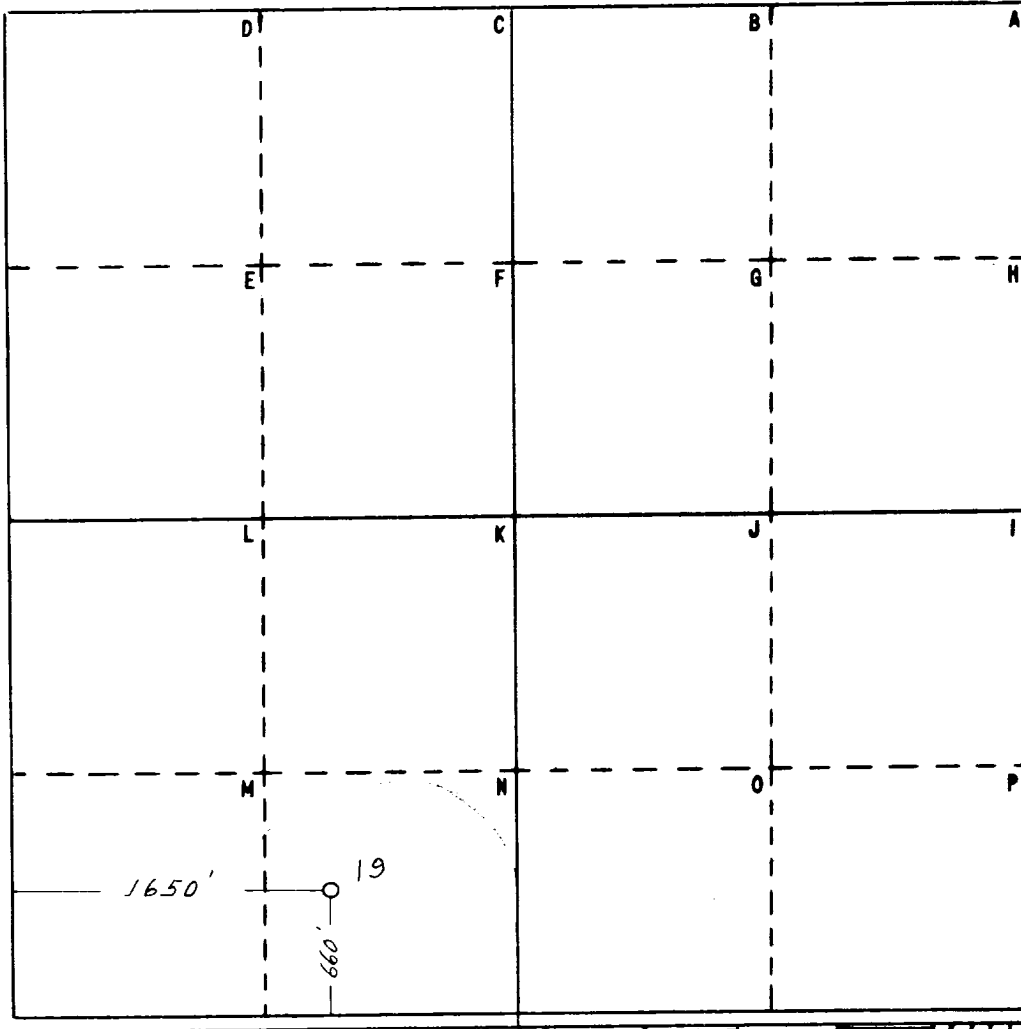

This is to certify that the information in Section A above is true and complete to the best of my knowledge and belief

HUMBLE OIL & REFG. CO.

(Operator)

J. B. Boldrick
(Representative)

Box 1600 Midland, Texas
Address

This is to certify that the well location shown on the plat in Section B was plotted from field notes of actual surveys made by me or under my supervision and that the same is true and correct to the best of my knowledge and belief.

Date Surveyed Sept 19, 1960

H. D. Hunterfield
Registered Professional
Engineer and/or Land Surveyor

Certificate No. 1386

0 330 660 990 1320 1650 1980 2310 2640 2000 1500 1000 500 0

FILE NO. W-A-2814

OIL CONSERVATION COMMISSION
ARTESIA DISTRICT OFFICE

No. Copies Received

6

DISTRIBUTION

NO.

APPROVED

1

DATE

TIME

BY

RECEIVED OFFICE

NO.

DATE

TIME

BY

2

1

✓