

(SUBMIT IN TRIPLICATE)

Fed. Land Office NM 04175-8(6)

Lease No. Humble 231616

Unit H

UNITED STATES  
DEPARTMENT OF THE INTERIOR  
GEOLOGICAL SURVEYRECEIVED  
30-015-00973  
JUN 7 1960

See attached plat

## SUNDRY NOTICES AND REPORTS ON WELLS

	X	
NOTICE OF INTENTION TO DRILL		SUBSEQUENT REPORT OF WATER SHUT-OFF
NOTICE OF INTENTION TO CHANGE PLANS		SUBSEQUENT REPORT OF SHOOTING OR ACIDIZING
NOTICE OF INTENTION TO TEST WATER SHUT-OFF		SUBSEQUENT REPORT OF ALTERING CASING
NOTICE OF INTENTION TO RE-DRILL OR REPAIR WELL		SUBSEQUENT REPORT OF RE-DRILLING OR REPAIR
NOTICE OF INTENTION TO SHOOT OR ACIDIZE		SUBSEQUENT REPORT OF ABANDONMENT
NOTICE OF INTENTION TO PULL OR ALTER CASING		SUPPLEMENTARY WELL HISTORY
NOTICE OF INTENTION TO ABANDON WELL		

(INDICATE ABOVE BY CHECK MARK NATURE OF REPORT, NOTICE, OR OTHER DATA)

ABO-CHALK BLUFF DRAW UNIT

June 1, 1960

Well No. 11 is located 1980 ft. from ~~X~~<sup>N</sup><sub>S</sub> line and 330 ft. from ~~X~~<sup>E</sup><sub>W</sub> line of sec. 17

SE/4 of NE/4 18-S 27-E (Meridian)  
(1/4 Sec. and Sec. No.) (Twp.) (Range)  
Empire-Abo Eddy New Mexico  
(Field) (County or Subdivision) (State or Territory)

The elevation of the derrick floor above sea level is later ft.

## DETAILS OF WORK

(State names of and expected depths to objective sands; show sizes, weights, and lengths of proposed casings; indicate mudlogging jobs, cementing points, and all other important proposed work)

## CASING PROGRAM

## DEPTH

## CEMENTING PROGRAM

## CORING PROGRAM

Size	Wt.
8-5/8	24#
4-1/2	9.50#

1500  
6100Circulate to surface.  
Circulate to 8-5/8" csg.

None

Halliburton method of cementing to be used.

Minimum mud for samples.

Proposed total depth 6100' to test the Abo Formation.

Surf. csg. to be set &amp; cmtd in accordance with State Engineering Memo No. 63 covering the Artesia Water Basin.

ARTESIA WATER BASIN  
ENGINEERING MEMO NO. 63  
ON THE PROPOSED PERMITS TO  
DRILL FOR OIL IN THE WATER BASIN.  
BOX 810, ROSWELL, NEW MEXICO

I understand that this plan of work must receive approval in writing by the Geological Survey before operations may be commenced.

Company Humble Oil &amp; Refining Co.

Address Box 1600

Midland, Texas

By C. O. East

Title Area Adm.

STATE LEASE NO. \_\_\_\_\_

FEDERAL LEASE NO. NM-04175-D

Form C-128

Revised 5/1/57

## NEW MEXICO OIL CONSERVATION COMMISSION

Well Location and Acreage Dedication Plat

Section A.

Date June 1, 1960

Operator Humble Oil & Refining Co. Lease Abo - Chalk Bluff Draw Unit  
 Well No. 11 Unit Letter H Section 17 Township 18 South Range 27 East NMPM  
 Located 1980' Feet From North Line, 330 Feet From East Line  
 County Eddy G. L. Elevation Later Dedicated Acreage 40 Acres  
 Name of Producing Formation Abo Pool Empire - Abo

1. Is the Operator the only owner\* in the dedicated acreage outlined on the plat below?

Yes ☒ No ☐2. If the answer to question one is "no", have the interests of all the owners been consolidated by communitization agreement or otherwise? Yes ☐ No ☐ If answer is "yes," Type of Consolidation \_\_\_\_\_

3. If the answer to question two is "no," list all the owners and thier respective interests below:

OwnerLand Description

\_\_\_\_\_  
 \_\_\_\_\_  
 \_\_\_\_\_

\_\_\_\_\_  
 \_\_\_\_\_  
 \_\_\_\_\_

Section B

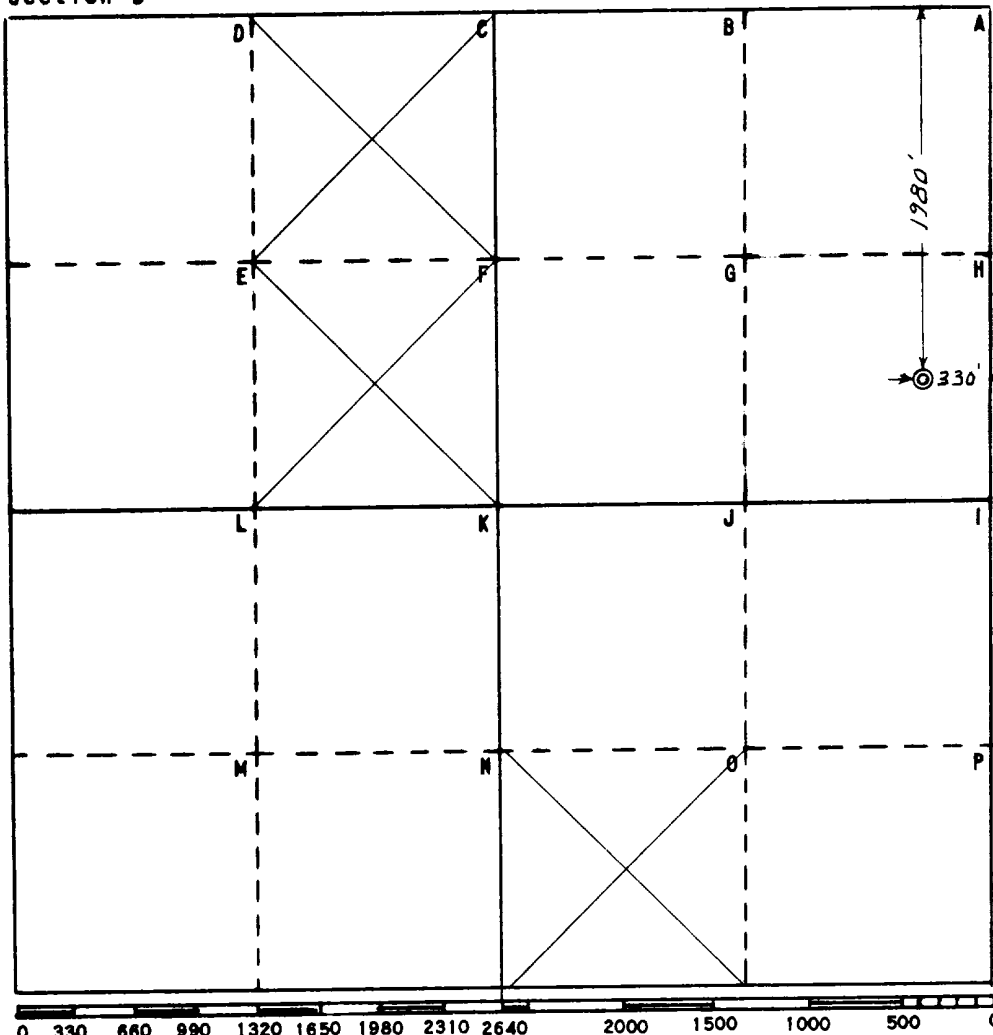

This is to certify that the information in Section A above is true and complete to the best of my knowledge and belief

HUMBLE OIL & REFG. CO.  
 (Operator)

H. P. Stensley  
 (Representative)

Box 1600 Midland, Texas  
 Address

This is to certify that the well location shown on the plat in Section B was plotted from field notes of actual surveys made by me or under my supervision and that the same is true and correct to the best of my knowledge and belief.

Date Surveyed June 1, 1960

H. S. Hunter  
 Registered Professional  
 Engineer and/or Land Surveyor

Certificate No. 1382