

NEW MEXICO OIL CONSERVATION COMMISSION

Well Location and Acreage Dedication Plat

Section A.

Date 3-16-59

Operator HUMBLE OIL & REFG. CO Lease Chalk Bluff Draw Unit - C
Well No. 1 Unit Letter "G" Section 17 Township 18 S Range 27 E NMPM
located 1980 Feet From North Line, 1980 Feet From East Line
County Eddy G. L. Elevation _____ Dedicated Acreage 40 Acres
Name of Producing Formation Wolfcamp Pool Chalk Bluff Draw

1. Is the Operator the only owner* in the dedicated acreage outlined on the plat below?
Yes _____ No ✓.
2. If the answer to question one is "no," have the interests of all the owners been consolidated by communitization agreement or otherwise? Yes ✓ No _____. If answer is "yes," type of Consolidation Unitization
3. If the answer to question two is "no," list all the owners and their respective interests below:

Owner

Land Description

RECEIVED
MAR 24 1959
U. S. GEOLOGICAL SURVEY
ARTESIA, NEW MEXICO

Section B

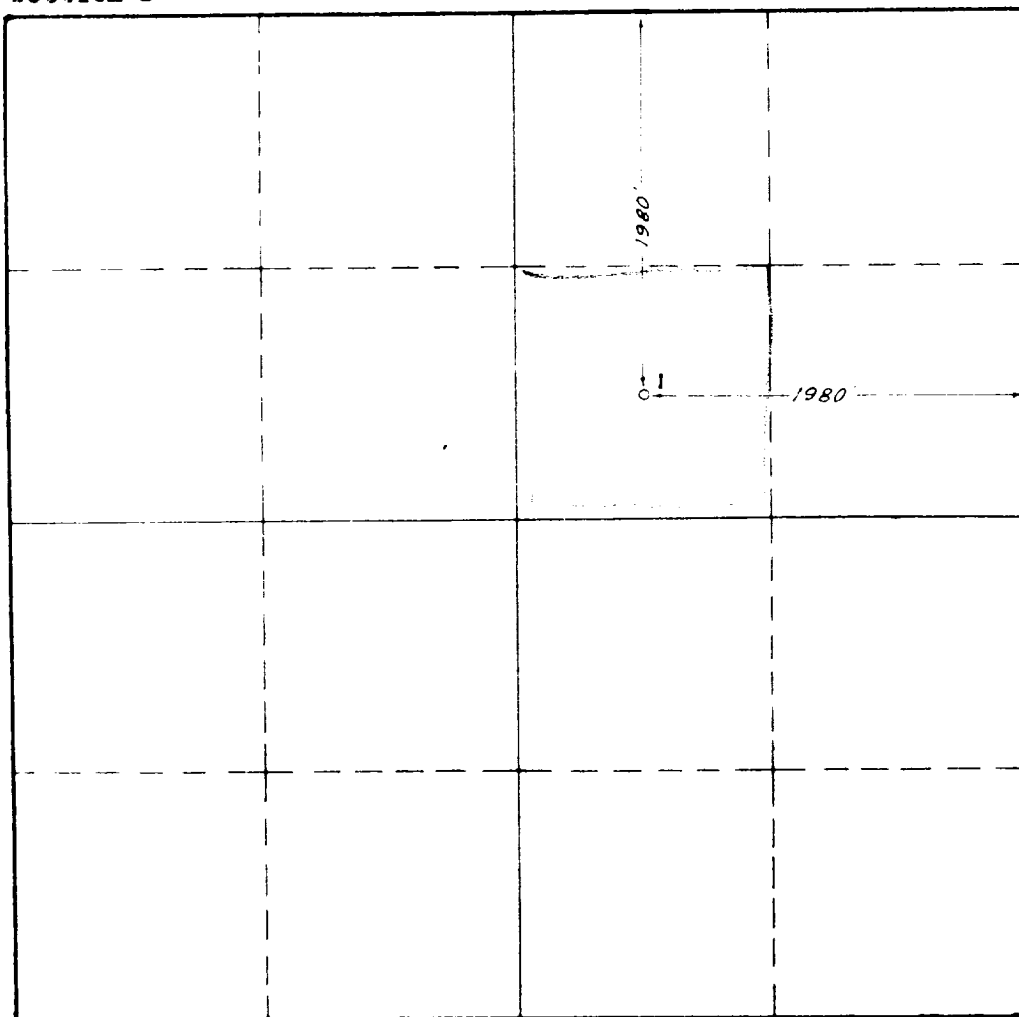

This is to certify that the information in Section A above is true and complete to the best of my knowledge and belief.

HUMBLE OIL & REFG. CO
(Operator)

H. L. Hensley
(Representative)
Assistant Division Supt.
Box 1600 Midland, Texas
Address

This is to certify that the well location shown on the plat in Section B was plotted from field notes of actual surveys made by me or under my supervision and that the same is true and correct to the best of my knowledge and belief.

Date Surveyed 3-13-59

W. S. Hunterfield
Registered Professional
Engineer and/or Land Surveyor.

0 330 660 990 1320 1650 1980 2310 2640 2000 1500 1000 500 0

Certificate No. 1382

LEASE NO. 231616