

(SUBMIT IN TRIPLICATE)

UNITED STATES
DEPARTMENT OF THE INTERIOR
GEOLOGICAL SURVEY

Budget Bureau No. 42-R358.4
Approval expires 12-31-60.

Land Office NM 0758
Lease No. 231616
Unit F
RECEIVED

SEP 2 1961

SUNDRY NOTICES AND REPORTS ON WELLS, C. C.
ARTESIA, OFFICE

NOTICE OF INTENTION TO DRILL	X	SUBSEQUENT REPORT OF WATER SHUT-OFF
NOTICE OF INTENTION TO CHANGE PLANS		SUBSEQUENT REPORT OF SHOOTING OR ACIDIZING
NOTICE OF INTENTION TO TEST WATER SHUT-OFF		SUBSEQUENT REPORT OF ALTERING CASING
NOTICE OF INTENTION TO RE-DRILL OR REPAIR WELL		SUBSEQUENT REPORT OF RE-DRILLING OR REPAIR
NOTICE OF INTENTION TO SHOOT OR ACIDIZE		SUBSEQUENT REPORT OF ABANDONMENT
NOTICE OF INTENTION TO PULL OR ALTER CASING		SUPPLEMENTARY WELL HISTORY
NOTICE OF INTENTION TO ABANDON WELL		

(INDICATE ABOVE BY CHECK MARK NATURE OF REPORT, NOTICE, OR OTHER DATA)

Abo-Chalk Bluff Draw Unit 9-22-61, 19

Well No. 27 is located 1980 ft. from $\begin{Bmatrix} N \\ S \end{Bmatrix}$ line and 1980 ft. from $\begin{Bmatrix} E \\ W \end{Bmatrix}$ line of sec. 17

SE/4 of NW/4 18-S 27-E (Meridian)
(1/4 Sec. and Sec. No.) (Twp.) (Range)
Empire Abo Eddy New Mexico
(Field) (County or Subdivision) (State or Territory)

The elevation of the derrick floor above sea level is later ft.

DETAILS OF WORK

(State names of and expected depths to objective sands; show sizes, weights, and lengths of proposed casings; indicate mudlogging jobs, cementing points, and all other important proposed work)

CASING PROGRAM	DEPTH	CEMENTING PROGRAM	CORING PROGRAM
Size Wt			
8-5/8 24#	1500	Circl. to surf.	None
4-1/2 9.50	5900	Circl. to 8-5/8 csg.	

Halliburton method of cementing to be used.

Minimum mud for samples.

Proposed TD 5900' to test the Abo Formation.

Surf. csg. to be set & cmtd in accordance w/State Engineering Memo No. 63 covering the Artesia Water Basin.

RECEIVED

SEP 25 1961

U. S. GEOLOGICAL SURVEY
ARTESIA, NEW MEXICO

I understand that this plan of work must receive approval in writing by the Geological Survey before operations may be commenced.

Company Humble Oil & Refining Co.

Address Box 1600

Midland, Texas

By J.E. Pinkerton

Title Adm. Supervisor

Section A.

Date 9-20-61

Operator Humble Oil & Refining Co. Lease Abbo Bluff Draw Unit
 Well No. 27 Unit Letter F Section 17 Township 18-S Range 27 NMPM
 Located 1980 Feet From North Line, 1980 Feet From West Line
 County Eddy G. L. Elevation Later Dedicated Acreage 40 Acres
 Name of Producing Formation Abbo Pool Empire Abbo

1. Is the Operator the only owner* in the dedicated acreage outlined on the plat below?
 Yes _____ No _____
2. If the answer to question one is "no", have the interests of all the owners been consolidated by communitization agreement or otherwise? Yes L No _____ If answer is "yes," Type of Consolidation Unitization
3. If the answer to question two is "no," list all the owners and thier respective interests below:

OwnerLand Description

SEP 21 1961

Section B

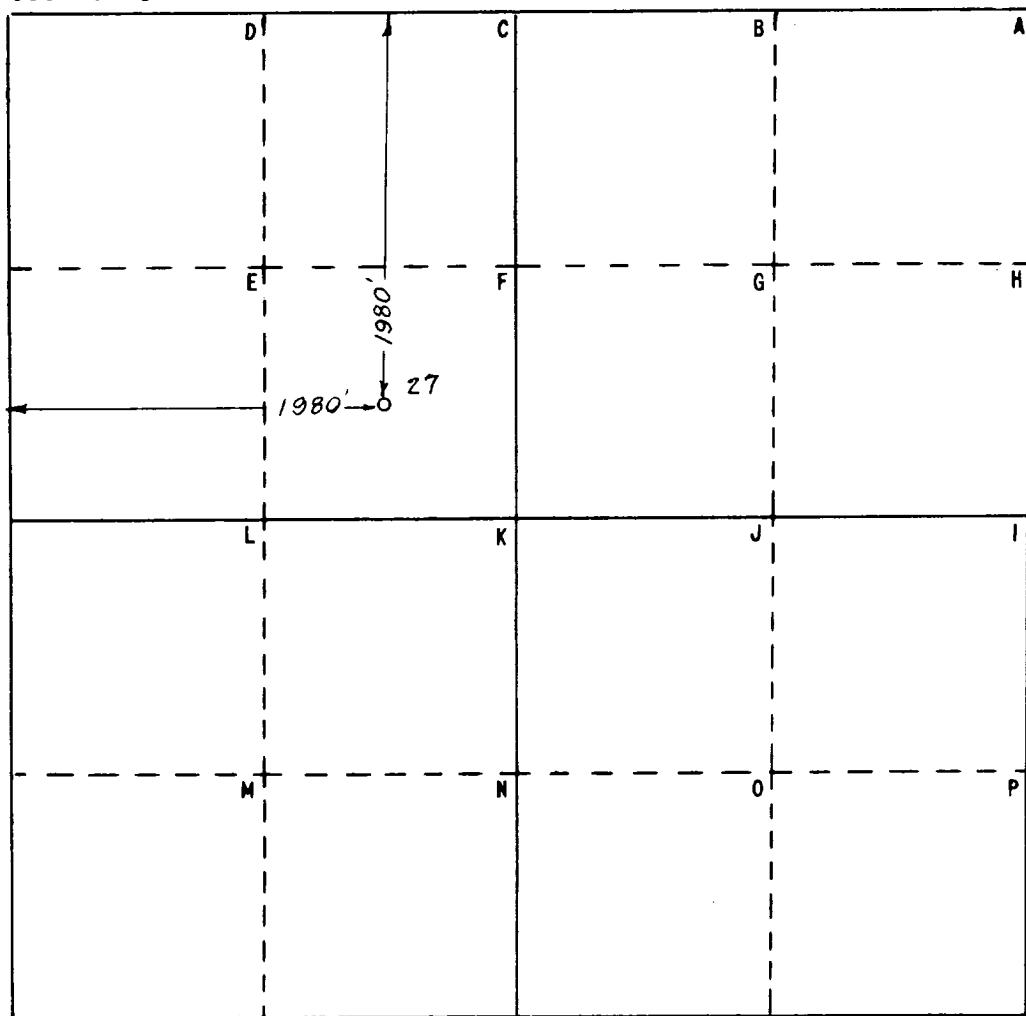

This is to certify that the information in Section A above is true and complete to the best of my knowledge and belief

HUMBLE OIL & REFG. CO.

(Operator)

Henry P. Meador
 (Representative)

Box 1600 Midland, Texas
 Address

This is to certify that the well location shown on the plat in Section B was plotted from field notes of actual surveys made by me or under my supervision and that the same is true and correct to the best of my knowledge and belief.

Date Surveyed 9-20-61

H. S. Hesterfield
 Registered Professional
 Engineer and/or Land Surveyor

Certificate No. 1382

0 330 660 990 1320 1650 1980 2310 2640 2000 1500 1000 500 0

FILE NO. W-A-2814