

NEW MEXICO
OIL CONSERVATION COMMISSION

Form C-128

Well Location and/or Gas Proration Plat

Operator L.N. Marbury Lease Eddy State Date March 8th 1957
Well No. 2 Section 17 Township 18S Range 28E NMPM
Located 330 Feet From North Line, 2310 Feet From East Line,
Eddy County, New Mexico. G. L. Elevation _____
Name of Producing Formation _____ Pool _____ Dedicated Acreage _____

(Note: All distances must be from outer boundaries of Section)

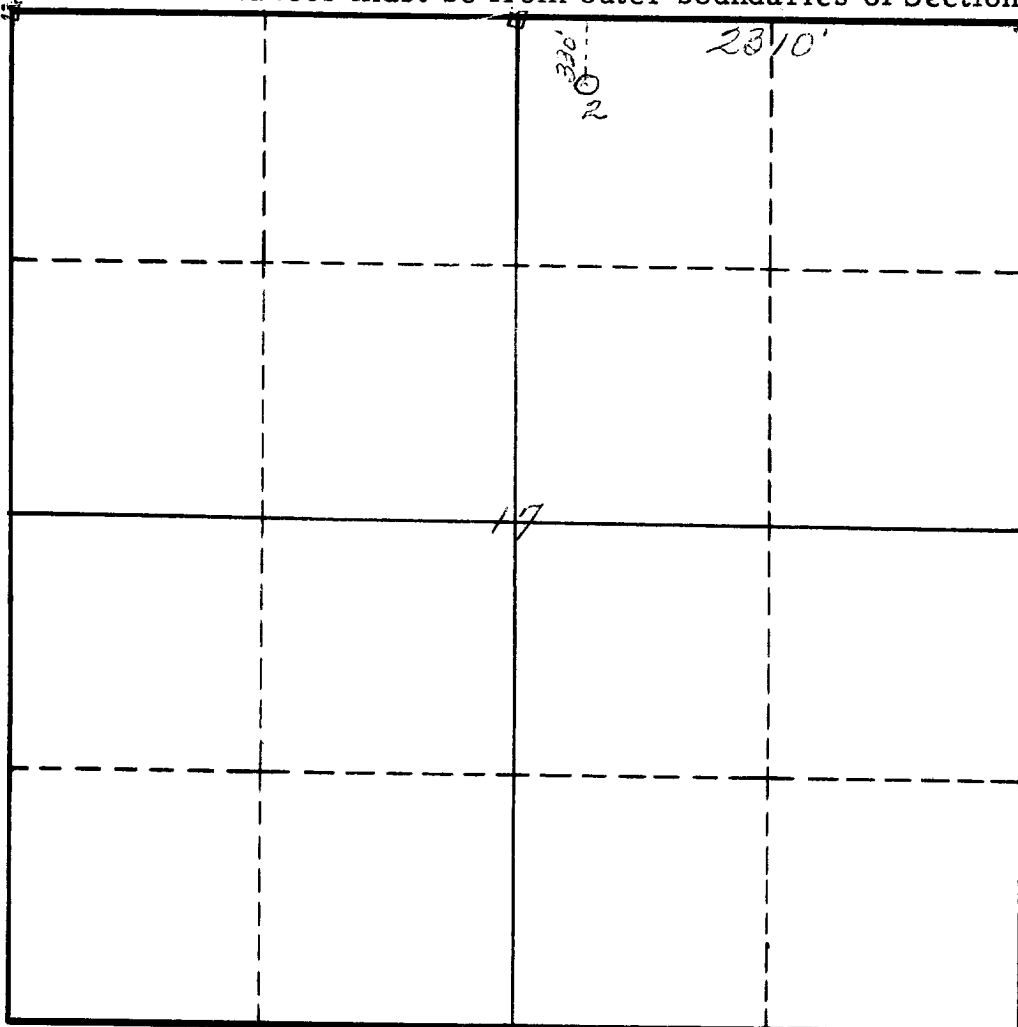

NOTE

This section of
form is to be
used for gas
wells only.



SCALE: 1"=1000'

1. Is this Well a Dual Comp.? Yes ___ No ___.
2. If the answer to Question 1 is yes, are there any other dually completed wells within the dedicated acreage? Yes ___ No ___.

This is to certify that the above plat was prepared from field notes of actual surveys made by me or under my supervision and that the same are true and correct to the best of my knowledge and belief.

Name _____
Position _____
Representing _____
Address _____

Date Surveyed March 8th 1957
James H. Brown, N.M.S. #542
Registered Professional Engineer and/or
Land Surveyor

1. Handwritten text
2. Handwritten text
3. Handwritten text

6

2