

NEW MEXICO  
OIL CONSERVATION COMMISSION

Form C-128

Well Location and/or Gas Proration Plat

Date November 2, 1956

Operator Ralph Nix & Jerry Curtis

Lease Gulf State "B"

Well No. 1 Section 18 Township 18 Range 28 NMPM

Located 330 Feet From South Line, 330 Feet From East Line,

Eddy

County, New Mexico. G. L. Elevation \_\_\_\_\_

Name of Producing Formation Grayburg-San Andres Pool Artesia Dedicated Acreage 40

(Note: All distances must be from outer boundaries of Section)

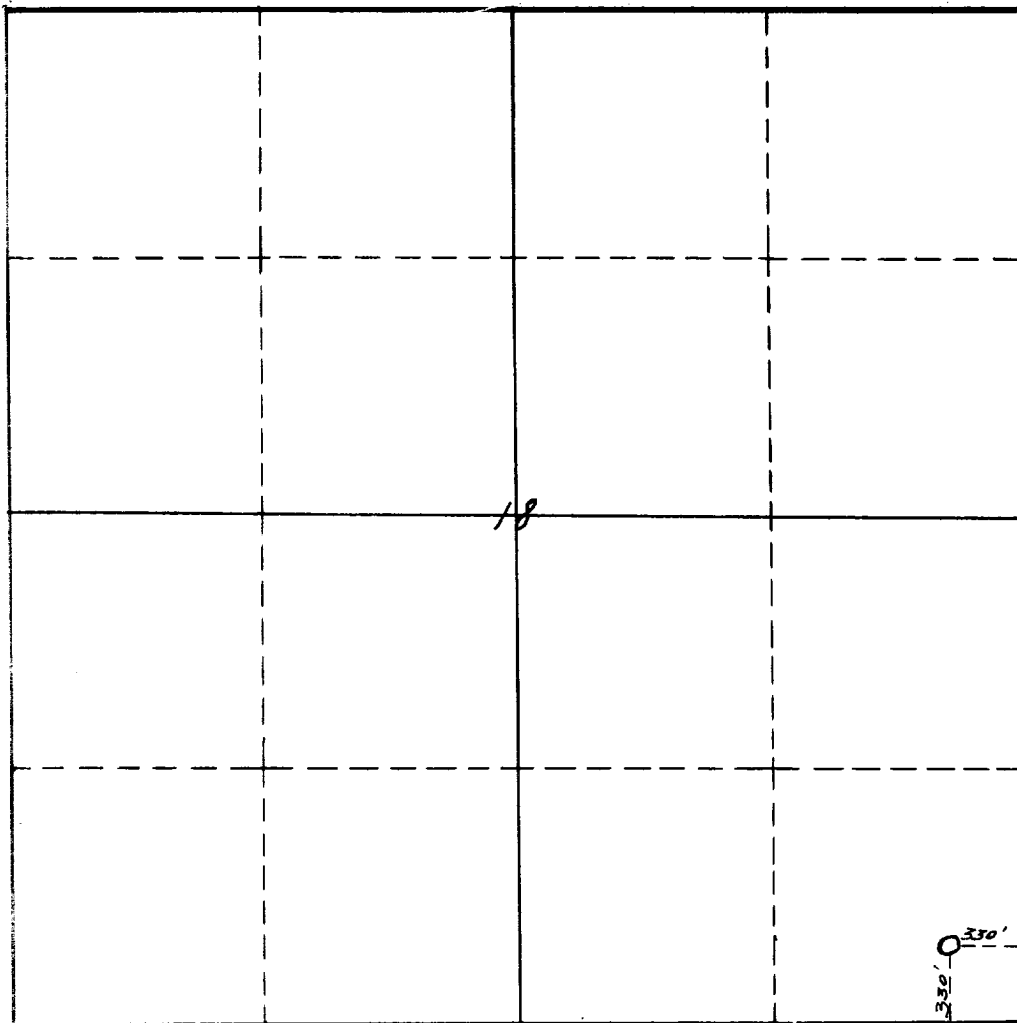

SCALE: 1"=1000'

1. Is this Well a Dual Comp.? Yes \_\_\_ No \_\_\_.

2. If the answer to Question 1 is yes, are there any other dually completed wells within the dedicated acreage? Yes \_\_\_ No \_\_\_.

This is to certify that the above plat was prepared from field notes of actual surveys made by me or under my supervision and that the same are true and correct to the best of my knowledge and belief.

Name \_\_\_\_\_  
Position \_\_\_\_\_  
Representing \_\_\_\_\_  
Address \_\_\_\_\_

Date Surveyed November 2, 1956

W. L. Hildner  
Registered Professional Engineer and/or  
Land Surveyor