

NEW MEXICO OIL CONSERVATION COMMISSION
Santa Fe, New Mexico

Form O-101
Revised (12/1/55)

RE
NOTICE OF INTENTION TO DRILL

Notice must be given to the District Office of the Oil Conservation Commission and approval obtained before drilling or recompletion begins. If changes in the proposed plan are considered advisable, a copy of this notice showing such changes will be returned to the sender. Submit this notice in QUINTUPLICATE. One copy will be returned following approval. See additional instructions in Rules and Regulations of the Commission. If State Land submit 6 Copies Attach Form O-128 in triplicate to first 3 copies of form O-101

Breckenridge, Texas
(Place)

July 31, 1959
(Date)

OIL CONSERVATION COMMISSION
SANTA FE, NEW MEXICO

Gentlemen:

You are hereby notified that it is our intention to commence the Drilling of a well to be known as
Granridge Corporation

(Company or Operator)

Lackawana State
(Lease)

Well No. 1-A, in J The well is

located 1573 feet from the South line and 1573 feet from the East line of Section 21, T. 18S, R. 28E, NMPM.

(GIVE LOCATION FROM SECTION LINE)

Artesia Pool, Eddy County

If State Land the Oil and Gas Lease is No. 647

If patented land the owner is

Address

We propose to drill well with drilling equipment as follows: Clean out abandoned well and complete as water injection well.

The status of plugging bond is \$10,000 Fidelity & Casualty Company of New York covering drilling & plugging for State of New Mexico

Drilling Contractor (will advise later)

We intend to complete this well in the 1st Grayburg formation at an approximate depth of 2050 to 2100 feet.

CASING PROGRAM

We propose to use the following strings of Casing and to cement them as indicated:

Size of Hole	Size of Casing	Weight per Foot	New or Second Hand	Depth	Sacks Cement
	8 5/8"	28#	second hand	300	200
	4 1/2"	9.50#	New	2100	150

If changes in the above plans become advisable we will notify you immediately.

ADDITIONAL INFORMATION (If recompletion give full details of proposed plan of work.)

Well was originally drilled by V.S. Welch. We propose to re-enter abandoned well with cable tools and clean out to total depth. This well will be used as a water injection well for water flood operations. Approval to re-drill this unorthodox location was granted by New Mexico Oil Conservation Commission Order No. R-966-E.

AUG 4 1959

Approved Except as follows: , 19

Sincerely yours,

Granridge Corporation
(Company or Operator)
By Charles W. Smith
(Charles W. Smith)
Position Production Clerk
Send Communications regarding well to
Name Granridge Corporation
Address P. O. Box 752, Breckenridge, Texas

OIL CONSERVATION COMMISSION

By M L Armstrong

NEW MEXICO OIL CONSERVATION COMMISSION

Well Location and Acreage Dedication Plat

Section A.

Date May 14, 1959

Operator GRARIDGE CORPORATION Lease LACKAWANA STATE
Well No. 1-A Unit Letter J Section 21 Township 18 South Range 28 East NMPM
Located 1573 Feet From South Line, 1573 Feet From East Line
County Eddy G. L. Elevation 3577 Dedicated Acreage _____ Acres
Name of Producing Formation 1st Grayburg Pool Artesia

1. Is the Operator the only owner* in the dedicated acreage outlined on the plat below?
Yes X No _____.
2. If the answer to question one is "no," have the interests of all the owners been consolidated by communitization agreement or otherwise? Yes _____ No _____. If answer is "yes," Type of Consolidation _____
3. If the answer to question two is "no," list all the owners and their respective interests below:

Owner

Land Description

Section B

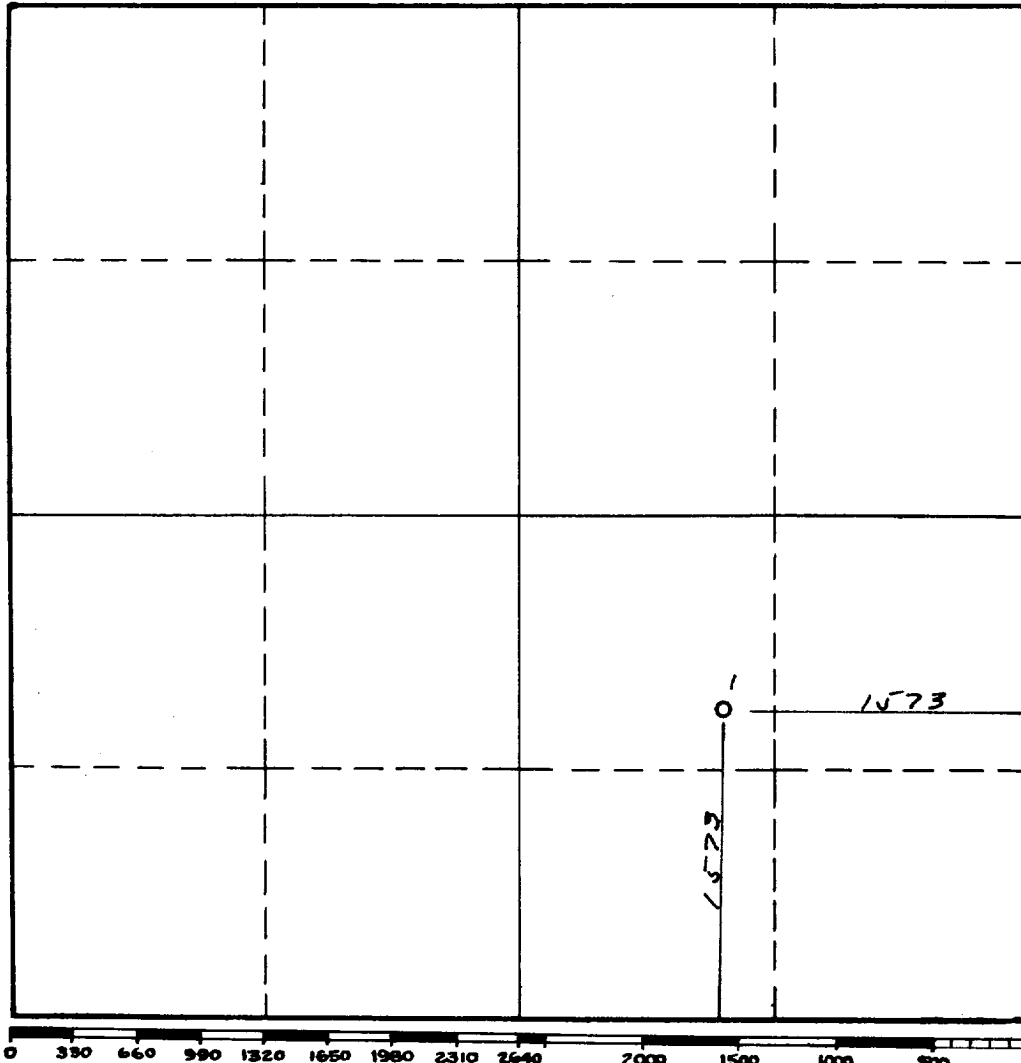

This is to certify that the information in Section A above is true and complete to the best of my knowledge and belief.

GRARIDGE CORPORATION
(Operator)
Charles M. Smith
(Representative)
Breckenridge, Texas
Address

This is to certify that the well location shown on the plat in Section B was plotted from field notes of actual surveys made by me or under my supervision and that the same is true and correct to the best of my knowledge and belief.

Date Surveyed May 14, 1959
John A. Mathis Jr.
Registered Professional
Engineer and/or Land Surveyor.

Certificate No. 1502

(See instructions for completing this form on the reverse side)

INSTRUCTIONS FOR COMPLETION

1. Operator shall furnish and certify to the information called for in Section A.
2. Operator shall outline the dedicated acreage for both oil and gas wells on the plat in Section B.
3. A registered professional engineer or land surveyor registered in the State of New Mexico or approved by the Commission shall show on the plat the location of the well and certify this information in the space provided.
4. All distances shown on the plat must be from the outer boundaries of Section.
5. If additional space is needed for listing owners and their respective interests as required in question 3, Section A, please use space below

OIL CONSERVATION COMMISSION	
ARTESIA DISTRICT OFFICE	
No. Copies Received	4
DISTRIBUTION	
	COPIES FURNISHED
OPERATOR	1
SANTA FE	1
PROVATION OFFICE	
STATE LAND OFFICE	1
U. S. G. S.	2
TRANSPORTER	
FILE	1
BUREAU OF MINES	

* "Owner" means the person who has the right to drill into and to produce from any pool and to appropriate the production either for himself or for himself and another. (65-3-29 (e) NMSA 1953 Comp.)