

NEW MEXICO OIL CONSERVATION COMMISSION  
Santa Fe, New Mexico

NOTICE OF INTENTION TO DRILL OR RECOMPLETE

Notice must be given to the District Office of the Oil Conservation Commission and approval obtained before drilling or recompletion begins. If changes in the proposed plan are considered advisable, a copy of this notice showing such changes will be returned to the sender. Submit this notice in QUINTUPPLICATE. One copy will be returned following approval. See additional instructions in Rules and Regulations of the Commission.

Artesia, New Mexico  
(Place)

January 27, 1956  
(Date)

OIL CONSERVATION COMMISSION  
SANTA FE, NEW MEXICO

Gentlemen:

You are hereby notified that it is our intention to commence the (Drilling) (~~Recompletion~~) of a well to be known as

Kincaid & Watson

(Company or Operator)

Magnolia State  
(Lease)

Well No. 2, in E (Unit) The well is

located 330 feet from the West line and 1650 feet from the

North line of Section 24, T. 18 S, R. 28 E, NMPM.

(GIVE LOCATION FROM SECTION LINE) Artesia Pool, Eddy County

If State Land the Oil and Gas Lease is No. B 11276

If patented land the owner is

Address

We propose to drill well with drilling equipment as follows:

Cable tools to total depth

The status of plugging bond is Blanket bond of

Kincaid & Watson

Drilling Contractor Kincaid & Watson Drilling Co.

We intend to complete this well in the San Andres

formation at an approximate depth of 2375 feet.

CASING PROGRAM

We propose to use the following strings of Casing and to cement them as indicated:

Size of Hole	Size of Casing	Weight per Foot	New or Second Hand	Depth	Sacks Cement
<u>10 "</u>	<u>8 5/8 "</u>	<u>28 #</u>	<u>S R</u>	<u>300</u>	<u>50</u>
<u>7 "</u>	<u>5 1/2 "</u>	<u>15.5 #</u>	<u>New</u>	<u>2900</u>	<u>100</u>

If changes in the above plans become advisable we will notify you immediately.

ADDITIONAL INFORMATION (If recompletion give full details of proposed plan of work.)

Elevation - 3513

Approved \_\_\_\_\_, 19\_\_\_\_\_  
Except as follows:

OIL CONSERVATION COMMISSION

By P. A. Johnson

Title \_\_\_\_\_

Sincerely yours,

Kincaid & Watson

(Company or Operator)

By E. R. Holmes

Agent

Position \_\_\_\_\_ Send Communications regarding well to

Name Same

Address Box 536

Artesia, New Mexico

NEW MEXICO  
OIL CONSERVATION COMMISSION

Form C-128

Well Location and/or Gas Proration Plat

Date \_\_\_\_\_

Operator Kineaid & Watson Lease Maguelia State

Well No 2 Section 24 Township 18S Range 28E NMPM

Located 1650' Feet From North Line, 330' Feet From West Line,

Eddy County, New Mexico. G. L. Elevation 3513

Name of Producing Formation \_\_\_\_\_ Pool \_\_\_\_\_ Dedicated Acreage \_\_\_\_\_

(Note: All distances must be from outer boundaries of Section)

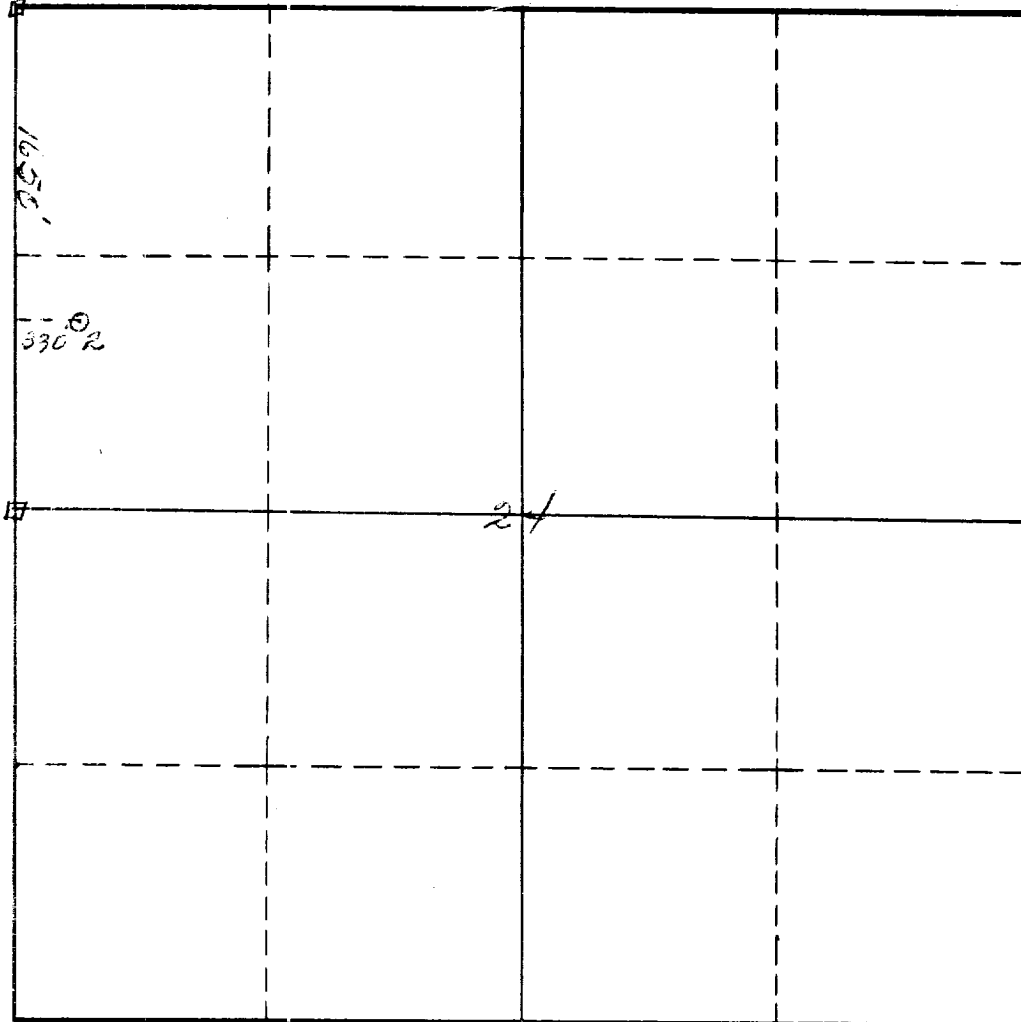

SCALE: 1"=1000'

1. Is this Well a Dual Comp. ? Yes \_\_\_ No \_\_\_.

2. If the answer to Question 1 is yes, are there any other dually completed wells within the dedicated acreage? Yes \_\_\_ No \_\_\_.

This is to certify that the above plat was prepared from field notes of actual surveys made by me or under my supervision and that the same are true and correct to the best of my knowledge and belief.

Name \_\_\_\_\_  
Position \_\_\_\_\_  
Representing \_\_\_\_\_  
Address \_\_\_\_\_

Date Surveyed January 24<sup>th</sup> 1956  
James A. Brown N.M.S. #542  
Registered Professional Engineer and/or  
Land Surveyor