

NEW MEXICO OIL CONSERVATION COMMISSION
Santa Fe, New Mexico

Form C-101
Revised (12/1/55)

NOTICE OF INTENTION TO DRILL

Notice must be given to the District Office of the Oil Conservation Commission and approval obtained before drilling or recompletion begins. If changes in the proposed plan are considered advisable, a copy of this notice showing such changes will be returned to the sender. Submit this notice in QUINTUPLICATE. One copy will be returned following approval. See additional instructions in Rules and Regulations of the Commission. If State Land submit 6 Copies Attach Form C-128 in triplicate to first 3 copies of form C-101

Well No. 1000

March 1, 1956

(Place)

(Date)

OIL CONSERVATION COMMISSION
SANTA FE, NEW MEXICO

Gentlemen:

You are hereby notified that it is our intention to commence the Drilling of a well to be known as

Well No. 1000

(Company, or Operator)

Well No. 1000

, Well No. 1000, in (Unit) The well is

(Lease)

located 2000 feet from the line and 1000 feet from the

line of Section 20, T. 10N, R. 20E, NMPM.

(GIVE LOCATION FROM SECTION LINE) Artesia Pool, El Paso County

If State Land the Oil and Gas Lease is No. 1000

If patented land the owner is

Address

We propose to drill well with drilling equipment as follows: Drill with rotary

The status of plugging bond is \$10,000.00, payable to the State of New Mexico, covering drilling and plugging for State of New Mexico

Drilling Contractor

We intend to complete this well in the 1000 formation at an approximate depth of 1000 - 1100 feet.

CASING PROGRAM

We propose to use the following strings of Casing and to cement them as indicated:

Size of Hole	Size of Casing	Weight per Foot	New or Second Hand	Depth	Sacks Cement
10 3/4"	8 5/8"	21.5	100	300'	200
7 1/2"	6 1/2"	19.5	100	200'	100

If changes in the above plans become advisable we will notify you immediately.

ADDITIONAL INFORMATION (If recompletion give full details of proposed plan of work.)

This well is to be drilled and cased as a water injection well for waterflood operations in this area. Drilling and casing to be completed by March 1, 1956.

Approved, 19_____
Except as follows:

OIL CONSERVATION COMMISSION

By M. L. Munson

Sincerely yours,

By T. A. Ford
Position, Manager of Production
Name, T. A. Ford
Address, Houston, Texas

NEW MEXICO OIL CONSERVATION COMMISSION
Well Location and Acreage Dedication Plat

March 6, 1959

Section A.

Date ~~XXXXXXXXXXXXXX~~

Graridge Corporation

Operator ~~XXXXXXXXXXXXXX~~ Lease ~~XXXXXXXXXXXXXX~~
Well No. ~~XXXX~~ Unit Letter ~~XXXX~~ Section ~~XXXX~~ Township ~~XXXX~~ Range ~~XXXX~~ NMPM
Located ~~XXXX~~ Feet From ~~XXXX~~ Line, ~~XXXX~~ Feet From ~~XXXX~~ Line
County ~~XXXX~~ G. L. Elevation 3539 Dedicated Acreage ~~XXXX~~ Acres
Name of Producing Formation ~~XXXX~~ Pool ~~XXXX~~

1. Is the Operator the only owner* in the dedicated acreage outlined on the plat below?
Yes ~~XXXX~~ No ~~XXXX~~.
2. If the answer to question one is "no," have the interests of all the owners been consolidated by communitization agreement or otherwise? Yes ~~XXXX~~ No ~~XXXX~~. If answer is "yes," Type of Consolidation ~~XXXX~~
3. If the answer to question two is "no," list all the owners and their respective interests below:

Owner

Land Description

Section B

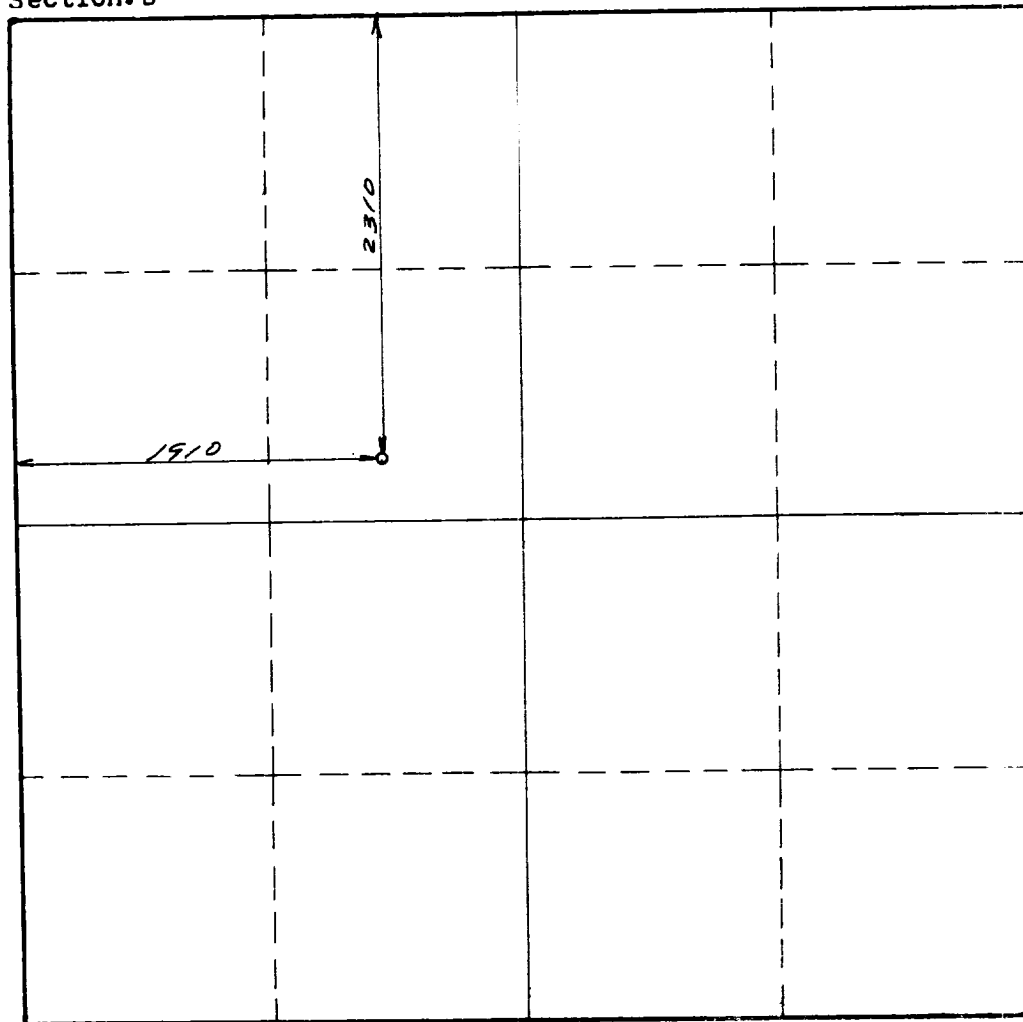

This is to certify that the information in Section A above is true and complete to the best of my knowledge and belief.

Graridge Corporation

~~XXXXXXXXXXXXXX~~

(Operator)

John Ford

(Representative)

~~XXXXXXXXXXXXXX~~

Address

This is to certify that the well location shown on the plat in Section B was plotted from field notes of actual surveys made by me or under my supervision and that the same is true and correct to the best of my knowledge and belief.

Date Surveyed 2/27/59

John A. Mathis Jr.
Registered Professional
Engineer and/or Land Surveyor.

Certificate No. 1502

INSTRUCTIONS FOR COMPLETION:

1. Operator shall furnish and certify to the information called for in Section A.
2. Operator shall outline the dedicated acreage for both oil and gas wells on the plat in Section B.
3. A registered professional engineer or land surveyor registered in the State of New Mexico or approved by the Commission shall show on the plat the location of the well and certify this information in the space provided.
4. All distances shown on the plat must be from the outer boundaries of Section.
5. If additional space is needed for listing owners and their respective interests as required in question 3, Section A, please use space below

* "Owner" means the person who has the right to drill into and to produce from any pool and to appropriate the production either for himself or for himself and another. (65-3-25 (e) NMSA 1953 Comp.)