

NEW MEXICO OIL CONSERVATION COMMISSION
Santa Fe, New Mexico

Form C-101
Revised (12/1/55)

NOTICE OF INTENTION TO DRILL

Notice must be given to the District Office of the Oil Conservation Commission and approval obtained before drilling or recompletion begins. If changes in the proposed plan are considered advisable, a copy of this notice showing such changes will be returned to the sender. Submit this notice in **QUINTUPPLICATE**. One copy will be returned following approval. See additional instructions in Rules and Regulations of the Commission.

If State Land submit 6 Copies Attach Form C- 128 in triplicate to first 3 copies of form C-101

Brackenridge, Texas

(Place)

May 25, 1959

(Date)

OIL CONSERVATION COMMISSION
SANTA FE, NEW MEXICO

Gentlemen:

You are hereby notified that it is our intention to commence the Drilling of a well to be known as

Graridge Corporation

(Company or Operator)

Realer Yates State

(Lease)

Well No. 363, in N The well is

located 330 feet from the South line and 1550 feet from the

West line of Section 22, T. 18S, R. 23E, NMPM.

(GIVE LOCATION FROM SECTION LINE) Artesia Pool, Bddy County

If State Land the Oil and Gas Lease is No. 647

If patented land the owner is

Address

We propose to drill well with drilling equipment as follows: 2100' with rotary equipment.

The status of plugging bond is \$10,000 Fidelity & Casualty Company of New York #1953517 covering drilling & plugging for State of New Mexico.

Drilling Contractor

(Will advise later)

We intend to complete this well in the 1st Grayburg

formation at an approximate depth of 2050' to 2100' feet.

CASING PROGRAM

We propose to use the following strings of Casing and to cement them as indicated:

| Size of Hole | Size of Casing | Weight per Foot | New or Second Hand | Depth | Sacks Cement |
|--------------|----------------|-----------------|--------------------|-------|--------------|
| 10-3/4" | 8-5/8" | 29# | New | 300 | 200 |
| 8-3/4" | 5-1/2" | 14# | New | 2100 | 100 |
| | | | | | |
| | | | | | |

If changes in the above plans become advisable we will notify you immediately.

ADDITIONAL INFORMATION (If recompletion give full details of proposed plan of work.)

JUN 1 1959

Approved....., 19.....
Except as follows:

OIL CONSERVATION COMMISSION

By *M. H. Smith*

Sincerely yours,

Graridge Corporation

(Company or Operator)

Charles W. Smith Charles W. Smith

Position: Production Clerk

Send Communications regarding well to

Name: Graridge Corporation

Address: Box 752, Brackenridge, Texas

OIL CONSERVATION COMMISSION

ANNESIA DISTRICT OFFICE

No. Copies Received *6*

DISTRIBUTION

| | COPIES FURNISHED | |
|-------------------|---------------------|----------|
| Operator | <i>1</i> | |
| Owner Fe | <i>1</i> | |
| Operation Office | | |
| State Land Office | <i>1</i> | |
| S. G. S. | <i>2</i> | |
| Transporter | | |
| File | <i>1</i> | <i>✓</i> |
| | | |

NEW MEXICO OIL CONSERVATION COMMISSION

Well Location and Acreage Dedication Plat

Section A.

Date May 19, 1959

Operator Granridge Corporation Lease Rosier Yates State
Well No. 348 Unit Letter N Section 29 Township 18S Range 28E NMPM
Located 330 Feet From South Line, 1650 Feet From WEST Line
County Eddy G. L. Elevation 3537 Dedicated Acreage _____ Acres
Name of Producing Formation 1st Grayburg Pool Artesia

1. Is the Operator the only owner* in the dedicated acreage outlined on the plat below?
Yes X No _____.
2. If the answer to question one is "no," have the interests of all the owners been consolidated by communitization agreement or otherwise? Yes _____ No _____. If answer is "yes," Type of Consolidation _____
3. If the answer to question two is "no," list all the owners and their respective interests below:

Owner

Land Description

Section B

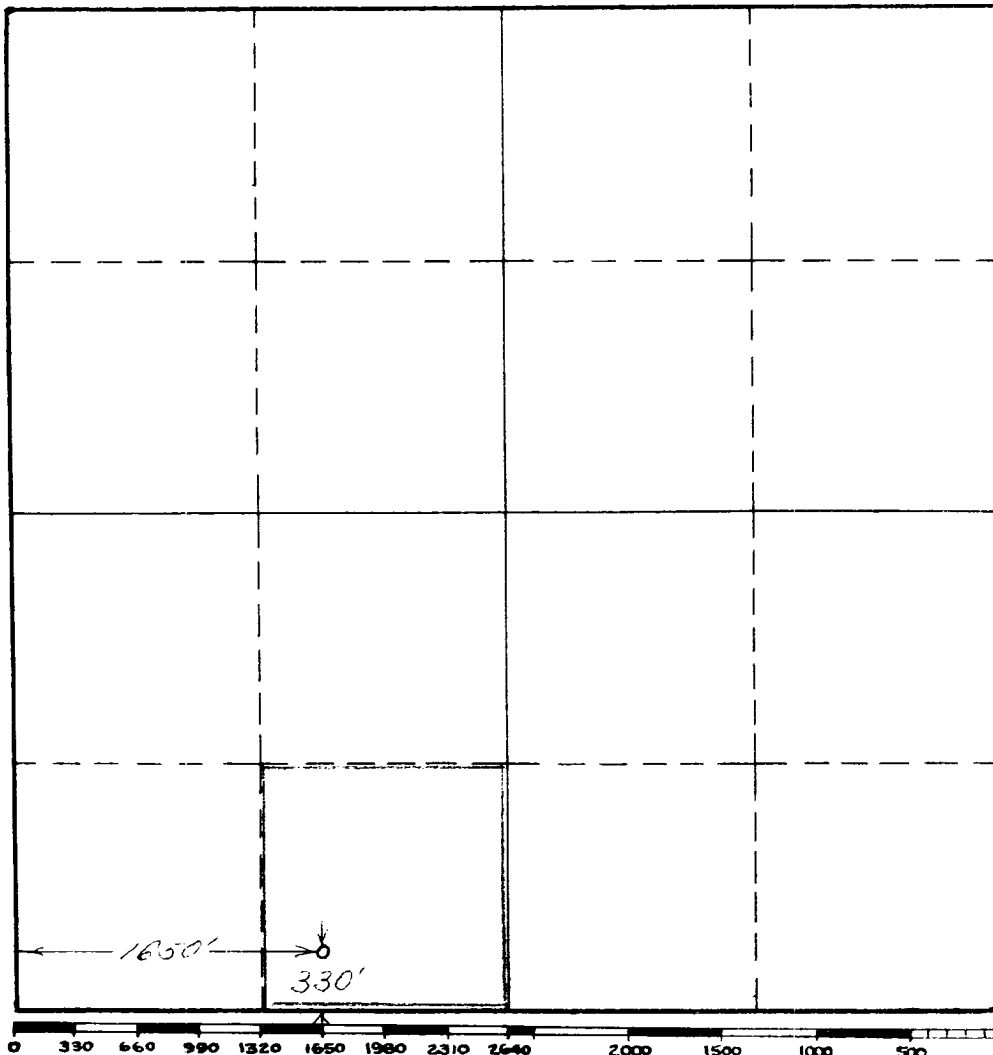

This is to certify that the information in Section A above is true and complete to the best of my knowledge and belief.

Granridge Corporation

(Operator)

Charles H. Smith
(Representative)

Breckenridge, Texas

Address

This is to certify that the well location shown on the plat in Section B was plotted from field notes of actual surveys made by me or under my supervision and that the same is true and correct to the best of my knowledge and belief.

Date Surveyed 5-23-59

W. P. Sheldon
Registered Professional
Engineer and/or Land Surveyor.

Certificate No. 963

INSTRUCTIONS FOR COMPLETION:

1. Operator shall furnish and certify to the information called for in Section A.
2. Operator shall outline the dedicated acreage for both oil and gas wells on the plat in Section B.
3. A registered professional engineer or land surveyor registered in the State of New Mexico or approved by the Commission shall show on the plat the location of the well and certify this information in the space provided.
4. All distances shown on the plat must be from the outer boundaries of Section.
5. If additional space is needed for listing owners and their respective interests as required in question 3, Section A, please use space below

* "Owner" means the person who has the right to drill into and to produce from any pool and to appropriate the production either for himself or for himself and another. (65-3-23 (e) NMSA 1953 Comp.)