

NUMBER OF COPIES RECEIVED 6	
DISTRIBUTION	
SANTA FE	1
FILE	5
U.S.G.S.	2
LAND OFFICE	
TRANSPORTER	
OIL	
GAS	
PRODUCTION OFFICE	
OPERATOR	1

NEW MEXICO OIL CONSERVATION COMMISSION
Santa Fe, New Mexico

NOTICE OF INTENTION TO DRILL

Notice must be given to the District Office of the Oil Conservation Commission and approval obtained before drilling or recompletion begins. If changes in the proposed plan are considered advisable, a copy of this notice showing such changes will be returned to the sender. Submit this notice in QUINTUPPLICATE. One copy will be returned following approval. See additional instructions in Rules and Regulations of the Commission. If State Land submit 6 Copies. Attach Form C-128 in triplicate to first 3 copies of Form C-101.

RECEIVED

Artesia, New Mexico

September 11, 1964

(Place)

SEP 14 1964

(Date)

OIL CONSERVATION COMMISSION
SANTA FE, NEW MEXICO

O. C. C.
ARTESIA, OFFICE

Gentlemen:

You are hereby notified that it is our intention to commence the Drilling of a well to be known as
Kersey & Company

(Company or Operator)

Yates, Well No. **6**, in **F** The well is
(Lease) located **2310** feet from the **North** line and **2310** feet from the
West line of Section **33**, T **18S**, R **28E**, NMPM.

(GIVE LOCATION FROM SECTION LINE)

Artesia Pool, **Eddy** County
694

D	C	B	A
E	F	G	H
L	K	J	I
M	N	O	P

If State Land the Oil and Gas Lease is No. _____

If patented land the owner is _____

Address _____

We propose to drill well with drilling equipment as follows:
#55 Wichita Spudder

The status of plugging bond is **Blanket**

Drilling Contractor **Kersey & Company**

We intend to complete this well in the **Grayburg**
formation at an approximate depth of **2800'** feet.

CASING PROGRAM

We propose to use the following strings of Casing and to cement them as indicated:

Size of Hole	Size of Casing	Weight per Foot	New or Second Hand	Depth	Sacks Cement

If changes in the above plans become advisable we will notify you immediately.

ADDITIONAL INFORMATION (If recompletion give full details of proposed plan of work.)

Plan to run surface casing to 500' and clean out old hole to T.D. of 2800'. Will either run 3 1/2" or 4 1/2" and tie in to old 6 5/8" or 7" casing at depth where cut off. Plan to cement 3 1/2" or 4 1/2" back to surface - in case this plan is to be followed will not cement 7" casing but remove it prior to cementing 3 1/2" or 4 1/2".

Approved **SEP 14 1964**, 19____
Except as follows:

Sincerely yours,

KERSEY & COMPANY

(Company or Operator)

By **Harold Kersey**

Position **Owner**

Send Communications regarding well to

Name **Kersey & Company**

Address **P. O. Box 316, Artesia, New Mexico**

OIL CONSERVATION COMMISSION

By

NUMBER OF COPIES RECEIVED 6	
DISTRIBUTION	
SANTA FE	
FILE	1-
U.S.G.S.	3
LAND OFFICE	
TRANSPORTER	
OIL	
GAS	
PRODUCTION OFFICE	
OPERATOR	1

NEW MEXICO OIL CONSERVATION COMMISSION
WELL LOCATION AND ACREAGE DEDICATION PLAT
 SEE INSTRUCTIONS FOR COMPLETING THIS FORM ON THE REVERSE SIDE

FORM C-128
 Revised 5/1/57

SECTION A

Operator Kersey & Company			Lease Yates		Well No. 6
Unit Letter F	Section 33	Township 18S	Range 28E	County Eddy	
Actual Footage Location of Well: 2310 feet from the North line and 2310 feet from the West line					
Ground Level Elev. 3545	Producing Formation Grayburg		Pool Artesia		Dedicated Acreage: 40 Acres

1. Is the Operator the only owner in the dedicated acreage outlined on the plat below? YES V NO ____ . ("Owner" means the person who has the right to drill into and to produce from any pool and to appropriate the production either for himself or for himself and another. (65-3-29 (e) NMSA 1935 Comp.)
2. If the answer to question one is "no," have the interests of all the owners been consolidated by communitization agreement or otherwise? YES ____ NO ____ . If answer is "yes," Type of Consolidation **RECEIVED**
3. If the answer to question two is "no," list all the owners and their respective interests below:

Owner	Land Description SEP 14 1964
	O. C. C.
	ARTESIA, OFFICE

SECTION B

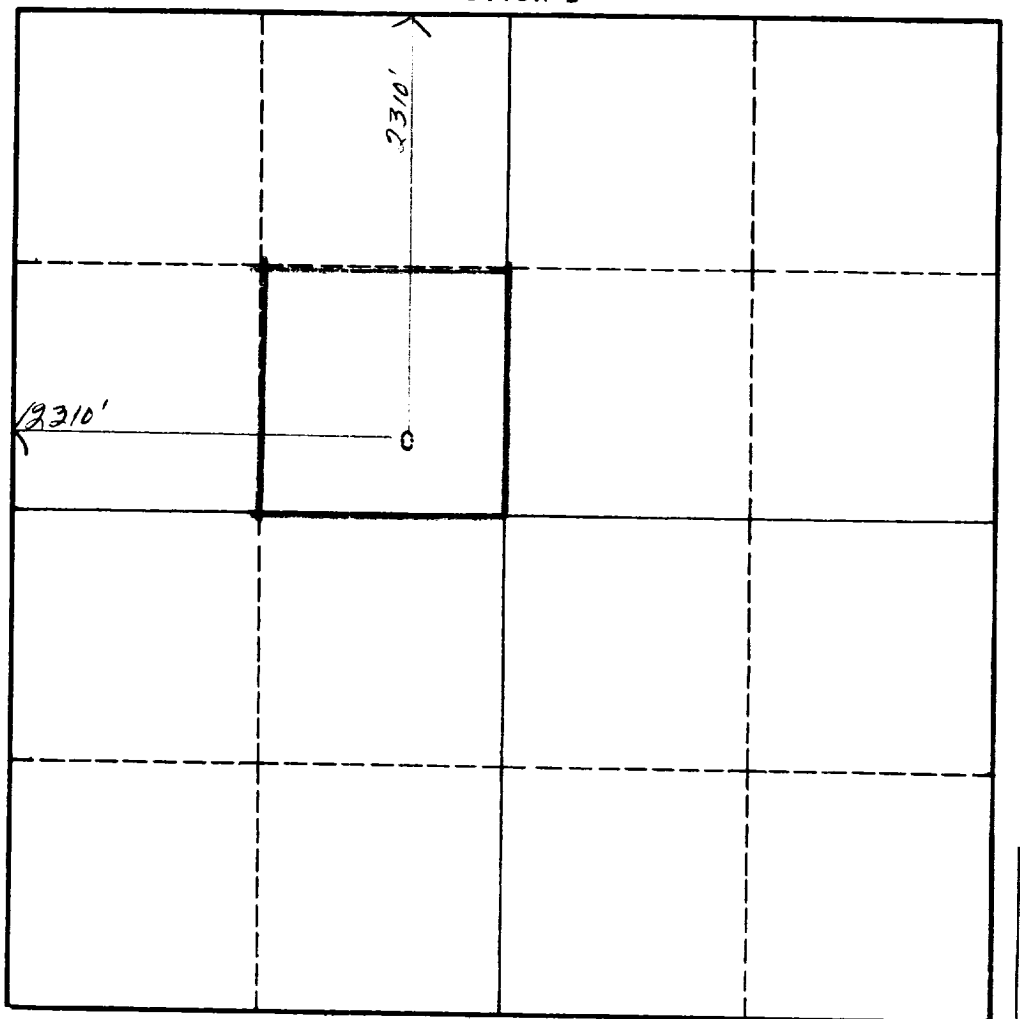

CERTIFICATION

I hereby certify that the information in SECTION A above is true and complete to the best of my knowledge and belief.

Name	Harold Kersey
Position	Owner
Company	Kersey & Company
Date	September 11, 1964

I hereby certify that the well location shown on the plat in SECTION B was plotted from field notes of actual surveys made by me or under my supervision, and that the same is true and correct to the best of my knowledge and belief.

Date Surveyed	Sept. 10, 1964
Registered Professional Engineer and/or Land Surveyor	Harold Kersey
Certificate No.	802

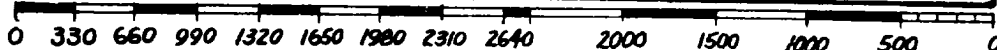

INSTRUCTIONS FOR COMPLETION OF FORM C-128

1. Operator shall furnish and certify to the information called for in Section A.
2. Operator shall outline the dedicated acreage for *both* oil and gas wells on the plat in Section B.
3. A registered professional engineer or land surveyor registered in the State of New Mexico or approved by the Commission shall show on the plat the location of the well and certify this information in the space provided.
4. All distances shown on the plat must be from the outer boundaries of the Section.
5. If additional space is needed for listing owners and their respective interests as required in question 3 of Section A, please use space below.