

NEW MEXICO OIL CONSERVATION COMMISSION
Santa Fe, New Mexico

Form C-101
Revised 12/1/55
RECEIVED

JUL 10 1961

NOTICE OF INTENTION TO DRILL

Notice must be given to the District Office of the Oil Conservation Commission and approval obtained before drilling or completion begins. If changes in the proposed plan are considered advisable, a copy of this notice showing such changes will be returned to the sender. Submit this notice in QUINTUPPLICATE. One copy will be returned following approval. See additional instructions in Rules and Regulations of the Commission. If State Land submit 6 Copies Attach Form C- 128 in triplicate to first 3 copies of form C-101

Artesia, New Mexico

July 6, 1961

(Place)

(Date)

OIL CONSERVATION COMMISSION
SANTA FE, NEW MEXICO

Gentlemen:

You are hereby notified that it is our intention to commence the Drilling of a well to be known as

McCoy & Stevens

(Company or Operator)

Ohio State

(Lease)

Well No. 1, in E The well is

(Unit)

located 1980 feet from the North line and 660 feet from the

West line of Section 36, T. 18S, R. 28E, NMPM.

(GIVE LOCATION FROM SECTION LINE) Undesignated Pool, Eddy County

If State Land the Oil and Gas Lease is No. 182

If patented land the owner is

Address

We propose to drill well with drilling equipment as follows: Cable Tools

The status of plugging bond is Blanket Bond of
McCoy & Stevens

Drilling Contractor Kincaid & Watson Drilling Company
P.O. Box 498, Artesia, New Mexico

We intend to complete this well in the San Andres
formation at an approximate depth of 3000 feet.

CASING PROGRAM

We propose to use the following strings of Casing and to cement them as indicated:

| Size of Hole | Size of Casing | Weight per Foot | New or Second Hand | Depth | Sacks Cement |
|--------------|----------------|-----------------|--------------------|-------|--------------|
| 11" | 8 5/8" | 24 | Used | 450' | 50 |
| 7" | 5 1/2" | 14 | New | 3000' | 100 |
| | | | | | |
| | | | | | |

If changes in the above plans become advisable we will notify you immediately.

ADDITIONAL INFORMATION (If recompletion give full details of proposed plan of work.)

Approved JUL 10 1961, 19.....
Except as follows:

OIL CONSERVATION COMMISSION

By M. L. Armstrong

Sincerely yours,

McCoy & Stevens

(Company or Operator)

By G. R. Holmes

Position Agent

Send Communications regarding well to

Name Kincaid & Watson Drilling Co.

Address Box 498, Artesia, New Mexico

OIL CONSERVATION COMMISSION
ARTESIA DISTRICT OFFICE

No. Copies Received

DISTRIBUTION

| | NO. FURNISHED | |
|-------------------|------------------|--|
| OPERATOR | | |
| SANTA FE | | |
| PRODUCTION OFFICE | | |
| STATE LAND OFFICE | | |
| U. S. G. S. | | |
| TRANSPORTER | | |
| FILE | | |
| BUREAU OF MINES | | |
| | | |

| | |
|---------------------------|------------|
| NUMBER OF COPIES RECEIVED | |
| DISTRIBUTION | |
| SANTA FE | |
| FILE | |
| U.S.G.S. | |
| LAND OFFICE | |
| TRANSPORTER | OIL GAS |
| PRODUCTION OFFICE | |
| OPERATOR | |

NEW MEXICO OIL CONSERVATION COMMISSION
WELL LOCATION AND ACREAGE DEDICATION PLAT
 SEE INSTRUCTIONS FOR COMPLETING THIS FORM ON THE REVERSE SIDE

FORM C-128
 Revised 5/1/56
RECEIVED
JUL 10 1961

SECTION A

| | | | | |
|---|--|-----------------------------|---------------------------------------|-----------------------|
| Operator McCoy & Stevens | | Lease Ohio-State | | Well No. 1 |
| Unit Letter E | Section 36 | Township 18 South | Range 28 East | County Eddy |
| Actual Footage Location of Well: 1980 feet from the North line and 660 feet from the West line | | | | |
| Ground Level Elev. 3427 | Producing Formation San Andres | Pool Undesignated | Dedicated Acreage: 40 Acres | |

1. Is the Operator the only owner in the dedicated acreage outlined on the plat below? YES yes NO ____ . ("Owner" means the person who has the right to drill into and to produce from any pool and to appropriate the production either for himself or for himself and another. (65-3-29 (e) NMSA 1935 Comp.)
2. If the answer to question one is "no," have the interests of all the owners been consolidated by communitization agreement or otherwise? YES ____ NO ____ . If answer is "yes," Type of Consolidation ____
3. If the answer to question two is "no," list all the owners and their respective interests below:

| Owner | Land Description |
|-------|------------------|
| | |
| | |

SECTION B

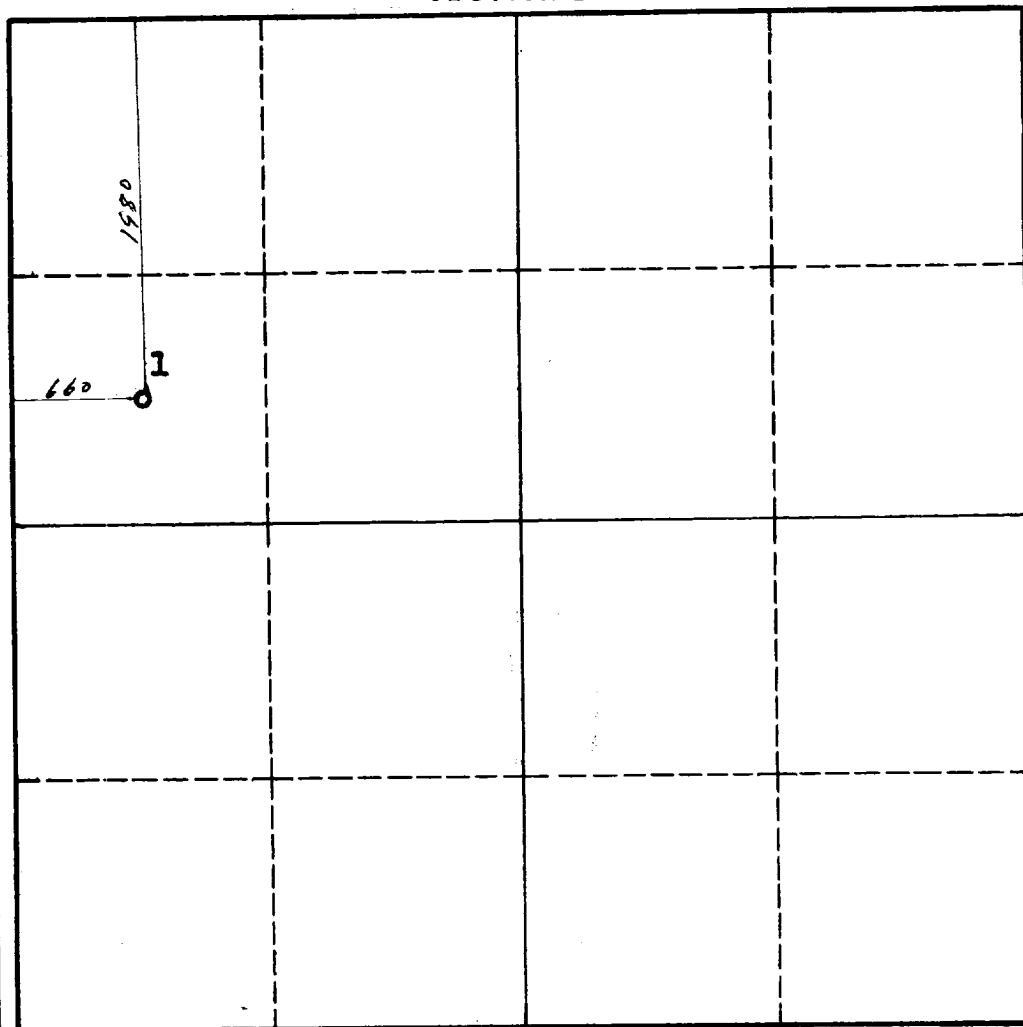

CERTIFICATION

I hereby certify that the information in SECTION A above is true and complete to the best of my knowledge and belief.

| |
|---------------------------------------|
| Name <i>Grey Holmer</i> |
| Position Agent |
| Company McCoy & Stevens |
| Date July 7, 1961 |

I hereby certify that the well location shown on the plat in SECTION B was plotted from field notes of actual surveys made by me or under my supervision, and that the same is true and correct to the best of my knowledge and belief.

| |
|--|
| Date Surveyed July 7, 1961 |
| Registered Professional Engineer and/or Land Surveyor <i>John A. Matanich</i> |
| Certificate No. 1502 |

0 330 660 990 1320 1650 1980 2310 2640 2000 1500 1000 500 0

INSTRUCTIONS FOR COMPLETION OF FORM C-128

1. Operator shall furnish and certify to the information called for in Section A.
2. Operator shall outline the dedicated acreage for *both* oil and gas wells on the plat in Section B.
3. A registered professional engineer or land surveyor registered in the State of New Mexico or approved by the Commission shall show on the plat the location of the well and certify this information in the space provided.
4. All distances shown on the plat must be from the outer boundaries of the Section.
5. If additional space is needed for listing owners and their respective interests as required in question 3 of Section A, please use space below.

| OIL CONSERVATION COMMISSION | | |
|-----------------------------|------------------|--|
| ARTESIA DISTRICT OFFICE | | |
| No. Copies Received | | |
| DISTRIBUTION | | |
| | NO. FURNISHED | |
| OPERATOR | 1 | |
| SANTA FE | 1 | |
| PROBATION OFFICE | | |
| STATE LAND OFFICE | 1 | |
| U. S. G. S. | 2 | |
| TRANSPORTER | | |
| FILE | 1 | |
| BUREAU OF MINES | | |

30-015-02171

(1) Melt-Radiactivity Log