

NEW MEXICO OIL CONSERVATION COMMISSION  
Santa Fe, New Mexico

Form C-101  
Revised (12/1/55)

NOTICE OF INTENTION TO DRILL

Notice must be given to the District Office of the Oil Conservation Commission and approval obtained before drilling or recompletion begins. If changes in the proposed plan are considered advisable, a copy of this notice showing such changes will be returned to the sender. Submit this notice in QUINTUPLICATE. One copy will be returned following approval. See additional instructions in Rules and Regulations of the Commission. If State Land submit 6 Copies Attach Form C- 128 in triplicate to first 3 copies of form C-101

Artesia, New Mexico  
(Place)

October 25, 1957  
(Date)

OIL CONSERVATION COMMISSION  
SANTA FE, NEW MEXICO

Gentlemen:

You are hereby notified that it is our intention to commence the Drilling of a well to be known as

L.N. Marbry

(Company or Operator)

Kelly State

(Lease)

Well No. 1, in 0 The well is  
(Unit)

located 330 feet from the South line and 2310 feet from the

East

line of Section 8, T. 18S, R. 28E, NMPM.

(GIVE LOCATION FROM SECTION LINE)

Artesia

Pool, Eddy County

703

If State Land the Oil and Gas Lease is No.

If patented land the owner is

Address

We propose to drill well with drilling equipment as follows: Cable Tools

The status of plugging bond is Blanket Bond

Drilling Contractor Donnelly Drilling Co., Inc.

We intend to complete this well in the Lovington  
formation at an approximate depth of 2500 feet.

CASING PROGRAM

We propose to use the following strings of Casing and to cement them as indicated:

Size of Hole	Size of Casing	Weight per Foot	New or Second Hand	Depth	Sacks Cement
10 3/4"	8 5/8"	24#	S.H.	515'	50
5 1/2"	8"	14#	New	2450'	100

If changes in the above plans become advisable we will notify you immediately.

ADDITIONAL INFORMATION (If recompletion give full details of proposed plan of work.)

OCT 28 1957

Approved \_\_\_\_\_, 19\_\_\_\_\_  
Except as follows:

OIL CONSERVATION COMMISSION

By M.L. Armstrong

Sincerely yours,

L.N. Marbry

(Company or Operator)

By

Position Contractor

Send Communications regarding well to

Name Donnelly Drilling Co., Inc.

Address Box 433, Artesia, New Mexico

OIL CONSERVATION COMMISSION		
ARTESIA DISTRICT OFFICE		
No. Copies Received		
DISTRIBUTION		
	PC	
	FURNISHED	
Operator		
Santa Fe		
Proration Office		
State Land Office		
U. S. G. S.		
Transporter		
File		

NEW MEXICO OIL CONSERVATION COMMISSION

Form O-28  
Revised 5/1/57

Well Location and Acreage Dedication Plat OCT 25 1957

Section A.

Date: October 26, 1957

ARTESIA OFFICE

Operator L.N. Marbry Lease Kelly State  
Well No. 1 Unit Letter O Section 8 Township 18S Range 28E NMPM  
Located 330 Feet From South Line, 2310 Feet From East Line  
County Eddy G. L. Elevation 3608 Dedicated Acreage 40 Acres  
Name of Producing Formation Lovington Pool Artesia

1. Is the Operator the only owner\* in the dedicated acreage outlined on the plat below?  
Yes X No       .
2. If the answer to question one is "no," have the interests of all the owners been consolidated by communitization agreement or otherwise? Yes        No       . If answer is "yes," Type of Consolidation
3. If the answer to question two is "no," list all the owners and their respective interests below:

Owner

Land Description

L.N. Marbry

SW SE Section 8, T18S, R28E

Section B

R28E

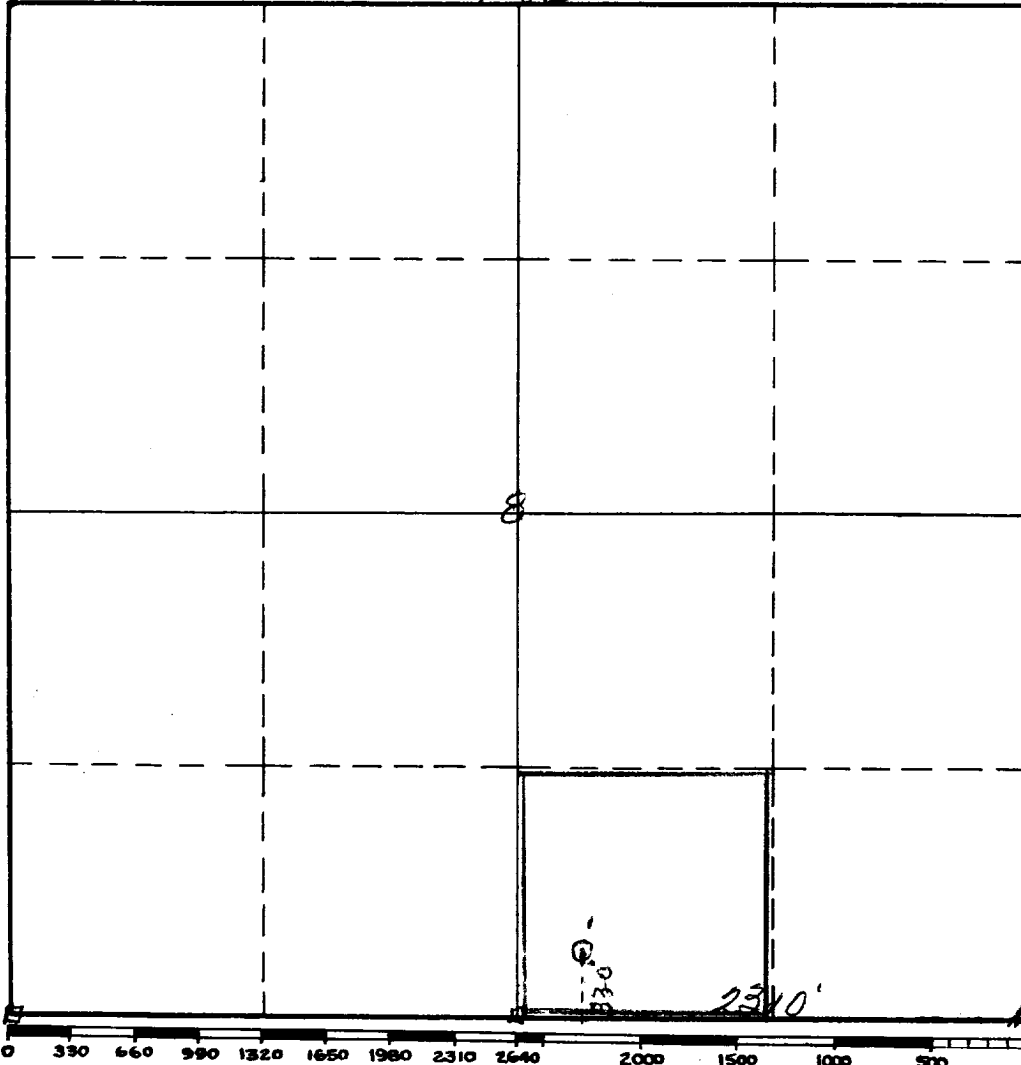

This is to certify that the information in Section A above is true and complete to the best of my knowledge and belief.

L.N. Marbry

(Operator)

T.H. Vannoy  
(Representative)

Box 433,  
Artesia, New Mexico

Address

This is to certify that the well location shown on the plat in Section B was plotted from field notes of actual surveys made by me or under my supervision and that the same is true and correct to the best of my knowledge and belief.

Date Surveyed October 26, 1957

James H. Brown  
Registered Professional  
Engineer and/or Land Surveyor.

Certificate No. 542

(See instructions for completing this form on the reverse side)

INSTRUCTIONS FOR COMPLETION:

1. Operator shall furnish and certify to the information called for in Section A.
2. Operator shall outline the dedicated acreage for both oil and gas wells on the plat in Section B.
3. A registered professional engineer or land surveyor registered in the State of New Mexico or approved by the Commission shall show on the plat the location of the well and certify this information in the space provided.
4. All distances shown on the plat must be from the outer boundaries of Section.
5. If additional space is needed for listing owners and their respective interests as required in question 3, Section A, please use space below

OIL CONSERVATION COMMISSION		
ARTESIA DISTRICT OFFICE		
No. Copies Received <u>6</u>		
DISTRIBUTION		
	COPIES FURNISHED	
Operator	<u>1</u>	
Santa Fe	<u>1</u>	
Production Office		
State Land Office	<u>1</u>	
U. S. C. S.	<u>2</u>	
Transporter		
File	<u>1</u>	<u>✓</u>

\* "Owner" means the person who has the right to drill into and to produce from any pool and to appropriate the production either for himself or for himself and another. (65-3-29 (e) NMSA 1953 Comp.)