

NEW MEXICO OIL CONSERVATION COMMISSION
Santa Fe, New Mexico

Form C-101
Revised (12/1/55)

NOTICE OF INTENTION TO DRILL

Notice must be given to the District Office of the Oil Conservation Commission and approval obtained before drilling or recompletion begins. If changes in the proposed plan are considered advisable, a copy of this notice showing such changes will be returned to the sender. Submit this notice in QUINTUPLICATE. One copy will be returned following approval. See additional instructions in Rules and Regulations of the Commission. If State Land submit 6 Copies Attach Form C-128 in triplicate to first 3 copies of form C-101 on all wells

Artesia, New Mexico

January 20, 1958

(Place)

(Date)

OIL CONSERVATION COMMISSION
SANTA FE, NEW MEXICO

Gentlemen:

You are hereby notified that it is our intention to commence the Drilling of a well to be known as
Roach and Shepard

(Company or Operator)

Humble State

(Lease)

, Well No. 2, in E (Unit) The well is

located 2310 feet from the North line and 990 feet from the

West line of Section 8, T. 18 S, R. 28 E, NMPM.

(GIVE LOCATION FROM SECTION LINE)

Artesia Pool, Eddy County

If State Land the Oil and Gas Lease is No. B-11539

If patented land the owner is

Address

We propose to drill well with drilling equipment as follows: Cable Tools

The status of plugging bond is Roach and Shepard

102 South Second - Artesia, New Mexico

Drilling Contractor Roach and Shepard

102 South Second - Artesia, New Mexico

We intend to complete this well in the Lovington

formation at an approximate depth of 2400 feet.

CASING PROGRAM

We propose to use the following strings of Casing and to cement them as indicated:

Size of Hole	Size of Casing	Weight per Foot	New or Second Hand	Depth	Sacks Cement
10	8 5/8"	28#	Used	500	50
	5 1/2"	14#	New	2350	100

If changes in the above plans become advisable we will notify you immediately.

ADDITIONAL INFORMATION

JAN 23 1958

Approved _____, 19_____
Except as follows:

OIL CONSERVATION COMMISSION

By M. L. Armstrong

Sincerely yours,

Roach and Shepard

(Company or Operator)

By

Position Agent

Send Communications regarding well to

Name Roach and Shepard

Address 102 South Second, Artesia, N. M.

NEW MEXICO OIL CONSERVATION COMMISSION

Well Location and Acreage Dedication Plat

Section A.

Date January
February 18, 1958

Operator ROACH & SHEPARD Lease Humble State
Well No. 2 Unit Letter R Section 8 Township 18 North Range 28 East NMPM
Located 2310 Feet From North Line, 990 Feet From West Line
County Elky G. L. Elevation _____ Dedicated Acreage 40 Acres
Name of Producing Formation Grayburg Pool Artesia

1. Is the Operator the only owner* in the dedicated acreage outlined on the plat below?
Yes X No _____.
2. If the answer to question one is "no," have the interests of all the owners been consolidated by communitization agreement or otherwise? Yes _____ No _____. If answer is "yes," Type of Consolidation _____
3. If the answer to question two is "no," list all the owners and their respective interests below:

Owner

Land Description

Section B

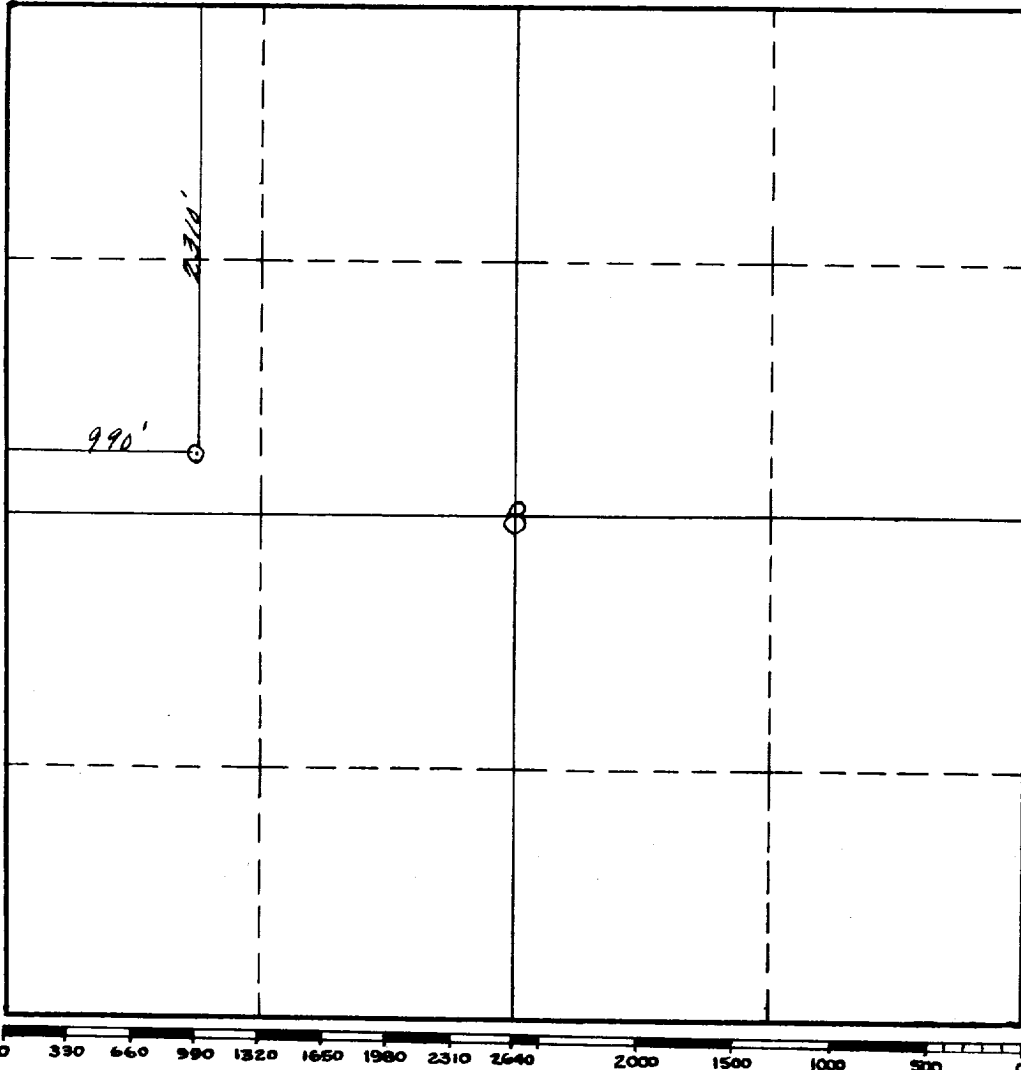

This is to certify that the information in Section A above is true and complete to the best of my knowledge and belief.

ROACH & SHEPARD

(Operator)

Robert S. Bourland
(Representative)

Artesia, New Mexico

Address

This is to certify that the well location shown on the plat in Section B was plotted from field notes of actual surveys made by me or under my supervision and that the same is true and correct to the best of my knowledge and belief.

Date Surveyed January
February 18, 1958

Walter P. Sullivan
Registered Professional
Engineer and/or Land Surveyor.

Certificate No. 963

INSTRUCTIONS FOR COMPLETION:

1. Operator shall furnish and certify to the information called for in Section A.
2. Operator shall outline the dedicated acreage for both oil and gas wells on the plat in Section B.
3. A registered professional engineer or land surveyor registered in the State of New Mexico or approved by the Commission shall show on the plat the location of the well and certify this information in the space provided.
4. All distances shown on the plat must be from the outer boundaries of Section.
5. If additional space is needed for listing owners and their respective interests as required in question 3, Section A, please use space below

OIL AND GAS COMMISSION		
ASST. COM. OFFICE		
No. of Wells	Operator	State Land Office
7	Operator	2
	State Land Office	1
	Operation Office	1
	State Land Office	2
	State Land Office	1
	State Land Office	✓

* "Owner" means the person who has the right to drill into and to produce from any pool and to appropriate the production either for himself or for himself and another. (65-3-29 (e) NMSA 1953 Comp.)