

Land Office New Mexico

Case No. NM-030752

Unit RECEIVED

30-015-03473
MAY 29 1961

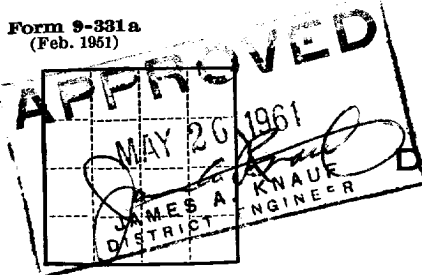

(SUBMIT IN TRIPLICATE)

UNITED STATES
DEPARTMENT OF THE INTERIOR
GEOLOGICAL SURVEY

SUNDRY NOTICES AND REPORTS ON WELLS

ARTESIA OFFICE

NOTICE OF INTENTION TO DRILL	<input checked="" type="checkbox"/>	SUBSEQUENT REPORT OF WATER SHUT-OFF	
NOTICE OF INTENTION TO CHANGE PLANS		SUBSEQUENT REPORT OF SHOOTING OR ACIDIZING	
NOTICE OF INTENTION TO TEST WATER SHUT-OFF		SUBSEQUENT REPORT OF ALTERING CASING	
NOTICE OF INTENTION TO RE-DRILL OR REPAIR WELL		SUBSEQUENT REPORT OF RE-DRILLING OR REPAIR	
NOTICE OF INTENTION TO SHOOT OR ACIDIZE		SUBSEQUENT REPORT OF ABANDONMENT	
NOTICE OF INTENTION TO PULL OR ALTER CASING		SUPPLEMENTARY WELL HISTORY	
NOTICE OF INTENTION TO ABANDON WELL			

(INDICATE ABOVE BY CHECK MARK NATURE OF REPORT, NOTICE, OR OTHER DATA)

May 26, 1961

Federal Sivley-Jennings
Well No. 2-28 is located 1980 ft. from [S] line and 660 ft. from [W] line of sec. 28

NW 1/4 Sec. 28 18S 29E N.M.P.M.
(1/4 Sec. and Sec. No.) (Twp.) (Range) (Meridian)

Turkey Track Eddy New Mexico
(Field) (County or Subdivision) (State or Territory)

The elevation of the derrick floor above sea level is 3460.8 ft.

DETAILS OF WORK

(State names of and expected depths to objective sands; show sizes, weights, and lengths of proposed casings; indicate mudding jobs, cementing points, and all other important proposed work)

We plan to drill a 2100' Queen sand test with rotary tools.

We propose to set approximately 430' of 7" surface casing with 100 sacks.

We plan to core the Queen and run a 4 1/2" oil string, cementing with 100 sacks.

All casing will be run and cemented, using methods approved by the U. S. Geological Survey.

RECEIVED

MAY 26 1961

U. S. GEOLOGICAL SURVEY
ARTESIA, NEW MEXICO

I understand that this plan of work must receive approval in writing by the Geological Survey before operation may be commenced.

Company John H. Trigg

Address P. O. Box 520

Roswell, New Mexico

By John H. Trigg
Title Operator

RECEIVED

NEW MEXICO OIL CONSERVATION COMMISSION
WELL LOCATION AND ACREAGE DEDICATION PLAT

FORM C-128
Revised 5/1/57

MAY 29 1961

SEE INSTRUCTIONS FOR COMPLETING THIS FORM ON THE REVERSE SIDE.

SECTION A

O. C. C.
ARTESIA, OFFICE

Operator John H. Trigg		Lease Federal Sivley-Jenning		Well No. 2-28	
Unit Letter L	Section 28	Township 18 South	Range 29 East	County Hddy	
Actual Footage Location of Well: 1980 feet from the South line and 660 feet from the West line					
Ground Level Elev. 3454.8	Producing Formation Queen Sand	Pool Turkey Tract		Dedicated Acreage: 40 Acres	

1. Is the Operator the only owner in the dedicated acreage outlined in the plat below? YES ☒ NO ____ . ("Owner" means the person who has the right to drill into and to produce from any pool and to appropriate the production either for himself or for himself and another. (65-3-29 (e) NMSA 1935 Comp.)
2. If the answer to question one is "no," have the interests of all the owners been consolidated by communitization agreement or otherwise? YES ____ NO ____ . If answer is "yes," Type of Consolidation ____
3. If the answer to question two is "no," list all the owners and their respective interests below:

Owner	Land Description

RECEIVED

MAY 26 1961

U. S. GEOLOGICAL SURVEY
ARTESIA, NEW MEXICO

SECTION B

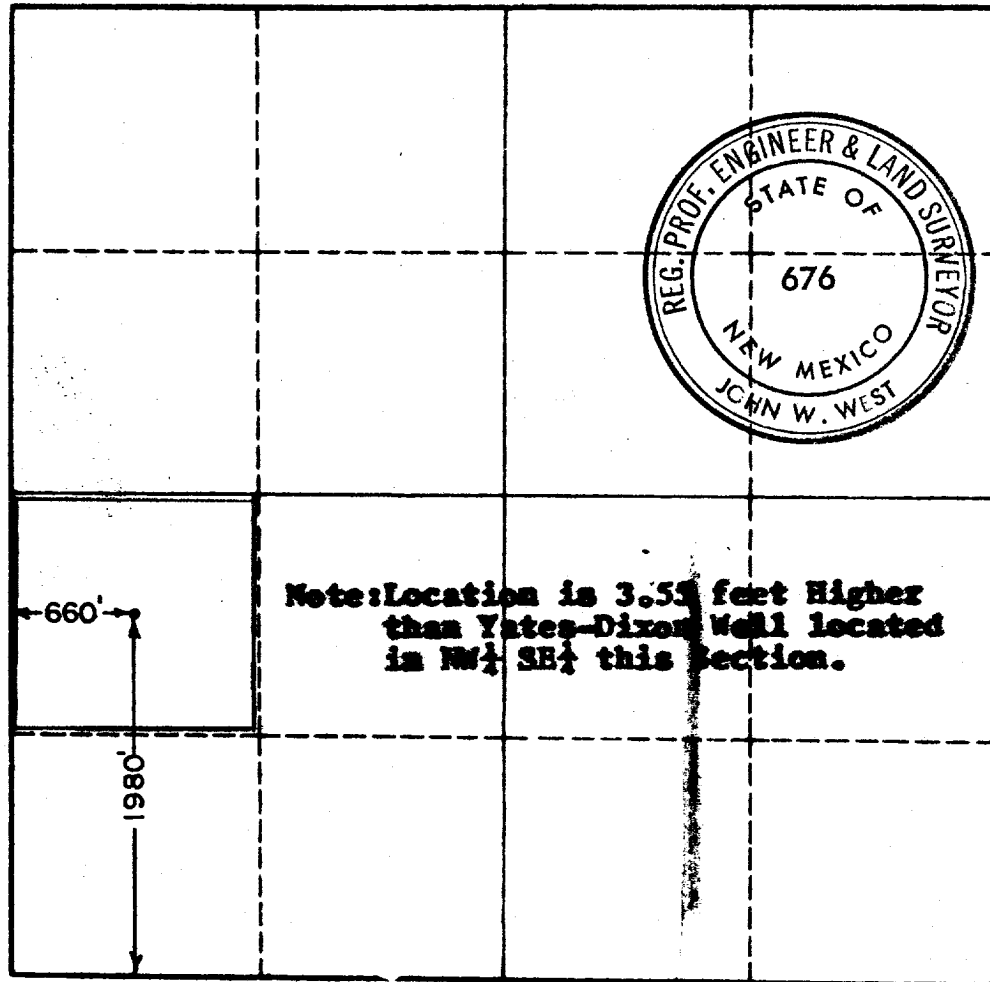

CERTIFICATION

I hereby certify that the information in SECTION A above is true and complete to the best of my knowledge and belief.

Name	John H. Trigg
Position	Operator
Company	John H. Trigg
Date	May 26, 1961

I hereby certify that the well location shown on the plat in SECTION B was plotted from field notes of actual surveys made by me or under my supervision, and that the same is true and correct to the best of my knowledge and belief.

Date Surveyed	5-12-61
Registered Professional Engineer and/or Land Surveyor,	JOHN W. WEST
Certificate No.	N. M. - P. E. & L. S. NO. 676