

(SUBMIT IN TRIPLICATE)

UNITED STATES
DEPARTMENT OF THE INTERIOR
GEOLOGICAL SURVEYLand Office **New Mexico**Lease No. **KH-039752**

Unit

RECEIVED
30-015-03474
JUN 22 1961

SUNDRY NOTICES AND REPORTS ON WELLS

O. C. C.
ARTESIA OFFICE

NOTICE OF INTENTION TO DRILL.....	<input checked="" type="checkbox"/>	SUBSEQUENT REPORT OF WATER SHUT-OFF.....	
NOTICE OF INTENTION TO CHANGE PLANS.....		SUBSEQUENT REPORT OF SHOOTING OR ACIDIZING.....	
NOTICE OF INTENTION TO TEST WATER SHUT-OFF.....		SUBSEQUENT REPORT OF ALTERING CASING.....	
NOTICE OF INTENTION TO RE-DRILL OR REPAIR WELL.....		SUBSEQUENT REPORT OF RE-DRILLING OR REPAIR.....	
NOTICE OF INTENTION TO SHOOT OR ACIDIZE.....		SUBSEQUENT REPORT OF ABANDONMENT.....	
NOTICE OF INTENTION TO PULL OR ALTER CASING.....		SUPPLEMENTARY WELL HISTORY.....	
NOTICE OF INTENTION TO ABANDON WELL.....			

(INDICATE ABOVE BY CHECK MARK NATURE OF REPORT, NOTICE, OR OTHER DATA)

June 14, 19 61

Federal Sivley-Jennings

Well No. **3-28** is located **660** ft. from **NEN** line and **660** ft. from **NEN** line of sec. **28****SW1/4 Sec. 28****188****29N****N.M.P.M.**

(1/4 Sec. and Sec. No.)

(Twp.)

(Range)

(Meridian)

Turkey Track**Eddy****New Mexico**

(Field)

(County or Subdivision)

(State or Territory)

The elevation of the derrick floor above sea level is _____ ft.

DETAILS OF WORK

(State names of and expected depths to objective sands; show sizes, weights, and lengths of proposed casings; indicate mudding jobs, cementing points, and all other important proposed work)

We plan to drill a 2100' Queen sand test with rotary tools.

We propose to set approximately 420' of 7" surface casing with 100 sacks.

We plan to core the Queen and run a 4 1/2" oil string, cementing with 100 sacks.

All casing will be run and cemented, using methods approved by the U. S. Geological Survey.

RECEIVED**JUN 16 1961**U. S. GEOLOGICAL SURVEY
ARTESIA, NEW MEXICO

I understand that this plan of work must receive approval in writing by the Geological Survey before operations may be commenced.

Company **John H. Trigg**Address **P. O. Box 520****Roswell, New Mexico**

By

Title

Operator

NEW MEXICO OIL CONSERVATION COMMISSION
WELL LOCATION AND ACREAGE DEDICATION PLAT

RECEIVED
 FORM C-128
 Revised 5/1/57
JUN 22 1961

SEE INSTRUCTIONS FOR COMPLETING THIS FORM ON THE REVERSE SIDE

Operator John Trigg				Lease Federal Sivley-Jennings		D.C.C. ARTESIAN OFFICE 3-28	
Unit Letter M	Section 28	Township 18 South	Range 29 East	County Eddy			
Actual Footage Location of Well: 660 feet from the South line and 660 feet from the West line							
Ground Level Elev. 3423	Producing Formation Queen sand		Pool Turkey Track		Dedicated Acreage: 40 Acres		

1. Is the Operator the only owner in the dedicated acreage outlined on the plat below? YES ☒ NO ____ . ("Owner" means the person who has the right to drill into and to produce from any pool and to appropriate the production either for himself or for himself and another. (65-3-29 (e) NMSA 1935 Comp.)
2. If the answer to question one is "no," have the interests of all the owners been consolidated by communitization agreement or otherwise? YES ____ NO ____ . If answer is "yes," Type of Consolidation **COMMUNITIZATION**
3. If the answer to question two is "no," list all the owners and their respective interests below:

Owner	Land Description

JUN 19 1961
 U.S. GEOLOGICAL SURVEY
 ARTESIAN, NEW MEXICO

SECTION B

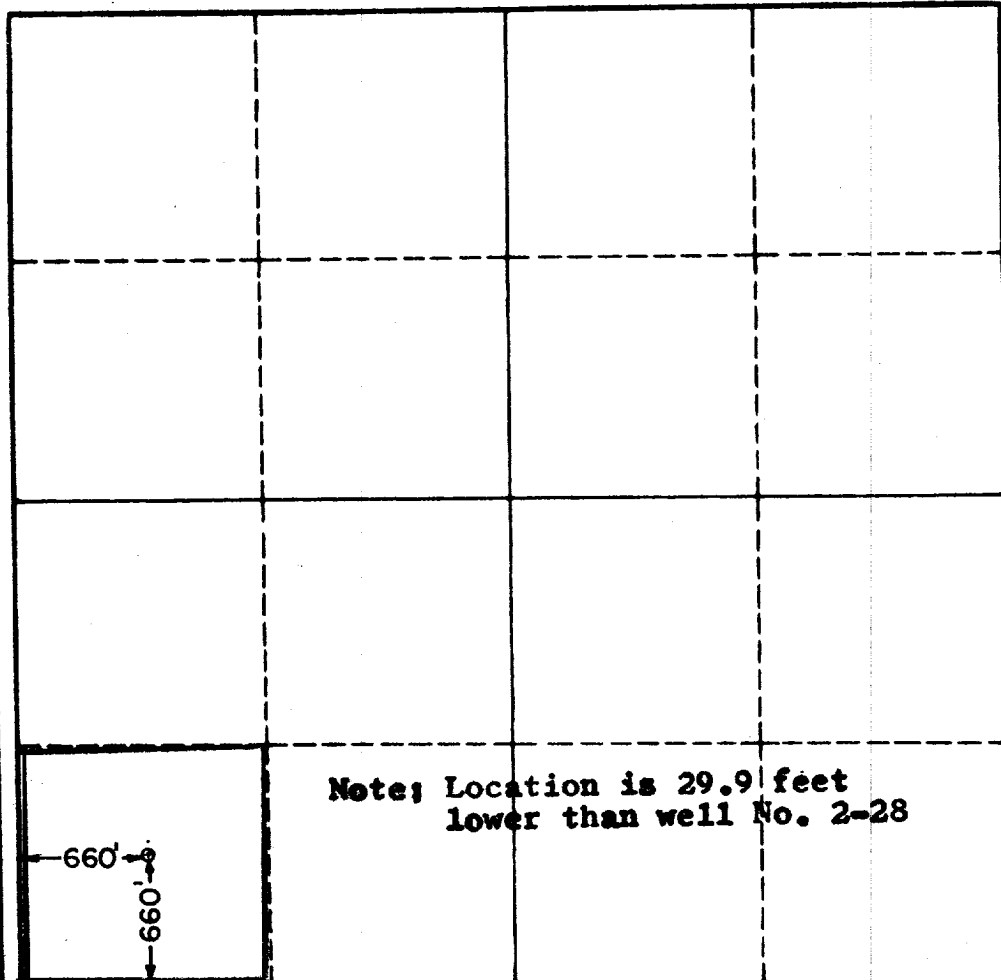

CERTIFICATION

I hereby certify that the information in SECTION A above is true and complete to the best of my knowledge and belief.

Name **John H. Trigg**
 Position **Operator**
 Company **John H. Trigg**
 Date **June 17, 1961**

I hereby certify that the well location shown on the plat in SECTION B was plotted from field notes of actual surveys made by me or under my supervision, and that the same is true and correct to the best of my knowledge and belief.

Date Surveyed	
Registered Professional Engineer and/or Land Surveyor, JOHN W. WEST	
Certificate No. 1574	
N.M. - L.S. MEAS. 87	JOHN W. WEST

0 330 660 990 1320 1650 1980 2310 2640 2000 1500 1000 500 0