

New Mexico

Land Office

Lease No. **18030752**

Unit

RECEIVED

30-015-03475
JUN 30 1961

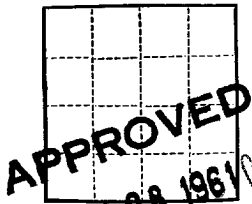

(SUBMIT IN TRIPLICATE)

UNITED STATES
DEPARTMENT OF THE INTERIOR
GEOLOGICAL SURVEY

O. C. C.
ARTESIA, OFFICE

NOTICE OF INTENTION TO DRILL AND REPORTS ON WELLS

NOTICE OF INTENTION TO DRILL	<input checked="" type="checkbox"/>	SUBSEQUENT REPORT OF WATER SHUT-OFF	
NOTICE OF INTENTION TO CHANGE PLANS		SUBSEQUENT REPORT OF SHOOTING OR ACIDIZING	
NOTICE OF INTENTION TO TEST WATER SHUT-OFF		SUBSEQUENT REPORT OF ALTERING CASING	
NOTICE OF INTENTION TO RE-DRILL OR REPAIR WELL		SUBSEQUENT REPORT OF RE-DRILLING OR REPAIR	
NOTICE OF INTENTION TO SHOOT OR ACIDIZE		SUBSEQUENT REPORT OF ABANDONMENT	
NOTICE OF INTENTION TO PULL OR ALTER CASING		SUPPLEMENTARY WELL HISTORY	
NOTICE OF INTENTION TO ABANDON WELL			

(INDICATE ABOVE BY CHECK MARK NATURE OF REPORT, NOTICE, OR OTHER DATA)

June 26, 1961

Federal Sivilley Jennings

Well No. **4-28** is located **990** ft. from **NE** line and **1650** ft. from **W** line of sec. **28**

NE 1/4 Sec. 28

T18S

R29E

N.M.P.M.

(1/4 Sec. and Sec. No.)

(Twp.)

(Range)

(Meridian)

Turkey Track

Eddy

New Mexico

(Field)

(County or Subdivision)

(State or Territory)

The elevation of the derrick floor above sea level is **3426.5** ft.

DETAILS OF WORK

(State names of and expected depths to objective sands; show sizes, weights, and lengths of proposed casings; indicate mudding jobs, cementing points, and all other important proposed work)

We plan to drill a 2100' Queen Sand test with rotary tools.

We propose to set approximately 430' of 7" surface casing with 100 sacks.

We plan to core the Queen and run a 4 1/2" oil string, cementing with 100 sacks.

All casing will be run and cemented, using methods approved by the U. S.

Geological Survey.

JUN 28 1961

I understand that this plan of work must receive approval in writing by the Geological Survey before operations may be commenced.

Company **John H. Trigg**

Address **P. O. Box 520**

Roswell, New Mexico

By

Title

John H. Trigg
Operator

RECEIVED

NEW MEXICO OIL CONSERVATION COMMISSION
WELL LOCATION AND ACREAGE DEDICATION PLAT

JUN 30 1961 PRM C-128
Revised 5/1/57

SEE INSTRUCTIONS FOR COMPLETING THIS FORM ON THE REVERSE SIDE

N. C. C.

SECTION A

Operator John Trigg		Lease Federal Sivley-Jennings		Well No. 4-28
Unit Letter N	Section 28	Township 18 South	Range 29 East	County Eddy
Actual Footage Location of Well: 990 feet from the South line and 1650 feet from the West line				
Ground Level Elev. 3422.8	Producing Formation Gilman	Pool Turkey Track	Dedicated Acreage: 4.00 Acres	

1. Is the Operator the only owner in the dedicated acreage outlined on the plat below? YES ☒ NO ☐ ("Owner" means the person who has the right to drill into and to produce from any pool and to appropriate the production either for himself or for himself and another. (65-3-29 (e) NMSA 1935 Comp.)
2. If the answer to question one is "no," have the interests of all the owners been consolidated by communitization agreement or otherwise? YES ☐ NO ☐ If answer is "yes," Type of Consolidation **RECEIVED**
3. If the answer to question two is "no," list all the owners and their respective interests below:

Owner	Land Description

JUN 28 1961

U. S. GEOLOGICAL SURVEY
ARTESIAN, NEW MEXICO

SECTION B

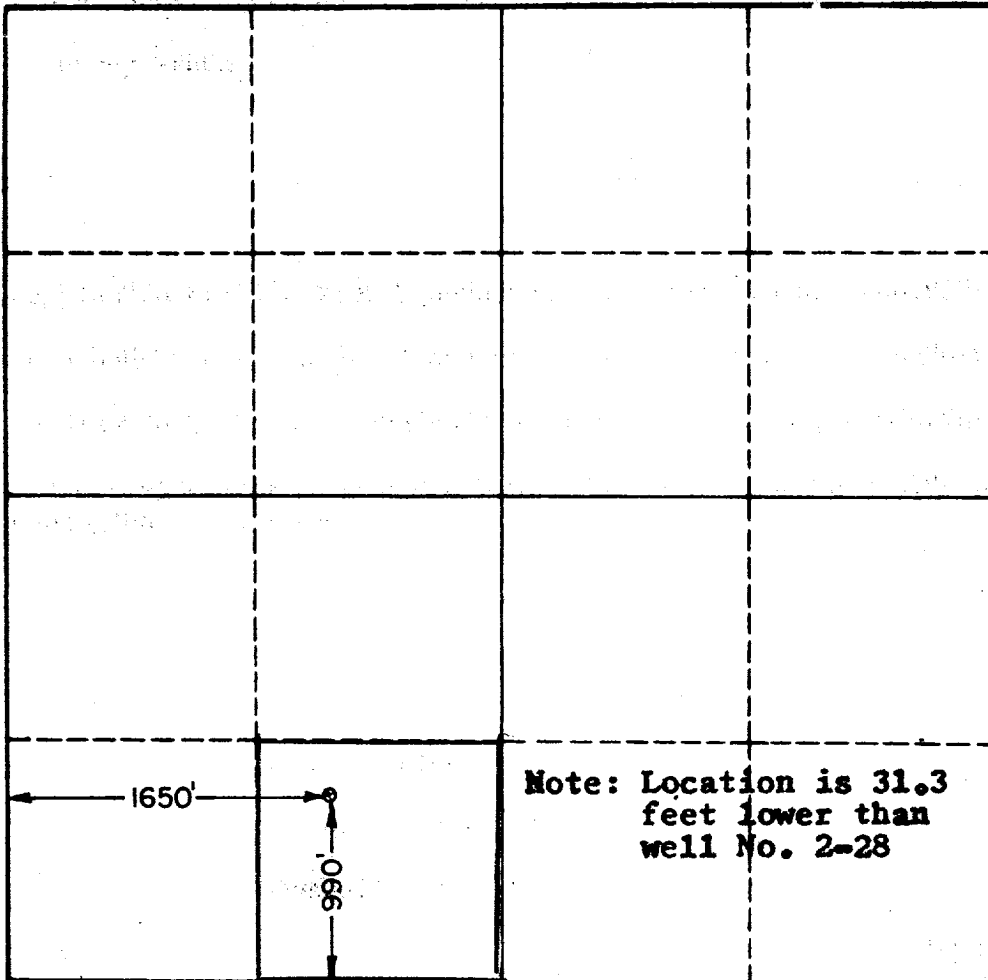

CERTIFICATION

I hereby certify that the information in SECTION A above is true and complete to the best of my knowledge and belief.

Name John H. Trigg
Position Engineer
Company John H. Trigg
Date June 28, 1961

I hereby certify that the location shown on the plat in SECTION B was plotted from field notes of actual surveys made by me or under my supervision, and that the same is true and correct to the best of my knowledge and belief.

Date Surveyed 6-14-61
Registered Professional Engineer and/or Land Surveyor, JOHN W. WEST
Certificate No. N. M. - P. E. & L. S. NO. 676