

(SUBMIT IN TRIPLICATE)

UNITED STATES
DEPARTMENT OF THE INTERIOR
GEOLOGICAL SURVEY

Land Office **Las Cruces**

Lease No. **NM 015068**

Unit

OCT 17 1957

SUNDRY NOTICES AND REPORTS ON WELLS

NOTICE OF INTENTION TO DRILL	<input checked="" type="checkbox"/>	SUBSEQUENT REPORT OF WATER SHUT-OFF
NOTICE OF INTENTION TO CHANGE PLANS		SUBSEQUENT REPORT OF SHOOTING OR ACIDIZING
NOTICE OF INTENTION TO TEST WATER SHUT-OFF		SUBSEQUENT REPORT OF ALTERING CASING
NOTICE OF INTENTION TO RE-DRILL OR REPAIR WELL		SUBSEQUENT REPORT OF RE-DRILLING OR REPAIR
NOTICE OF INTENTION TO SHOOT OR ACIDIZE		SUBSEQUENT REPORT OF ABANDONMENT
NOTICE OF INTENTION TO PULL OR ALTER CASING		SUPPLEMENTARY WELL HISTORY
NOTICE OF INTENTION TO ABANDON WELL		

(INDICATE ABOVE BY CHECK MARK NATURE OF REPORT, NOTICE, OR OTHER DATA)

October 10, 19 **57**

McKee-Wilson
Well No. **3** is located **330** ft. from **[N]** line and **330** ft. from **[E]** line of sec. **33**

NE, NE **18-S** **29-E** **N.M.P.**
(1/4 Sec. and Sec. No.) (Twp.) (Range) (Meridian)

Undesignated **Kddy** **New Mexico**
(Field) (County or Subdivision) (State or Territory)

The elevation of the derrick floor above sea level is **3430** ft.

DETAILS OF WORK

(State names of and expected depths to objective sands; show sizes, weights, and lengths of proposed casings; indicate mudding jobs, cementing points, and all other important proposed work)

Wish to drill a well to explore the Red Sand or Queen zone and if this zone proves unproductive, may explore the Grayburg series. The Red Sand should occur at approximately 2100 feet, the deeper zone a maximum of approximately 2750 feet. Intend to run approximately 350 feet of 8 5/8" surface pipe and cement with 25 sacks cement.

I understand that this plan of work must receive approval in writing by the Geological Survey before operations may be commenced.

Company **Robert E. McKee, General Contractor, Inc.**

Address **Box 246, Artesia, New Mexico**

By

Title

Manager of Oil Division

NEW MEXICO OIL CONSERVATION COMMISSION

Well Location and Acreage Dedication Plat

Date October 7, 1957

Section A.

Operator Robert E. McKee Lease Wilson
 Well No. 3 Unit Letter Section 33 Township 18 South Range 29 East NMPM
 Located 330 Feet From North Line, 330 Feet From East Line
 County Eliz G. L. Elevation 3429 Dedicated Acreage Acres
 Name of Producing Formation Queen or Grayburg Pool Undesignated

1. Is the Operator the only owner* in the dedicated acreage outlined on the plat below?
 Yes No .
2. If the answer to question one is "no," have the interests of all the owners been consolidated by communitization agreement or otherwise? Yes No X. If answer is "yes," Type of Consolidation
3. If the answer to question two is "no," list all the owners and their respective interests below:

Owner

Land Description

Robert E. McKee, General Contractor, Inc.Surface to 3000 feet.Ralph MixFrom 3000 feet.

Section B

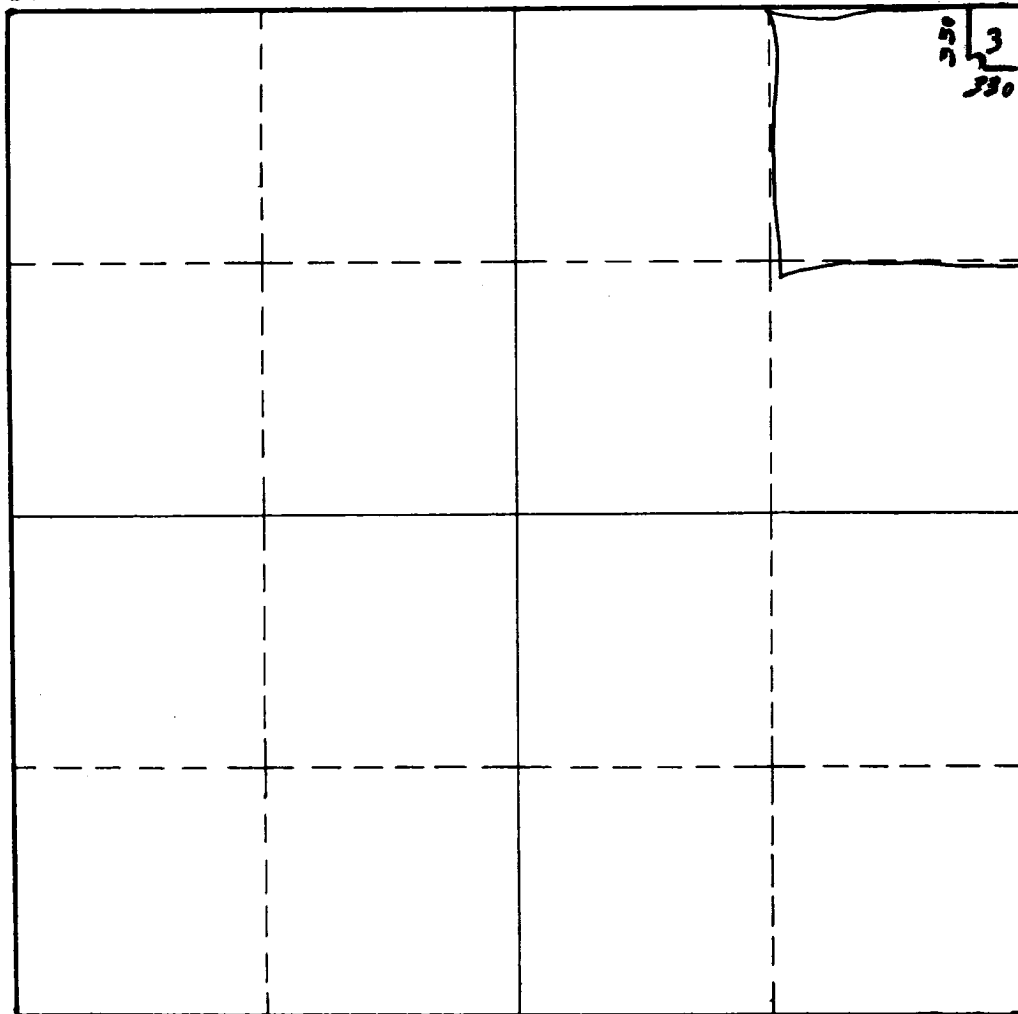

This is to certify that the information in Section A above is true and complete to the best of my knowledge and belief.

Robert E. McKee

(Operator)

(Representative)

Box 246, Artesia, New Mexico

Address

This is to certify that the well location shown on the plat in Section B was plotted from field notes of actual surveys made by me or under my supervision and that the same is true and correct to the best of my knowledge and belief.

Date Surveyed 10/7/57

John A. Mathis Jr.
 Registered Professional
 Engineer and/or Land Surveyor.

Certificate No. 1502

(See instructions for completing this form on the reverse side)

INSTRUCTIONS FOR COMPLETION :

1. Operator shall furnish and certify to the information called for in Section A.
2. Operator shall outline the dedicated acreage for both oil and gas wells on the plat in Section B.
3. A registered professional engineer or land surveyor registered in the State of New Mexico or approved by the Commission shall show on the plat the location of the well and certify this information in the space provided.
4. All distances shown on the plat must be from the outer boundaries of Section.
5. If additional space is needed for listing owners and their respective interests as required in question 3, Section A, please use space below

* "Owner" means the person who has the right to drill into and to produce from any pool and to appropriate the production either for himself or for himself and another. (65-3-29 (e) NMSA 1953 Comp.)