

(SUBMIT IN TRIPLICATE)

Land Office **New Mexico**Lease No. **MM 015068**

Unit

UNITED STATES  
DEPARTMENT OF THE INTERIOR  
GEOLOGICAL SURVEY

RECEIVED

JAN 25 1962

## SUNDRY NOTICES AND REPORTS ON WELLS

O. C. C.

ARTESIA, OFFICE

NOTICE OF INTENTION TO DRILL.....	<input checked="" type="checkbox"/>	SUBSEQUENT REPORT OF WATER SHUT-OFF.....	
NOTICE OF INTENTION TO CHANGE PLANS.....		SUBSEQUENT REPORT OF SHOOTING OR ACIDIZING.....	
NOTICE OF INTENTION TO TEST WATER SHUT-OFF.....		SUBSEQUENT REPORT OF ALTERING CASING.....	
NOTICE OF INTENTION TO RE-DRILL OR REPAIR WELL.....		SUBSEQUENT REPORT OF RE-DRILLING OR REPAIR.....	
NOTICE OF INTENTION TO SHOOT OR ACIDIZE.....		SUBSEQUENT REPORT OF ABANDONMENT.....	
NOTICE OF INTENTION TO PULL OR ALTER CASING.....		SUPPLEMENTARY WELL HISTORY.....	
NOTICE OF INTENTION TO ABANDON WELL.....			

(INDICATE ABOVE BY CHECK MARK NATURE OF REPORT, NOTICE, OR OTHER DATA)

January 22, 1962

Federal Wilson

Well No. **1-33** is located **640** ft. from **N** line and **390** ft. from **W** line of sec. **33**Section **33**

(1/4 Sec. and Sec. No.)

**18S**

(Twp.)

**29E**

(Range)

**106W**

(Meridian)

Turkey Track

(Field)

**Eddy**

(County or Subdivision)

**New Mexico**

(State or Territory)

The elevation of the derrick floor above sea level is **3425** ft. **Est.**

## DETAILS OF WORK

(State names of and expected depths to objective sands; show sizes, weights, and lengths of proposed casings; indicate mudding jobs, cementing points, and all other important proposed work)

We plan to drill a 2600' Grayburg test with rotary tools.

We propose to set 450' of 8 5/8" surface casing with 100 sacks.

We plan to run 5 1/2" production casing and cement with 200 sacks.

All casing will be run and cemented under methods approved by the U. S. Geological Survey.

RECEIVED

JAN 23 1962

U. S. GEOLOGICAL SURVEY  
ARTESIA, NEW MEXICO

I understand that this plan of work must receive approval in writing by the Geological Survey before operations may be commenced.

Company **JOHN H. TRIGGS CO.**Address **P. O. Box 320****Reswell, New Mexico**By **John H. Triggs**  
Title **OPERATOR**



NEW MEXICO OIL CONSERVATION COMMISSION  
WELL LOCATION AND ACREAGE DEDICATION PLAT

FORM C-128  
Revised 5/1/57

SEE INSTRUCTIONS FOR COMPLETING THIS FORM ON THE REVERSE SIDE

SECTION A

Operator <b>John H. Trigg</b>		Lease <b>Federal-Wilson</b>		Well No. <b>1-33</b>	
Unit Letter <b>D</b>	Section <b>33</b>	Township <b>18 South</b>	Range <b>29 East</b>	County <b>Eddy</b>	
Actual Footage Location of Well: <b>660</b> feet from the <b>north</b> line and <b>330</b> feet from the <b>west</b> line					
Ground Level Elev. <b>3500.8</b>	Producing Formation <b>Grayburg sandstone</b>		Pool <b>Turkey Track</b>	Dedicated Acreage: <b>40</b> Acres	

1. Is the Operator the only owner in the dedicated acreage outlined on the plat below? YES ☒ NO ☐ ("Owner" means the person who has the right to drill into and to produce from any pool and to appropriate the production either for himself or for himself and another. (65-3-29 (e) NMSA 1935 Comp.)
2. If the answer to question one is "no," have the interests of all the owners been consolidated by communitization agreement or otherwise? YES ☐ NO ☐ If answer is "yes," Type of Consolidation \_\_\_\_\_
3. If the answer to question two is "no," list all the owners and their respective interests below:

Owner	Land Description
	<b>JAN 24 1962</b>
	<b>LOCAL SURVEY</b>
	<b>NEW MEXICO</b>

SECTION B

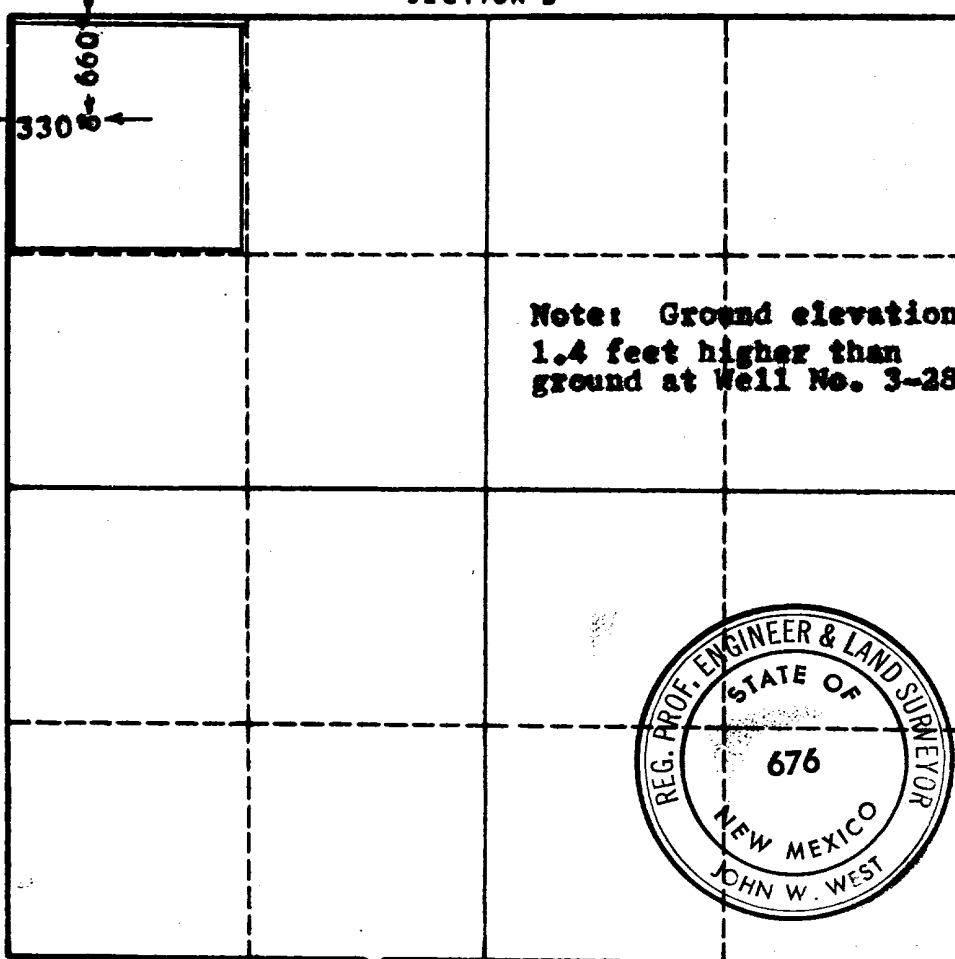

CERTIFICATION

I hereby certify that the information in SECTION A above is true and complete to the best of my knowledge and belief.

Name **John H. Trigg**  
Position **Operator**  
Company **John H. Trigg**  
Date **January 23, 1962**

I hereby certify that the well location shown on the plat in SECTION B was plotted from field notes of actual surveys made by me or under my supervision, and that the same is true and correct to the best of my knowledge and belief.

Date Surveyed **January 16, 1962**  
Registered Professional Engineer and/or Land Surveyor, **JOHN W. WEST**

Certificate No. **John W. West**  
N. M. - P. E. & L. S. NO. 676

0 330 660 990 1320 1650 1980 2310 2640 2970 3300 3630 3960 4290 4620 4950 5280 5610 5940 6270 6600

3-2-65 - Gamma Ray - Wentworth

30-015-03492

OUR ID # 24164

POP # 24462

chg - OK

pool # 61020

WCM P + PRO OK

2277810-C

2277830-G

2277850-W

