

COPY TO O. C. C.

(SUBMIT IN TRIPLICATE)

UNITED STATES
DEPARTMENT OF THE INTERIOR
GEOLOGICAL SURVEY

Budget Bureau No. 42-R338.4
Approval expires 12-31-60.

Land Office _____
Lease No. **NM 014068**
Unit **F**

SUNDRY NOTICES AND REPORTS ON WELLS

NOTICE OF INTENTION TO DRILL	<input checked="" type="checkbox"/>	SUBSEQUENT REPORT OF WATER SHUT-OFF
NOTICE OF INTENTION TO CHANGE PLANS	<input type="checkbox"/>	SUBSEQUENT REPORT OF SHOOTING OR ACIDIZING
NOTICE OF INTENTION TO TEST WATER SHUT-OFF	<input type="checkbox"/>	SUBSEQUENT REPORT OF ALTERING CASING
NOTICE OF INTENTION TO RE-DRILL OR REPAIR WELL	<input type="checkbox"/>	SUBSEQUENT REPORT OF RE-DRILLING OR REPAIR
NOTICE OF INTENTION TO SHOOT OR ACIDIZE	<input type="checkbox"/>	SUBSEQUENT REPORT OF ABANDONMENT
NOTICE OF INTENTION TO PULL OR ALTER CASING	<input type="checkbox"/>	SUPPLEMENTARY WELL HISTORY
NOTICE OF INTENTION TO ABANDON WELL	<input type="checkbox"/>	

(INDICATE ABOVE BY CHECK MARK NATURE OF REPORT, NOTICE, OR OTHER DATA)

December 8, 1958

McKee-Wilson

Well No. **5** is located **1650** ft. from **[N]** line and **2310** ft. from **[W]** line of sec. **34**

SE 1/4 NW 1/4

(1/4 Sec. and Sec. No.)

18S.

(Twp.)

29E.

(Range)

N.M.P.

(Meridian)

Turkey Track

(Field)

Eddy

(County or Subdivision)

New Mexico

(State or Territory)

The elevation of the derrick floor above sea level is **3410** ft.

DETAILS OF WORK

(State names of and expected depths to objective sands; show sizes, weights, and lengths of proposed casings; indicate mudding jobs, cementing points, and all other important proposed work)

Wish to drill a well on the above described location as follows:

Drill to salt with 10" hole and cement 8 5/8" pipe with 25 sacks, this should be at approximately 335 feet. We then intend to drill to a depth sufficient to explore the Red Sand. If Red Sand is unproductive, we will explore to the depth not to exceed 3,000 feet.

I understand that this plan of work must receive approval in writing by the Geological Survey before operations may be commenced.

Company **Robert E. McKee General Contractor, Inc.**

Address **410 Hermosa Drive**

Artesia, New Mexico

By

Title **Manager of Oil Production**

NEW MEXICO OIL CONSERVATION COMMISSION

Well Location and Acreage Dedication Plat

Section A.

Date November 13, 1958

Operator Robert E. McKee Lease Wilson
Well No. 5 Unit Letter Section 34 Township 18 South Range 29 East NMPM
Located 1650 Feet From North Line, 2310 Feet From West Line
County Eddy G. L. Elevation 3410 Dedicated Acreage Acres
Name of Producing Formation Red Sand or Grayburg Pool Turkey Track

1. Is the Operator the only owner* in the dedicated acreage outlined on the plat below?
Yes No X.
2. If the answer to question one is "no," have the interests of all the owners been consolidated by communitization agreement or otherwise? Yes No . If answer is "yes," Type of Consolidation
3. If the answer to question two is "no," list all the owners and their respective interests below:

<u>Owner</u>	<u>Land Description</u>
<u>Robert E. McKee General Contractor, Inc.</u>	<u>Surface to 3,000 ft. plus 100 ft.</u>
<u>Wilson Oil Company</u>	<u>Below 3,000 feet.</u>

Section B

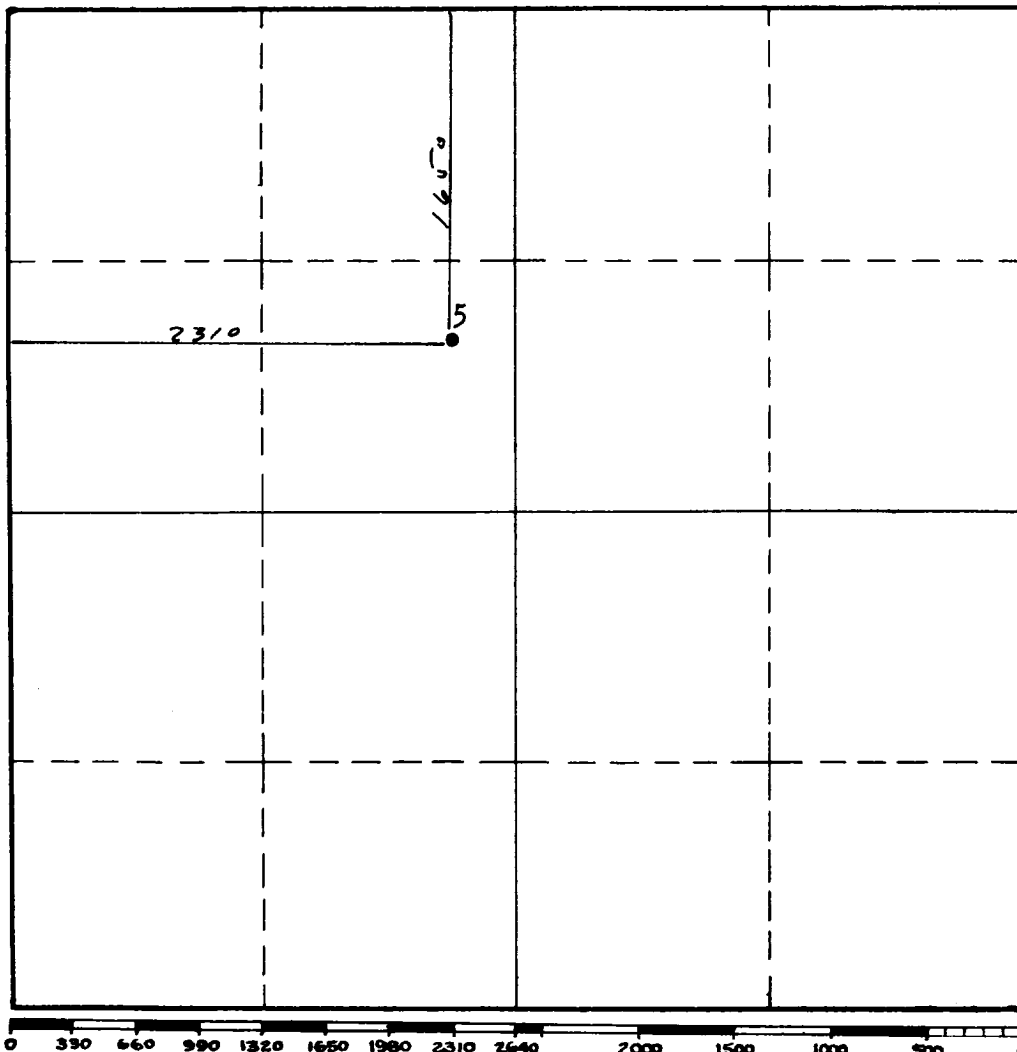

RECEIVED
DEC 9 1958

U. S. DEPT. OF THE INTERIOR
BUREAU OF LAND MANAGEMENT
This is to certify that the information in Section A above is true and complete to the best of my knowledge and belief.

Robert E. McKee
(Operator)
John A. Mathis, Jr.
(Representative)

Box 246, Artesia, New Mexico
Address

This is to certify that the well location shown on the plat in Section B was plotted from field notes of actual surveys made by me or under my supervision and that the same is true and correct to the best of my knowledge and belief.

Date Surveyed 11/13/58

John A. Mathis, Jr.
Registered Professional
Engineer and/or Land Surveyor.

Certificate No. 1502

INSTRUCTIONS FOR COMPLETION

1. Operator shall furnish and certify to the information called for in Section A.
2. Operator shall outline the dedicated acreage for both oil and gas wells on the plat in Section B.
3. A registered professional engineer or land surveyor registered in the State of New Mexico or approved by the Commission shall show on the plat the location of the well and certify this information in the space provided.
4. All distances shown on the plat must be from the outer boundaries of Section.
5. If additional space is needed for listing owners and their respective interests as required in question 3, Section A, please use space below

* "Owner" means the person who has the right to drill into and to produce from any pool and to appropriate the production either for himself or for himself and another. (65-3-29 (e) NMSA 1953 Comp.)