

(SUBMIT IN TRIPLICATE)

UNITED STATES
DEPARTMENT OF THE INTERIOR
GEOLOGICAL SURVEY

Land Office New Mexico
Lease No. BM 02056
Unit E

0			

SUNDRY NOTICES AND REPORTS ON WELLS

NOTICE OF INTENTION TO DRILL.....	SUBSEQUENT REPORT OF WATER SHUT-OFF.....	
NOTICE OF INTENTION TO CHANGE PLANS.....	SUBSEQUENT REPORT OF SHOOTING OR ACIDIZING.....	
NOTICE OF INTENTION TO TEST WATER SHUT-OFF.....	SUBSEQUENT REPORT OF ALTERING CASING.....	
NOTICE OF INTENTION TO RE-DRILL OR REPAIR WELL.....	SUBSEQUENT REPORT OF RE-DRILLING OR REPAIR.....	
NOTICE OF INTENTION TO SHOOT OR ACIDIZE.....	SUBSEQUENT REPORT OF ABANDONMENT.....	
NOTICE OF INTENTION TO PULL OR ALTER CASING.....	SUPPLEMENTARY WELL HISTORY.....	
NOTICE OF INTENTION TO ABANDON WELL.....	<u>Corrected location on Dry Hole</u>	<u>X</u>

(INDICATE ABOVE BY CHECK MARK NATURE OF REPORT, NOTICE, OR OTHER DATA)

Corrected November 16, 1956
Not Drilled
Well No. 1 is located 2500 ft. from N line and 13.5 ft. from W line of sec. 34
Sec. 34 (Sec. and Sec. No.) 183 (Twp.) 29E (Range) WESTERN S.M.P.M. (Meridian)
Parkey Tract (Field) 1840 (County or Subdivision) New Mexico (State or Territory)

The elevation of the derrick floor above sea level is 3424 ft.

DETAILS OF WORK

(State names of and expected depths to objective sands; show sizes, weights, and lengths of proposed casings; indicate mudding jobs, cementing points, and all other important proposed work)

This is a corrected notice on test already drilled, plugged and abandoned. This form is filed as the original notice filed was in error as to the footage.

I understand that this plan of work must receive approval in writing by the Geological Survey before operations may be commenced.

Company Ralph Mix and Jerry Curtis
Address P.O. Box 605
Artesia, New Mexico
By Jerry Curtis
Title Co-owner

NEW MEXICO
OIL CONSERVATION COMMISSION

Form C-128

CORRECTED
COPY

Well Location and/or Gas Proration Plat

Date November 15, 1976

Operator Ralph E. & Jerry Curtis Lease Elk Federal

Well No. 1 Section 34 Township 13S Range 29E NMPM

Located 2508 Feet From North Line, 42.5 Feet From West Line Line,

Elk County, New Mexico. G. L. Elevation _____

Name of Producing Formation Gallup Pool Turkey Track Dedicated Acreage 40

(Note: All distances must be from outer boundaries of Section)

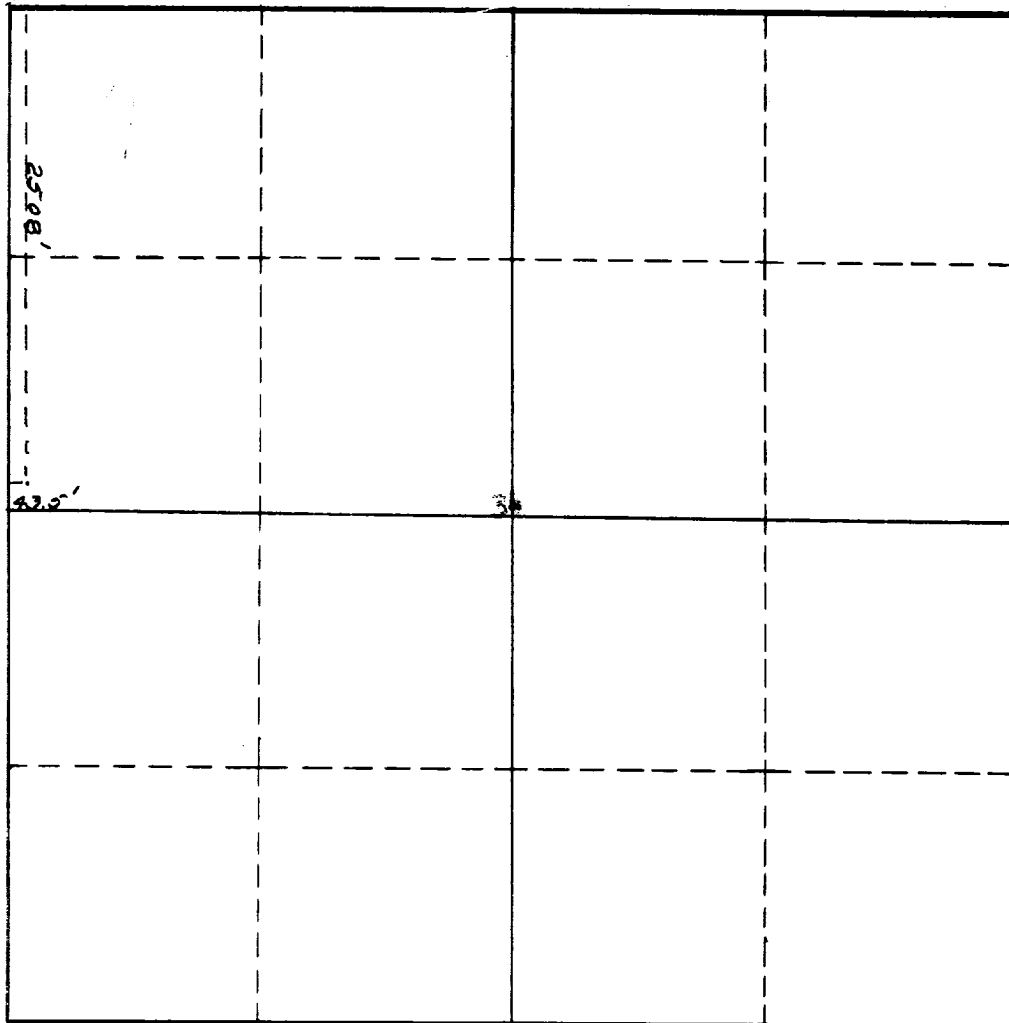

SCALE: 1"=1000'

1. Is this Well a Dual Comp. ? Yes ☐ No ☐.
2. If the answer to Question 1 is yes, are there any other dually completed wells within the dedicated acreage ? Yes ☐ No ☐.

This is to certify that the above plat was prepared from field notes of actual surveys made by me or under my supervision and that the same are true and correct to the best of my knowledge and belief.

Name _____
Position _____
Representing _____
Address _____

Date Surveyed September 15, 1976
Richard P. Hutton
Registered Professional Engineer and/or
Land Surveyor