

(SUBMIT IN TRIPLICATE)

UNITED STATES
DEPARTMENT OF THE INTERIOR
GEOLOGICAL SURVEYLand Office _____
Lease No. LC 062029
Unit KAPPROVED
DEC 2 1961A. R. BROWN
ACTING DISTRICT ENGINEER

RECEIVED

NOV 30 1961

SUNDRY NOTICES AND REPORTS ON WELLS

NOTICE OF INTENTION TO DRILL.....	X	SUBSEQUENT REPORT OF WATER SHUT-OFF.....	D. C. C.
NOTICE OF INTENTION TO CHANGE PLANS.....		SUBSEQUENT REPORT OF SHOOTING OR ACIDIZING.....	ARTESIA, OFFICE
NOTICE OF INTENTION TO TEST WATER SHUT-OFF.....		SUBSEQUENT REPORT OF ALTERING CASING.....	
NOTICE OF INTENTION TO RE-DRILL OR REPAIR WELL.....		SUBSEQUENT REPORT OF RE-DRILLING OR REPAIR.....	RECEIVED
NOTICE OF INTENTION TO SHOOT OR ACIDIZE.....		SUBSEQUENT REPORT OF ABANDONMENT.....	
NOTICE OF INTENTION TO PULL OR ALTER CASING.....		SUPPLEMENTARY WELL HISTORY.....	DEC 8 1961
NOTICE OF INTENTION TO ABANDON WELL.....			

(INDICATE ABOVE BY CHECK MARK NATURE OF REPORT, NOTICE, OR OTHER DATA)

D. C. C.
ARTESIA, OFFICE

November 28, 19 61

Water Injection
Well No. 5-W is located 1325 ft. from ~~XX~~
[S] line and 1325 ft. from ~~XX~~
[W] line of sec. 34
NE 1/4 of SW 1/4 34 18 S 29 E NMP
(1/4 Sec. and Sec. No.) (Twp.) (Range) (Meridian)
Turkey Track Eddy New Mexico
(Field) (County or Subdivision) (State or Territory)

The elevation of the derrick floor above sea level is _____ ft. (Will report later)

DETAILS OF WORK

(State names of and expected depths to objective sands; show sizes, weights, and lengths of proposed casings; indicate mudding jobs, cementing points, and all other important proposed work)

Propose to drill well to Queen Sand, expected to be found at 2080' to 2200'.
Propose to set 8 5/8" surface casing at 360' and cement to surface. Propose
to set 4 1/2" production casing at T.D. and cement to 1600' outside casing
opposite Queen Sand. Propose to use well as a water injection well in water-
flood project.

I understand that this plan of work must receive approval in writing by the Geological Survey before operations may be commenced.

Company Stanton Oil Company, Ltd. Agent for R. E. McKee

Address 408 Wilkinson-Foster Building

Midland, Texas

By Original Signed by Wm. E. Fickert

Title Agent

NEW MEXICO OIL CONSERVATION COMMISSION
WELL LOCATION AND ACREAGE DEDICATION PLAT

FORM C-128
Revised 5/1/57

SEE INSTRUCTIONS FOR COMPLETING THIS FORM ON THE REVERSE SIDE

SECTION A

Operator Hydrex Oil Company, Inc.		Lease Block 1325		Well No. 31
Unit Letter K	Section 18	Township 18S	Range 29E	County Eddy
Actual Footage Location of Well: 1325 feet from the West line and 1325 feet from the South line				
Ground Level Elev.	Producing Formation Queen	Pool Turkey Track	Dedicated Acreage: _____ Acres	

1. Is the Operator the only owner in the dedicated acreage outlined on the plat below? YES _____ NO _____. ("Owner" means the person who has the right to drill into and to produce from any pool and to appropriate the production either for himself or for himself and another. (65-3-29 (e) NMSA 1935 Comp.)
2. If the answer to question one is "no," have the interests of all the owners been consolidated by communitization agreement or otherwise? YES _____ NO _____. If answer is "yes," Type of Consolidation _____
3. If the answer to question two is "no," list all the owners and their respective interests below:

RECEIVED

Owner	Land Description
	DEC 4 1961 U. S. GEOLOGICAL SURVEY ARTESIA, NEW MEXICO

SECTION B

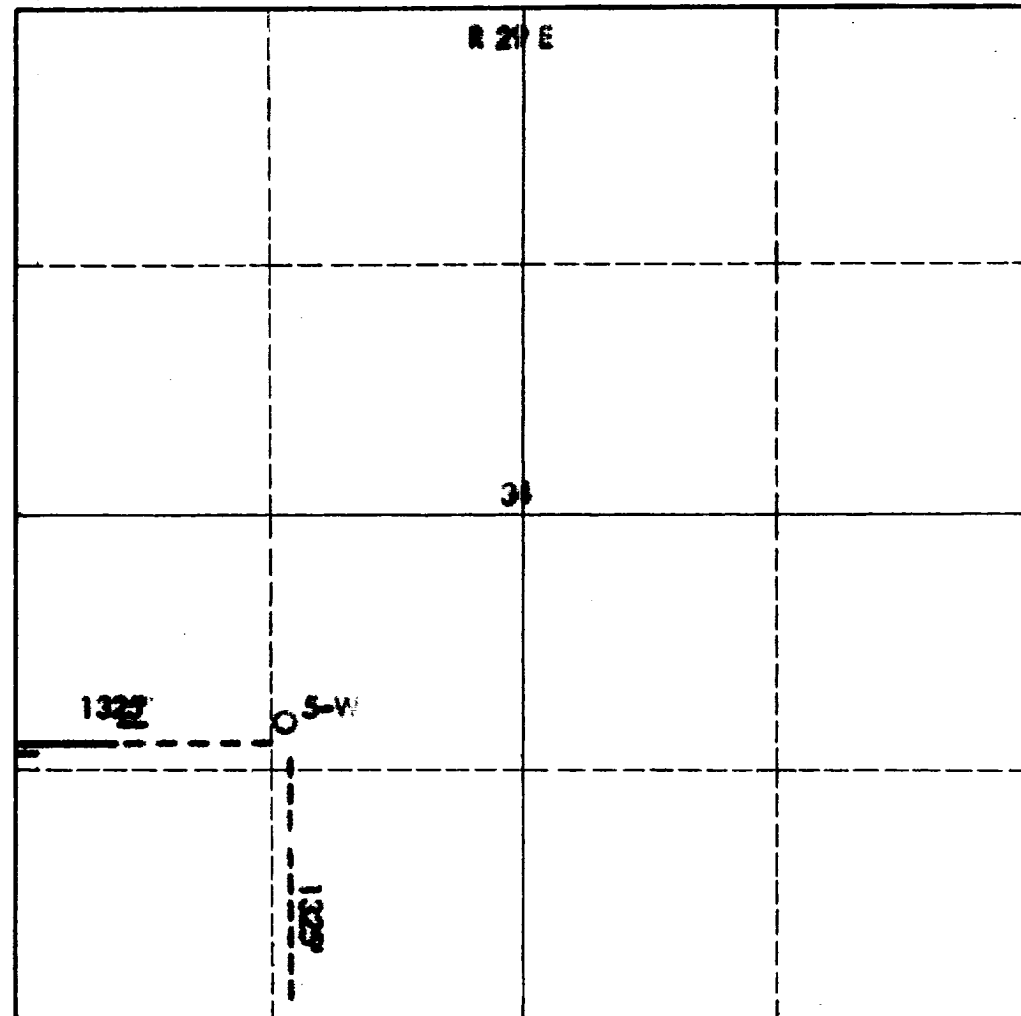

CERTIFICATION

I hereby certify that the information in SECTION A above is true and complete to the best of my knowledge and belief.

Name	Wm E Fickert
Position	Agent
Company	Hydrex Oil Co.
Date	12-2-61

I hereby certify that the well location shown on the plat in SECTION B was plotted from field notes of actual surveys made by me or under my supervision, and that the same is true and correct to the best of my knowledge and belief.

Date Surveyed	December 1st 1961
Registered Professional Engineer and/or Land Surveyor	James H. Brown
Certificate No.	572

T
18
S

INSTRUCTIONS FOR COMPLETION OF FORM C-128

1. Operator shall furnish and certify to the information called for in Section A.
2. Operator shall outline the dedicated acreage for *both* oil and gas wells on the plat in Section B.
3. A registered professional engineer or land surveyor registered in the State of New Mexico or approved by the Commission shall show on the plat the location of the well and certify this information in the space provided.
4. All distances shown on the plat must be from the outer boundaries of the Section.
5. If additional space is needed for listing owners and their respective interests as required in question 3 of Section A, please use space below.