

(SUBMIT IN TRIPLICATE)

UNITED STATES
DEPARTMENT OF THE INTERIOR
GEOLOGICAL SURVEYLand Office **New Mexico**Lease No. **01159**Unit **RECEIVED**

DEC 6 1961

SUNDRY NOTICES AND REPORTS ON WELLS

D. E. D.
ARTEBIA, OFFICIAL

NOTICE OF INTENTION TO DRILL.....	<input checked="" type="checkbox"/>	SUBSEQUENT REPORT OF WATER SHUT-OFF.....	
NOTICE OF INTENTION TO CHANGE PLANS.....		SUBSEQUENT REPORT OF SHOOTING OR ACIDIZING.....	
NOTICE OF INTENTION TO TEST WATER SHUT-OFF.....		SUBSEQUENT REPORT OF ALTERING CASING.....	
NOTICE OF INTENTION TO RE-DRILL OR REPAIR WELL.....		SUBSEQUENT REPORT OF RE-DRILLING OR REPAIR.....	
NOTICE OF INTENTION TO SHOOT OR ACIDIZE.....		SUBSEQUENT REPORT OF ABANDONMENT.....	
NOTICE OF INTENTION TO PULL OR ALTER CASING.....		SUPPLEMENTARY WELL HISTORY.....	
NOTICE OF INTENTION TO ABANDON WELL.....			

(INDICATE ABOVE BY CHECK MARK NATURE OF REPORT, NOTICE, OR OTHER DATA)

December 4, 1961

Nelson

Well No. **3** is located **2310** ft. from **N** line and **1650** ft. from **W** line of sec. **4****SE 1/4 Sec. 4**

(1/4 Sec. and Sec. No.)

18 S.

(Twp.)

30 E.

(Range)

N.M.P.M.

(Meridian)

Undesignated

(Field)

Eddy

(County or Subdivision)

New Mexico

(State or Territory)

The elevation of the derrick floor above sea level is **3564** ft.

DETAILS OF WORK

(State names of and expected depths to objective sands; show sizes, weights, and lengths of proposed casings; indicate mudding jobs, cementing points, and all other important proposed work)

Plan to commence operations on or before December 6, 1961 and drill to approximately 550' and set 550' of 8-5/8" O.D. 24# J-55 seamless casing and cement with 175 sacks of regular POZ XX calcium chloride and circulate to surface. After test for water shutoff, plan to drill to approximately 3550' and, if productive, plan to run approximately 3550' of 5-1/2" 15.5# of J-55 casing and cement with 200 sacks of EMER POZ XX gel. Well to be completed in the San Andres formation and is to be drilled from top to bottom with rotary tools.

I understand that this plan of work must receive approval in writing by the Geological Survey before operations may be commenced.

Company **Franklin, Aston & Fair, Inc.**Address **P. O. Box 1090****Roswell, New Mexico**By **R. R. Aston**Title **Vice President**

NUMBER OF COPIES RECEIVED	
DISTRIBUTION	
SANTA FE	
FILE	
U.S.G.S.	
LAND OFFICE	
TRANSPORTER	OIL GAS
PRODUCTION OFFICE	
OPERATOR	

NEW MEXICO OIL CONSERVATION COMMISSION
WELL LOCATION AND ACREAGE DEDICATION PLAT
 SEE INSTRUCTIONS FOR COMPLETING THIS FORM ON THE REVERSE SIDE

FORM C-128
 Revised 5/1/57

SECTION A

Operator Franklin, Aston & Fair, Inc.		Lease Johnson		Well No. 3
Unit Letter 400	Section 4	Township 18 N	Range 10 E	County Eddy
Actual Footage Location of Well: 2010 feet from the 14 line and 1470 feet from the 4 line				
Ground Level Elev. 3700	Producing Formation any	Pool Johnson	Dedicated Acreage: 40 Acres	

1. Is the Operator the only owner in the dedicated acreage outlined on the plat below? YES ☒ NO ☐ ("Owner" means the person who has the right to drill into and to produce from any pool and to appropriate the production either for himself or for himself and another. (65-3-29 (e) NMSA 1935 Comp.)
2. If the answer to question one is "no," have the interests of all the owners been consolidated by communitization agreement or otherwise? YES ☐ NO ☐ If answer is "yes," Type of Consolidation _____
3. If the answer to question two is "no," list all the owners and their respective interests below:

Owner Franklin, Aston & Fair, Inc.	Land Description SE 1/4 Sec. 4, T. 18 S. R. 10 E. 1961
	Eddy County, New Mexico

RECEIVED

**U. S. GEOLOGICAL SURVEY
 ARTESIA, NEW MEXICO
 CERTIFICATION**

SECTION B

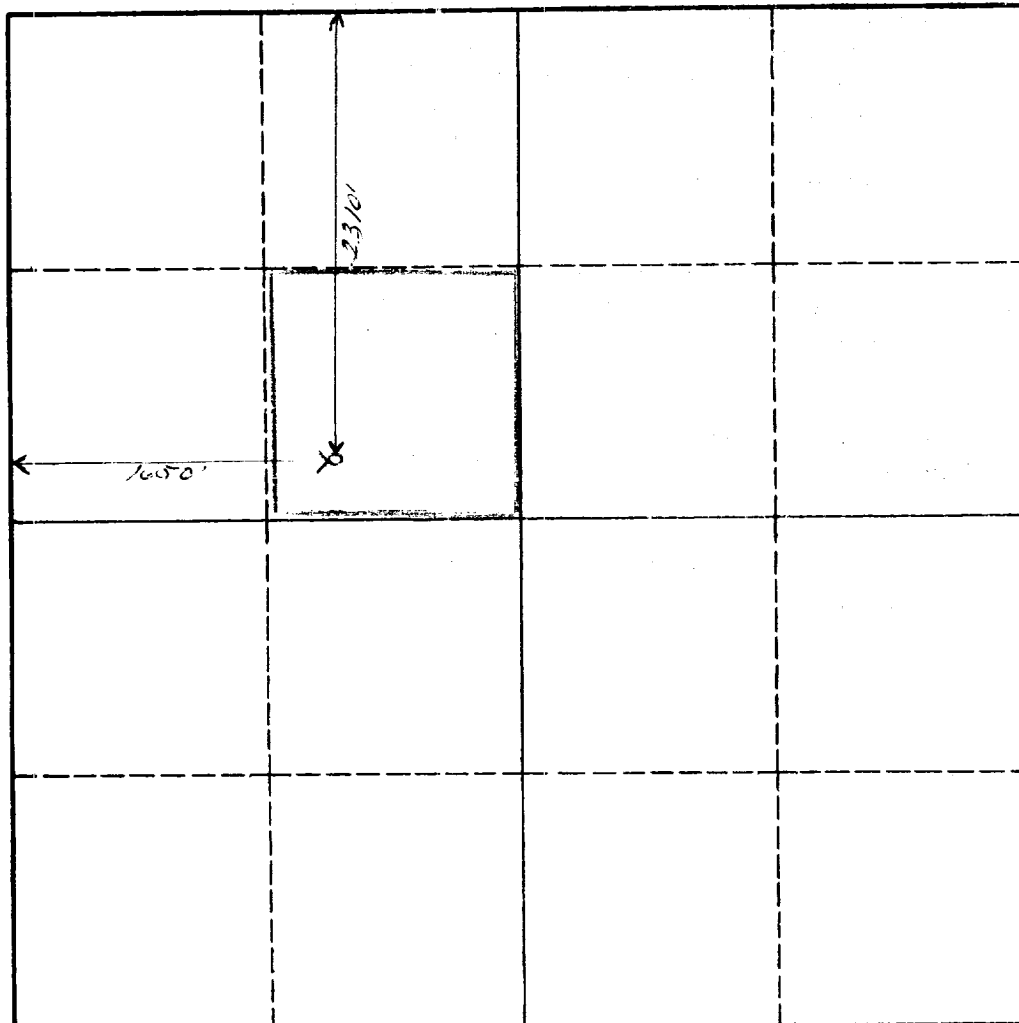

I hereby certify that the information in SECTION A above is true and complete to the best of my knowledge and belief.

Name R. R. Austin
Position Vice President
Company Franklin, Aston & Fair, Inc.
Date December 4, 1961

I hereby certify that the well location shown on the plat in SECTION B was plotted from field notes of actual surveys made by me or under my supervision, and that the same is true and correct to the best of my knowledge and belief.

Date Surveyed 12/2/61
Registered Professional Engineer and/or Land Surveyor [Signature]

Certificate No. **1782**

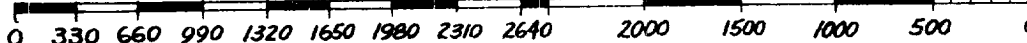

INSTRUCTIONS FOR COMPLETION OF FORM C-128

1. Operator shall furnish and certify to the information called for in Section A.
2. Operator shall outline the dedicated acreage for *both* oil and gas wells on the plat in Section B.
3. A registered professional engineer or land surveyor registered in the State of New Mexico or approved by the Commission shall show on the plat the location of the well and certify this information in the space provided.
4. All distances shown on the plat must be from the outer boundaries of the Section.
5. If additional space is needed for listing owners and their respective interests as required in question 3 of Section A, please use space below.