

(SUBMIT IN TRIPLICATE)

UNITED STATES
DEPARTMENT OF THE INTERIOR
GEOLOGICAL SURVEY

Land Office Los Cruces
Lease No. 063621
Unit J

SUNDRY NOTICES AND REPORTS ON WELLS

NOTICE OF INTENTION TO DRILL	<input checked="" type="checkbox"/>	SUBSEQUENT REPORT OF WATER SHUT-OFF	
NOTICE OF INTENTION TO CHANGE PLANS	<input type="checkbox"/>	SUBSEQUENT REPORT OF SHOOTING OR ACIDIZING	
NOTICE OF INTENTION TO TEST WATER SHUT-OFF		SUBSEQUENT REPORT OF ALTERING CASING	
NOTICE OF INTENTION TO RE-DRILL OR REPAIR WELL		SUBSEQUENT REPORT OF RE-DRILLING OR REPAIR	
NOTICE OF INTENTION TO SHOOT OR ACIDIZE		SUBSEQUENT REPORT OF ABANDONMENT	
NOTICE OF INTENTION TO PULL OR ALTER CASING		SUPPLEMENTARY WELL HISTORY	
NOTICE OF INTENTION TO ABANDON WELL			

(INDICATE ABOVE BY CHECK MARK NATURE OF REPORT, NOTICE, OR OTHER DATA)

Well No. 31 is located 1650 ft. from N line and 1650 ft. from E line of sec. 19
31-1650-1650 (Range) 31 (Meridian) N.M. (State or Territory)
Loco Hills (Field) Loco (County or Subdivision)

The elevation of the derrick floor above sea level is 3599 ft.

DETAILS OF WORK

(State names of and expected depths to objective sands; show sizes, weights, and lengths of proposed casings; indicate mudding jobs, cementing points, and all other important proposed work)

On or about Sep't. 8 1958 plan to spud well and drill to and set approx. 480' of 8 1/2" 21# new seamless casing cementing with 30 sacks cement and 50 sacks mud. After cement sets 72 hrs. will drill cement plug and test for water shutoff. Plan to drill to and set approx. 2950' of 7" O.D. 20# seamless casing cementing with 100 sacks cement and 100 sacks mud. Plan to complete well in the Loco Hills sand at approx. 3000'.

RECEIVED
SEP 9 1958
U. S. GEOLOGICAL SURVEY
ARTESIA, NEW MEXICO

I understand that this plan of work must receive approval in writing by the Geological Survey before operations may be commenced.

Company Franklin Lston & Fair
Address Box 218 Loco Hills N.M.

By D. C. Rogers
Title Gen'l. Sup't.

NEW MEXICO OIL CONSERVATION COMMISSION

Well Location and Acreage Dedication Plat

Section A.

Date Sept. 6, 1958

Operator Franklin, Aston & Fair, Inc. Lease LC 063621 (Master)
Well No. 3-A Unit Letter J Section 8 Township 18 N Range 30 E NMPM
Located 1650 Feet From South Line, 1650 Feet From East Line
County Eddy G. L. Elevation 3499 Dedicated Acreage 40 Acres
Name of Producing Formation _____ Pool _____

1. Is the Operator the only owner* in the dedicated acreage outlined on the plat below?
Yes _____ No _____.
2. If the answer to question one is "no," have the interests of all the owners been consolidated by communitization agreement or otherwise? Yes _____ No _____. If answer is "yes," Type of Consolidation _____
3. If the answer to question two is "no," list all the owners and their respective interests below:

Owner

Land Description

Franklin, Aston & Fair, Inc.

Section 8, Twp. 18 N., Rg. 30 E.

N.M.P.M., Eddy County, New Mexico

Section B

R 30 E

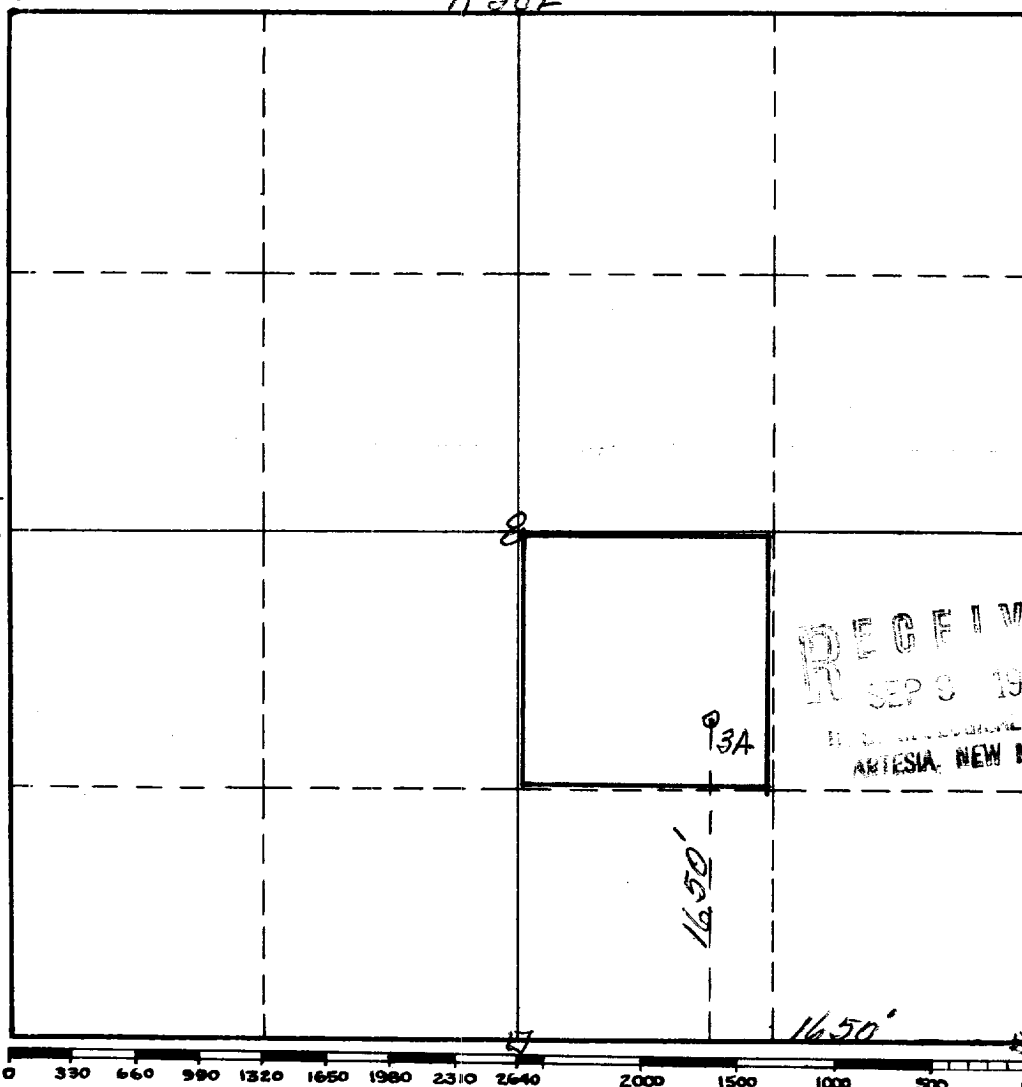

This is to certify that the information in Section A above is true and complete to the best of my knowledge and belief.

Franklin, Aston & Fair, Inc.
(Operator)

R. R. Aston
(Representative)

Box 769, Roswell, New Mexico
Address

This is to certify that the well location shown on the plat in Section B was plotted from field notes of actual surveys made by me or under my supervision and that the same is true and correct to the best of my knowledge and belief.

Date Surveyed Sept 2nd 1958

James H. Brown
Registered Professional
Engineer and/or Land Surveyor.

Certificate No. 542

INSTRUCTIONS FOR COMPLETION

1. Operator shall furnish and certify to the information called for in Section A.
2. Operator shall outline the dedicated acreage for both oil and gas wells on the plat in Section B.
3. A registered professional engineer or land surveyor registered in the State of New Mexico or approved by the Commission shall show on the plat the location of the well and certify this information in the space provided.
4. All distances shown on the plat must be from the outer boundaries of Section.
5. If additional space is needed for listing owners and their respective interests as required in question 3, Section A, please use space below

* "Owner" means the person who has the right to drill into and to produce from any pool and to appropriate the production either for himself or for himself and another. (65-3-29 (e) NMSA 1953 Comp.)