

(SUBMIT IN TRIPLICATE)

Land Office Las CrucesLease No. 01375

Unit _____

RECEIVED**APR 10 1961**
D. C. C.
ARTESIA OFFICE**APPROVED**
MAR 31 1961
R. R. BROWN
ACTING DISTRICT ENGINEER**UNITED STATES
DEPARTMENT OF THE INTERIOR
GEOLOGICAL SURVEY****SUNDRY NOTICES AND REPORTS ON WELLS***Provided USGS is contacted before running
cementing oil string and surface pipe*

NOTICE OF INTENTION TO DRILL.....		SUBSEQUENT REPORT OF WATER SHUT-OFF.....	
NOTICE OF INTENTION TO CHANGE PLANS.....		SUBSEQUENT REPORT OF SHOOTING OR ACIDIZING.....	
NOTICE OF INTENTION TO TEST WATER SHUT-OFF.....		SUBSEQUENT REPORT OF ALTERING CASING.....	
NOTICE OF INTENTION TO RE-DRILL ON <u> </u>	X	SUBSEQUENT REPORT OF RE-DRILLING OR REPAIR.....	
NOTICE OF INTENTION TO SHOOT OR ACIDIZE.....		SUBSEQUENT REPORT OF ABANDONMENT.....	
NOTICE OF INTENTION TO PULL OR ALTER CASING.....		SUPPLEMENTARY WELL HISTORY.....	
NOTICE OF INTENTION TO ABANDON WELL.....			

(INDICATE ABOVE BY CHECK MARK NATURE OF REPORT, NOTICE, OR OTHER DATA)

Well No. 1 is located 400 ft. from N line and 2140 ft. from E line of sec. 25

<u>SE SW</u>	<u>18 S</u>	<u>30 E</u>	<u>N M P M</u>
(1/4 Sec. and Sec. No.)	(Twp.)	(Range)	(Meridian)
<u>Culwin Undesignated</u>	<u>Eddy</u>	<u>N. M.</u>	
(Field)	(County or Subdivision)	(State or Territory)	

The elevation of the derrick floor above sea level is 3550 ft.**DETAILS OF WORK**

(State names of and expected depths to objective sands; show sizes, weights, and lengths of proposed casings; indicate mudding jobs, cementing points, and all other important proposed work)

We propose to re-enter and clean out to a depth of 2550' to test Lower Yates sand. We will run 625' of 7" surface csg. to tie in stub of 8 5/8" csg. and cement with 75 sacks or we will satisfy and requirement the U.S.C.S. has on the surface csg. If production we will run 2550' of 5 1/2" csg. for oil string and cement w/100 sacks.

RECEIVED**MAR 17 1961****SURVEY**
100

I understand that this plan of work must receive approval in writing by the Geological Survey before operations may be commenced.

Company R. Q. SilverthorneAddress 406-08 Skaggs Bldg.Plainview, TexasBy A. D. FrymanTitle Agent - R. Q. Silverthorne

NEW MEXICO OIL CONSERVATION COMMISSION
WELL LOCATION AND ACREAGE DEDICATION PLAT

FORM C 128
 REVISED 1/57
RECEIVED

SEE INSTRUCTIONS FOR COMPLETING THIS FORM ON THE REVERSE SIDE

APR 10 1961

SECTION A

Operator R. Q. Silverthorne			Lease Keinath Fed.		D. B. C. ARTESIA OFFICE
Unit Letter N	Section 25	Township 18 S	Range 30 E	County Eddy	
Actual Footage Location of Well: 400 feet from the S line and 2140 feet from the W line					
Ground Level Elev. 5548	Producing Formation Yates		Pool Culwin Undesignated		Dedicated Acreage: 40 Acres

1. Is the Operator the only owner in the dedicated acreage outlined on the plat below? YES ☒ NO ____ . ("Owner" means the person who has the right to drill into and to produce from any pool and to appropriate the production either for himself or for himself and another. (65-3-29 (e) NMSA 1935 Comp.)
2. If the answer to question one is "no," have the interests of all the owners been consolidated by communitization agreement or otherwise? YES ____ NO ____ . If answer is "yes," Type of Consolidation _____
3. If the answer to question two is "no," list all the owners and their respective interests below:

Owner	Land Description

RECEIVED

MAR 17 1961

U. S. GEOLOGICAL SURVEY
 ARTESIA, N. M.

SECTION B

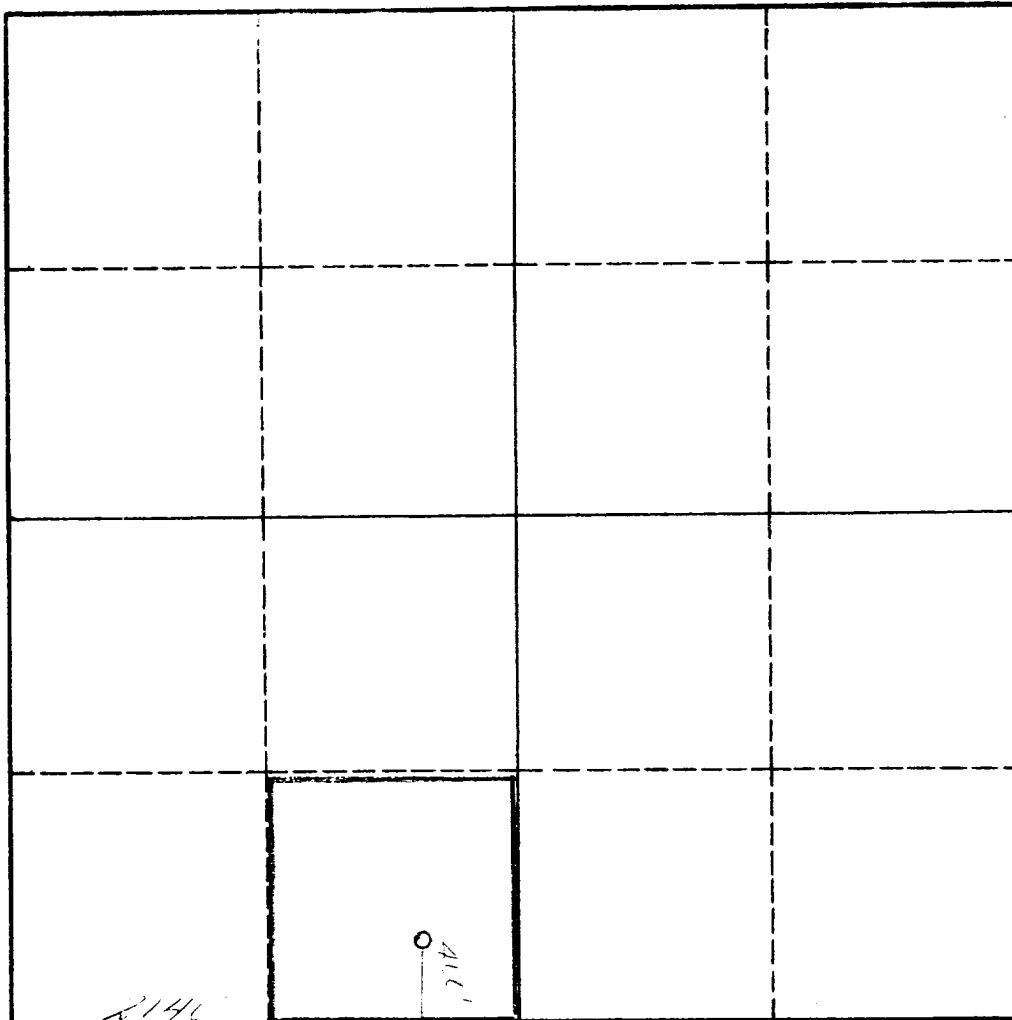

I hereby certify that the information in SECTION A above is true and complete to the best of my knowledge and belief.

Name <i>R. Q. Silverthorne</i>
Position <i>Owner</i>
Company
Date <i>3-15-61</i>

I hereby certify that the well location shown on the plat in SECTION B was plotted from field notes of actual surveys made by me or under my supervision, and that the same is true and correct to the best of my knowledge and belief.

Date Surveyed
Registered Professional Engineer and/or Land Surveyor
Certificate No.

0 330 660 990 1320 1650 1980 2310 2640 2000 1500 1000 500 0

INSTRUCTIONS FOR COMPLETION OF FORM C-128

1. Operator shall furnish and certify to the information called for in Section A.
2. Operator shall outline the dedicated acreage for *both* oil and gas wells on the plat in Section B.
3. A registered professional engineer or land surveyor registered in the State of New Mexico or approved by the Commission shall show on the plat the location of the well and certify this information in the space provided.
4. All distances shown on the plat must be from the outer boundaries of the Section.
5. If additional space is needed for listing owners and their respective interests as required in question 3 of Section A, please use space below.