



134-95

UNITED STATES
DEPARTMENT OF THE INTERIOR
GEOLOGICAL SURVEY

P. O. Drawer 5
Artesia, New Mexico

IN REPLY REFER TO:

RECEIVED
MAY 24 1961
D. C. C.
ARTESIA, OFFICE
May 23, 1961

Reading & Bates, Inc.
1101 Philtower Building
Tulsa, Oklahoma

Gentlemen:

Reference is made to your Notice of Intention to Drill dated April 17, 1961, covering your No. 1 Sims well in the NE1/4 sec. 34, T. 18 S., R. 30 E., N.M.P.M., Eddy County, New Mexico on lease Las Cruces 028978(b) which is in the Secretary's "Potash Area".

The Notice of Intention to Drill the above described well to a depth of approximately 3400 feet to test the Grayburg formation is hereby approved. Please notify this office in sufficient time for a representative to witness all cementing operations.

Very truly yours,

(Orig. 531) ARTHUR R. BROWN

Arthur R. Brown
Acting District Engineer

Enclosure

ARRBrown:gs 5/23/61

Copy to: Washington
Artesia
NMOCG, Artesia (2) ✓
Mining Supervisor, Carlsbad (2)
Roswell file

UNITED STATES
DEPARTMENT OF THE INTERIOR
GEOLOGICAL SURVEY



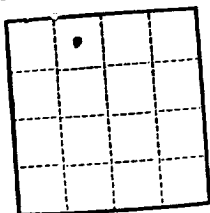

(SUBMIT IN TRIPLICATE)

UNITED STATES
DEPARTMENT OF THE INTERIOR
GEOLOGICAL SURVEYLand Office Santa Fe
Lease No. LC-028978-1(6)
Unit DRECEIVED
MAY 24 1961D. C. C.
ARTESIA, OFFICE

SUNDRY NOTICES AND REPORTS ON WELLS

NOTICE OF INTENTION TO DRILL	<input checked="" type="checkbox"/>	SUBSEQUENT REPORT OF WATER SHUT-OFF	
NOTICE OF INTENTION TO CHANGE PLANS		SUBSEQUENT REPORT OF SHOOTING OR ACIDIZING	
NOTICE OF INTENTION TO TEST WATER SHUT-OFF		SUBSEQUENT REPORT OF ALTERING CASING	
NOTICE OF INTENTION TO RE-DRILL OR REPAIR WELL		SUBSEQUENT REPORT OF RE-DRILLING OR REPAIR	
NOTICE OF INTENTION TO SHOOT OR ACIDIZE		SUBSEQUENT REPORT OF ABANDONMENT	
NOTICE OF INTENTION TO PULL OR ALTER CASING		SUPPLEMENTARY WELL HISTORY	
NOTICE OF INTENTION TO ABANDON WELL			

(INDICATE ABOVE BY CHECK MARK NATURE OF REPORT, NOTICE, OR OTHER DATA)

Well No. 1 Simms-Federal is located 660 ft. from [N] line and 1980 ft. from [W] line of sec. 34
NW $\frac{1}{4}$ of Section 34 18-S 30-E N.M.P.M.
($\frac{1}{4}$ Sec. and Sec. No.) (Twp.) (Range) (Meridian)
North Benson Eddy New Mexico
(Field) (County or Subdivision) (State or Territory)

The elevation of the derrick floor above sea level is _____ ft.

DETAILS OF WORK

(State names of and expected depths to objective sands; show sizes, weights, and lengths of proposed casings; indicate mudding jobs, cementing points, and all other important proposed work)

Set 24 lb. 8-5/8 casing in top of salt at approximately 600 feet and circulate mud in front of 50 sacks of cement. Drill to an approximate total depth of 3400 feet to test Grayburg sands. Queen sands at 2800 feet and 3000 feet will also be tested. This well will be drilled with cable tools. New 14 lb. J-55 5 1/2" pipe will be run to total depth with mud circulated before 150 sacks of cement. Pipe will be perforated opposite pay zone and section fractured.

RECEIVED

APR 19 1961

U. S. GEOLOGICAL SURVEY
ARTESIA, NEW MEXICO

I understand that this plan of work must receive approval in writing by the Geological Survey before operations may be commenced.

Company Reading & Bates, Inc.
Address 1101 Philtower Building
Tulsa, OklahomaBy L. B. Burleson
Lewis B. Burleson
Title Agent

NEW MEXICO OIL CONSERVATION COMMISSION
WELL LOCATION AND ACREAGE DEDICATION PLAT

FORM 1-57
MAY 17 1961

SEE INSTRUCTIONS FOR COMPLETING THIS FORM ON THE REVERSE SIDE

SECTION A

Operator Reading & BATES, INC. ET AL		Lease Simms -MANNING-FEDERAL		Well No. 71 C. C.
Unit Letter C	Section 34	Township 18 SOUTH	Range 30 EAST	County EDDY
Actual Footage Location of Well: 660 feet from the North line and 1980 feet from the West line				
Ground Level Elev. 3458.8	Producing Formation	Pool	Dedicated Acreage: _____ Acres	

1. Is the Operator the only owner in the dedicated acreage outlined on the plat below? YES _____ NO _____. ("Owner" means the person who has the right to drill into and to produce from any pool and to appropriate the production either for himself or for himself and another. (65-3-29 (e) NMSA 1935 Comp.)
2. If the answer to question one is "no," have the interests of all the owners been consolidated by communitization agreement or otherwise? YES _____ NO _____. If answer is "yes," Type of Consolidation _____
3. If the answer to question two is "no," list all the owners and their respective interests below:

Owner	Land Description

SECTION B

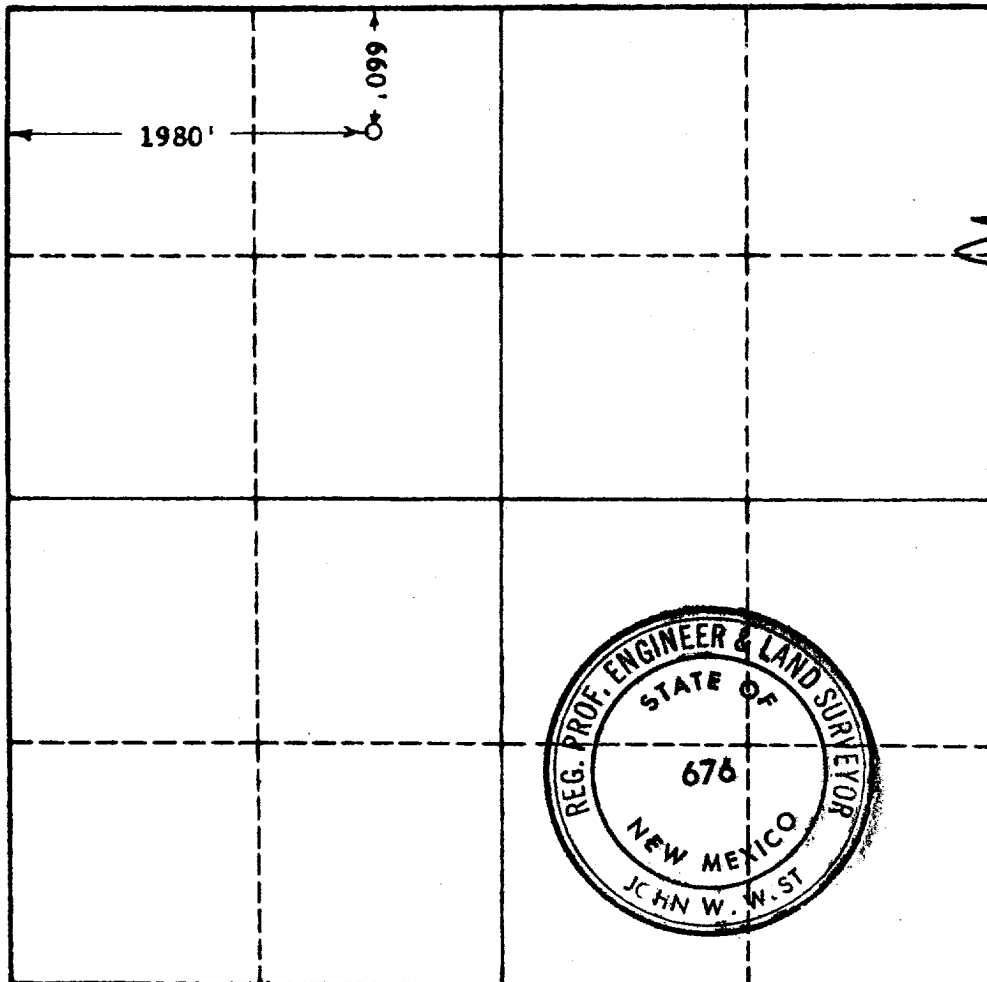

I hereby certify that the information in SECTION A above is true and complete to the best of my knowledge and belief.

Name	J. P. Exploration
Position	V-P. Exploration
Company	Reading & Bates, Inc
Date	5-15-61

I hereby certify that the well location shown on the plat in SECTION B was plotted from field notes of actual surveys made by me or under my supervision, and that the same is true and correct to the best of my knowledge and belief.

MAY 17 1961

Date Surveyed	4-20-1961
Registered Professional Engineer and/or Land Surveyor,	JOHN W. WEST
Certificate No.	N.M. - P.E. & L.S. NO. 676

