



IN REPLY REFER TO:

*copy to S.F.*

UNITED STATES  
DEPARTMENT OF THE INTERIOR  
GEOLOGICAL SURVEY  
Drawer 1857  
Roswell, New Mexico

December 18, 1961

Reading and Bates, Inc.  
1101 Philhower Building  
Tulsa 3, Oklahoma

Gentlemen:

Your Notice of Intention to Drill well No. 2 Jones-Federal (copy attached) in the SW1/4 sec. 34, T. 18 S., R. 30 E., N.M.P.M., Eddy County, New Mexico, lease Las Cruces 058650, has been forwarded to this office for approval.

Pursuant to authority delegated to me by the Director, Geological Survey on July 26, 1961, I hereby approve the Notice of Intention to Drill well No. 2 Jones-Federal to a depth of 3,150 feet to test the Queen formation.

Please notify the District Engineer, Geological Survey, Drawer U, Artesia, New Mexico, in sufficient time for a representative to witness all commencing operations.

Very truly yours,

(Orig. Sgd.) JOHN A. ANDERSON

JOHN A. ANDERSON  
Regional Oil and Gas Supervisor

Copy to: Washington (w/cy Notice)  
Mining Branch (2) (w/2 cys Notice)  
✓ NMCC-Artesia (2) (w/2 cys Notice)  
Artesia (w/cy Notice)  
Roswell Office Copy

RECEIVED

DEC 20 1961

D. C. C.  
ARTESIA, OFFICE

UNITED STATES  
DEPARTMENT OF THE INTERIOR  
GEOLOGICAL SURVEY



RECEIVED  
DEC 20 1961

U.S. GEOLOGICAL SURVEY  
WASHINGTON, D.C.

TO: DIRECTOR, U.S. GEOLOGICAL SURVEY  
FROM: [illegible]  
SUBJECT: [illegible]

[illegible text block]

[illegible text block]

[illegible text block]

[illegible text block]

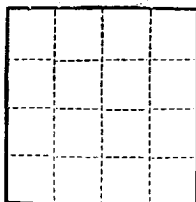

(SUBMIT IN TRIPLICATE)

UNITED STATES  
DEPARTMENT OF THE INTERIOR  
GEOLOGICAL SURVEY

Land Office **Las Cruces**  
Lease No. **058650**  
Unit \_\_\_\_\_

**SUNDRY NOTICES AND REPORTS ON WELLS**

NOTICE OF INTENTION TO DRILL.....	<input checked="" type="checkbox"/>	SUBSEQUENT REPORT OF WATER SHUT-OFF.....
NOTICE OF INTENTION TO CHANGE PLANS.....		SUBSEQUENT REPORT OF SHOOTING OR ACIDIZING.....
NOTICE OF INTENTION TO TEST WATER SHUT-OFF.....		SUBSEQUENT REPORT OF ALTERING CASING.....
NOTICE OF INTENTION TO RE-DRILL OR REPAIR WELL.....		SUBSEQUENT REPORT OF RE-DRILLING OR REPAIR.....
NOTICE OF INTENTION TO SHOOT OR ACIDIZE.....		SUBSEQUENT REPORT OF ABANDONMENT.....
NOTICE OF INTENTION TO PULL OR ALTER CASING.....		SUPPLEMENTARY WELL HISTORY.....
NOTICE OF INTENTION TO ABANDON WELL.....		

(INDICATE ABOVE BY CHECK MARK NATURE OF REPORT, NOTICE, OR OTHER DATA)

**December 4**, 19**61**

**Jones - Federal**

Well No. **# 2** is located **1650** ft. from **[N]** line and **2310** ft. from **[E]** line of sec. **34**

**SW/4 NE/4**

(1/4 Sec. and Sec. No.)

**North Benson**

(Field)

**18 S**

(Twp.)

**30 E**

(Range)

**N. M. P. M.**

(Meridian)

**Eddy**

(County or Subdivision)

**New Mexico**

(State or Territory)

The elevation of the derrick floor above sea level is \_\_\_\_\_ ft.

**DETAILS OF WORK**

(State names of and expected depths to objective sands; show sizes, weights, and lengths of proposed casings; indicate mudding jobs, cementing points, and all other important proposed work)

**Drill with rotary tools as follows:**

**Drill 11" hole to approximately 630'. Set 8 5/8" 24# casing to top of Salt at 600'. Cement with 100 sacks. Drill 7 7/8" hole to approximately 3150' to test Basal Green Sand zones. Set 4 1/2" 9.5# pipe to T.D. set with 200 sacks. Pipe to be perforated opposite selected pay zones and treated by fracturing.**

**RECEIVED**  
DEC 15 1961  
U. S. GEOLOGICAL SURVEY  
ROSWELL, NEW MEXICO

**RECEIVED**

**DEC 6 1961**

**U. S. GEOLOGICAL SURVEY  
ARTESIA, NEW MEXICO**

I understand that this plan of work must receive approval in writing by the Geological Survey before operations may be commenced.

Company **Reading and Bates, Inc.**

Address **1101 Philtower Building**

**Tulsa 3, Oklahoma**

By **I. J. Pierce**  
Title **Vice President, Exploration**

NUMBER OF COPIES RECEIVED	
DISTRIBUTION	
SALE TAX	
F.I.E.	
U.S.G.S.	
LAND OFFICE	
TRANSPORTER	OIL GAS
PRODUCTION OFFICE	
OPERATOR	

**NEW MEXICO OIL CONSERVATION COMMISSION**  
**WELL LOCATION AND ACREAGE DEDICATION PLAT**  
 SEE INSTRUCTIONS FOR COMPLETING THIS FORM ON THE REVERSE SIDE

FORM C-128  
 Revised 5/1/57

**SECTION A**

Operator <b>Reading &amp; Bates</b>		Lease <b>Jones Fed.</b>		Well No. <b>2</b>	
Unit Letter <b>"G"</b>	Section <b>34</b>	Township <b>18 S</b>	Range <b>30 E</b>	County <b>Sady</b>	
Actual Footage Location of Well: <b>1650</b> feet from the <b>N</b> line and <b>2310</b> feet from the <b>E</b> line					
Ground Level Elev.	Producing Formation <b>Queen</b>		Pool <b>North Benson</b>	Dedicated Acreage: <b>40</b> Acres	

1. Is the Operator the only owner in the dedicated acreage outlined on the plat below? YES ☒ NO \_\_\_\_ . ("Owner" means the person who has the right to drill into and to produce from any pool and to appropriate the production either for himself or for himself and another. (65-3-29 (e) NMSA 1935 Comp.)
2. If the answer to question one is "no," have the interests of all the owners been consolidated by communitization agreement or otherwise? YES \_\_\_\_ NO \_\_\_\_ . If answer is "yes," Type of Consolidation \_\_\_\_\_
3. If the answer to question two is "no," list all the owners and their respective interests below:

**RECEIVED**

Owner	Land Description	<b>DEC 11 1961</b>
		<b>U. S. GEOLOGICAL SURVEY</b>
		<b>ARTESIA, NEW MEXICO</b>

**SECTION B**

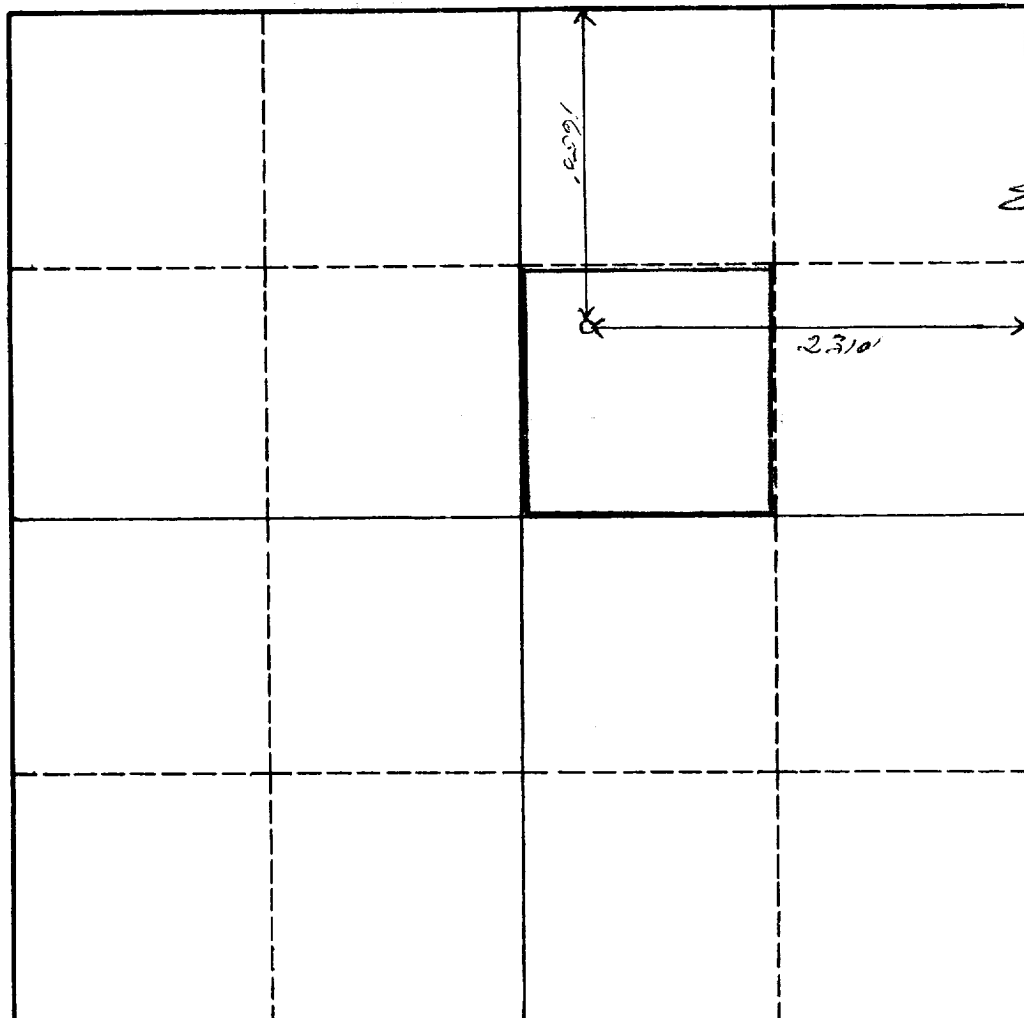

**CERTIFICATION**

I hereby certify that the information in SECTION A above is true and complete to the best of my knowledge and belief.

Name **E. J. Piarce**  
 Position **Vice President, Exploration**  
 Company **Reading and Bates, Inc.**  
 Date **December 1, 1961**

I hereby certify that the well location shown on the plat in SECTION B was plotted from field notes of actual surveys made by me or under my supervision, and that the same is true and correct to the best of my knowledge and belief.

Date Surveyed **11/24/61**  
 Registered Professional Engineer and/or Land Surveyor

Certificate No. **772**

0 330 660 990 1320 1650 1980 2310 2640 2000 1500 1000 500 0

## INSTRUCTIONS FOR COMPLETION OF FORM C-128

1. Operator shall furnish and certify to the information called for in Section A.
2. Operator shall outline the dedicated acreage for *both* oil and gas wells on the plat in Section B.
3. A registered professional engineer or land surveyor registered in the State of New Mexico or approved by the Commission shall show on the plat the location of the well and certify this information in the space provided.
4. All distances shown on the plat must be from the outer boundaries of the Section.
5. If additional space is needed for listing owners and their respective interests as required in question 3 of Section A, please use space below.