

(SUBMIT IN TRIPLICATE)

UNITED STATES
DEPARTMENT OF THE INTERIOR
GEOLOGICAL SURVEY

Land Office Santa Fe
Lease No. LC 058650
Unit B

RECEIVED
JUL 26 1961

SUNDRY NOTICES AND REPORTS ON WELLS

O. C. C.
ARTESIA, DISTRICT

NOTICE OF INTENTION TO DRILL	<input checked="" type="checkbox"/>	SUBSEQUENT REPORT OF WATER SHUT-OFF	
NOTICE OF INTENTION TO CHANGE PLANS		SUBSEQUENT REPORT OF SHOOTING OR ACIDIZING	
NOTICE OF INTENTION TO TEST WATER SHUT-OFF		SUBSEQUENT REPORT OF ALTERING CASING	
NOTICE OF INTENTION TO RE-DRILL OR REPAIR WELL		SUBSEQUENT REPORT OF RE-DRILLING OR REPAIR	
NOTICE OF INTENTION TO SHOOT OR ACIDIZE		SUBSEQUENT REPORT OF ABANDONMENT	
NOTICE OF INTENTION TO PULL OR ALTER CASING		SUPPLEMENTARY WELL HISTORY	
NOTICE OF INTENTION TO ABANDON WELL			

(INDICATE ABOVE BY CHECK MARK NATURE OF REPORT, NOTICE, OR OTHER DATA)

June 28, 19 61

Well No. 1- Jones Fed. 34-3 is located 660 ft. from N line and 1980 ft. from E line of sec. 34

N.E. 1/4 of section 34 18-S 30-A M.A.P.M.
(1/4 Sec. and Sec. No.) (Twp.) (Range) (Meridian)

Undesignated Eddy New Mexico
(Field) (County or Subdivision) (State or Territory)

The elevation of the derrick floor above sea level is _____ ft.

DETAILS OF WORK

(State names of and expected depths to objective sands; show sizes, weights, and lengths of proposed casings; indicate mudding jobs, cementing points, and all other important proposed work)

Set 24 lb. 8-5/8 casing in top of salt at approximately 600 feet and circulate mud in front of 50 sacks of cement. Drill to an approximate total depth of 3400 feet to test Grayburg sands. Green sands at 2800 feet and 3000 feet will also be tested. This well will be drilled with cable tools. 14 lb. J-55 5 1/2" pipe will be run to total depth with mud circulated before 150 sacks of cement. Pipe will be perforated opposite pay zone and section fractured.

RECEIVED

JUL 3 1961

U. S. GEOLOGICAL SURVEY
ARTESIA, NEW MEXICO

I understand that this plan of work must receive approval in writing by the Geological Survey before operations may be commenced.

Company Reading & Bates, Inc.

Address 1101 Philtower Building

Tulsa, Oklahoma

By Jack Huff
Title Agent

NUMBER OF COPIES RECEIVED	
DISTRIBUTION	
SANTA FE	
FILE	
U.S.G.S.	
LAND OFFICE	
TRANSPORTER	OIL
	GAS
PRODUCTION OFFICE	
OPERATOR	

NEW MEXICO OIL CONSERVATION COMMISSION
WELL LOCATION AND ACREAGE DEDICATION PLAT
 SEE INSTRUCTIONS FOR COMPLETING THIS FORM ON THE REVERSE SIDE

FORM C-128
 Revised 5/7/57

JUL 26 1961

D. C. C.
ARTESIA OFFICE

SECTION A

Operator Reading & Bates		Lease James Fed. 34-2		Well No. 1
Unit Letter B	Section 34	Township 18 N	Range 30 E	County El Paso
Actual Footage Location of Well: 660 feet from the N line and 1980 feet from the E line				
Ground Level Elev.	Producing Formation Queen	Pool Undesignated	Dedicated Acreage: 60 Acres	

1. Is the Operator the only owner in the dedicated acreage outlined on the plat below? YES NO ____ . ("Owner" means the person who has the right to drill into and to produce from any pool and to appropriate the production either for himself or for himself and another. (65-3-29 (e) NMSA 1935 Comp.)
2. If the answer to question one is "no," have the interests of all the owners been consolidated by communization agreement or otherwise? YES ____ NO ____ . If answer is "yes," Type of Consolidation _____
3. If the answer to question two is "no," list all the owners and their respective interests below:

RECEIVED

JUL 3 1961

U. S. GEOLOGICAL SURVEY
 ARTESIA, NEW MEXICO

Owner	Land Description

SECTION B

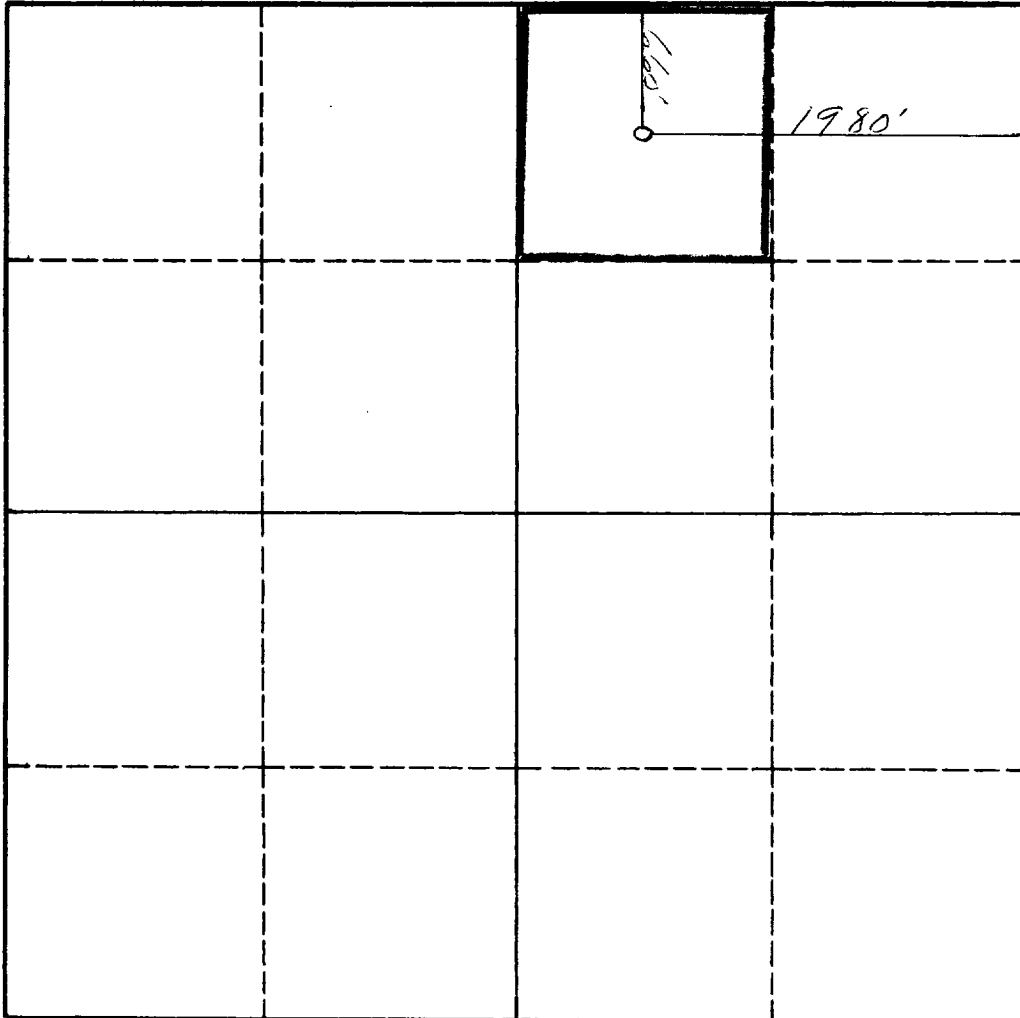

CERTIFICATION

I hereby certify that the information in SECTION A above is true and complete to the best of my knowledge and belief.

Name	<i>J. C. Yates</i>
Position	<i>Agent</i>
Company	<i>Reading & Bates, Inc.</i>
Date	<i>6-28-61</i>

I hereby certify that the well location shown on the plat in SECTION B was plotted from field notes of actual surveys made by me or under my supervision, and that the same is true and correct to the best of my knowledge and belief.

Date Surveyed	<i>6/26/61</i>
Registered Professional Engineer and/or Land Surveyor	<i>J. C. Yates</i>
Certificate No.	<i>112</i>

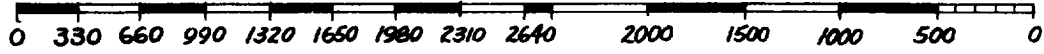

INSTRUCTIONS FOR COMPLETION OF FORM C-128

1. Operator shall furnish and certify to the information called for in Section A.
2. Operator shall outline the dedicated acreage for *both* oil and gas wells on the plat in Section B.
3. A registered professional engineer or land surveyor registered in the State of New Mexico or approved by the Commission shall show on the plat the location of the well and certify this information in the space provided.
4. All distances shown on the plat must be from the outer boundaries of the Section.
5. If additional space is needed for listing owners and their respective interests as required in question 3 of Section A, please use space below.