

*Artesia*

RECEIVED

SEP 11 1961

O. C. C.  
ARTESIA, OFFICE

Bunker 1857  
Roswell, New Mexico

September 6, 1961

Reading and Bates, Inc.  
1101 Philhower Building  
Tulsa, Oklahoma

Gentlemen:

Your revised Notice (dated September 1, 1961) of Intention to Drill well No. 1 Tusas-Federal in the NE $\frac{1}{4}$  sec. 34, T. 18 S., R. 30 E., N.M.P.M., Eddy County, New Mexico, Lease New Mexico 03894, has been forwarded to this office for approval.

Pursuant to authority delegated to me by the Director, Geological Survey, on July 26, 1961, I hereby approve said notice to drill the well to a depth of approximately 3,123 feet to test the Queen Sand.

Please notify the District Engineer, U. S. Geological Survey, Bunker 5, Artesia, New Mexico, in sufficient time for a representative to witness all cementing operations.

Very truly yours,

(Orig. Sgd.) JOHN A. ANDERSON

JOHN A. ANDERSON  
Regional Oil and Gas Supervisor

Copy to: Washington (w/cy Notice)  
Mining Branch (1) (w/2 cys Notice)  
MMSU-Artesia (2) (w/2 cys Notice)  
Artesia (w/cy Notice)  
Roswell office copy

RECEIVED

SEP 11 1961

ARTS & CRAFTS  
OFFICE

Project No. 100-100000

Section 100-100000  
100-100000  
100-100000

Section 100-100000

The project is a study of the history and development of the arts and crafts in the United States. The project is a study of the history and development of the arts and crafts in the United States. The project is a study of the history and development of the arts and crafts in the United States.

The project is a study of the history and development of the arts and crafts in the United States. The project is a study of the history and development of the arts and crafts in the United States. The project is a study of the history and development of the arts and crafts in the United States.

The project is a study of the history and development of the arts and crafts in the United States. The project is a study of the history and development of the arts and crafts in the United States. The project is a study of the history and development of the arts and crafts in the United States.

Very truly yours,

(Sgt. 100-100000)

Very truly yours,

Regional Office and General Supervision

Copy for: Washington (W/Cy Notice)  
Minneapolis (W/Cy Notice)  
St. Paul (W/Cy Notice)  
St. Paul (W/Cy Notice)  
St. Paul (W/Cy Notice)  
St. Paul (W/Cy Notice)

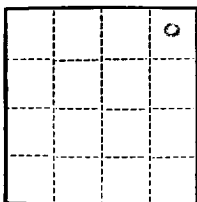

(SUBMIT IN TRIPLICATE)

Land Office Santa Fe

UNITED STATES  
DEPARTMENT OF THE INTERIOR  
GEOLOGICAL SURVEY

Lease No. 22103894

Unit A

**RECEIVED**

OCT 16 1951

D. E. G.  
ARTESIA, OFFICE

**SUNDRY NOTICES AND REPORTS ON WELLS**

NOTICE OF INTENTION TO DRILL <u>Change Plans</u>	<input checked="" type="checkbox"/>	SUBSEQUENT REPORT OF WATER SHUT-OFF	
NOTICE OF INTENTION TO CHANGE PLANS		SUBSEQUENT REPORT OF SHOOTING OR ACIDIZING	
NOTICE OF INTENTION TO TEST WATER SHUT-OFF		SUBSEQUENT REPORT OF ALTERING CASING	
NOTICE OF INTENTION TO RE-DRILL OR REPAIR WELL		SUBSEQUENT REPORT OF RE-DRILLING OR REPAIR	
NOTICE OF INTENTION TO SHOOT OR ACIDIZE		SUBSEQUENT REPORT OF ABANDONMENT	
NOTICE OF INTENTION TO PULL OR ALTER CASING		SUPPLEMENTARY WELL HISTORY	
NOTICE OF INTENTION TO ABANDON WELL			

(INDICATE ABOVE BY CHECK MARK NATURE OF REPORT, NOTICE, OR OTHER DATA)

September 1, 1951

Texaco - Federal

Well No. \_\_\_\_\_ is located 495 ft. from N line and 820 ft. from E line of sec. 34

20/4 Section 34  
(1/4 Sec. and Sec. No.)

T 18 S, R 30 E  
(Twp.) (Range)

10N 10W  
(Meridian)

Undesignated  
(Field)

Eddy  
(County or Subdivision)

New Mexico  
(State or Territory)

The elevation of the derrick floor above sea level is 3460 ft.

**DETAILS OF WORK**

(State names of and expected depths to objective sands; show sizes, weights, and lengths of proposed casings; indicate mudding jobs, cementing points, and all other important proposed work)

Intent to drill previously filed with Cable Tools. We will use Potary Tools. set 24 1/2" 8 5/8" surface casing in top of salt at approximately 600', cement 8 5/8" with 100 sacks. Drill to 3.25' to test basal Queen Sand, run approximately 3100' of 4 1/2" or 5 1/2" J-55 pipe, cemented with 200 sacks. Pipe to be perforated opposite selected pay zone and section fractured.

I understand that this plan of work must receive approval in writing by the Geological Survey before operations may be commenced.

Company Reading and Bates, Inc.,

Address 100 Philtower Bldg.,

OKLAHOMA.

By

J. J. Pierce

Title

Vice-President, Exploration

NUMBER OF COPIES RECEIVED	
DISTRIBUTION	
SANTA FE	
FILE	
U.S.G.S.	
LAND OFFICE	
TRANSPORTER	OIL GAS
PRODUCTION OFFICE	
OPERATOR	

**NEW MEXICO OIL CONSERVATION COMMISSION**  
**WELL LOCATION AND ACREAGE DEDICATION PLAT**  
 SEE INSTRUCTIONS FOR COMPLETING THIS FORM ON THE REVERSE SIDE

FORM C-128  
Revised 5/1/57

**OCT 16 1961**

**SECTION A**

Operator <b>Reading &amp; Bates</b>		Lease <b>Texasco Fed.</b>		Well No. <b>ARTESIA, OFFICE 1</b>	
Unit Letter <b>A</b>	Section <b>34</b>	Township <b>18 S</b>	Range <b>30 E</b>	County <b>Eddy</b>	
Actual Footage Location of Well: <b>195</b> feet from the <b>N</b> line and <b>820</b> feet from the <b>E</b> line					
Ground Level Elev. <b>3448</b>	Producing Formation <b>Queen</b>		Pool <b>Undesignated</b>		Dedicated Acreage: <b>40</b> Acres

1. Is the Operator the only owner in the dedicated acreage outlined on the plat below? YES ☒ NO \_\_\_\_ . ("Owner" means the person who has the right to drill into and to produce from any pool and to appropriate the production either for himself or for himself and another. (65-3-29 (e) NMSA 1935 Comp.)
2. If the answer to question one is "no," have the interests of all the owners been consolidated by communitization agreement or otherwise? YES \_\_\_\_ NO \_\_\_\_ . If answer is "yes," Type of Consolidation \_\_\_\_\_
3. If the answer to question two is "no," list all the owners and their respective interests below:

Owner	Land Description

**SECTION B**

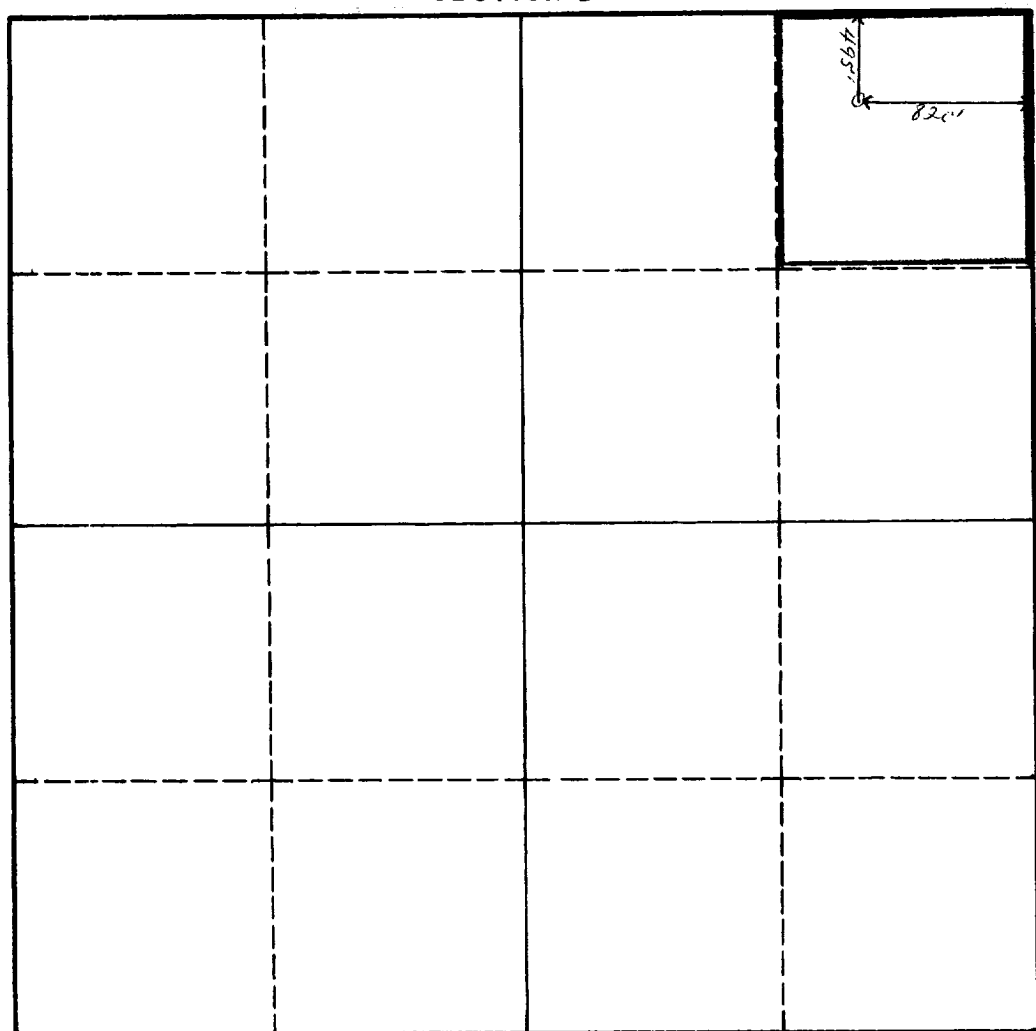

**CERTIFICATION**

I hereby certify that the information in SECTION A above is true and complete to the best of my knowledge and belief.

Name *John*  
 Position *Well Owner*  
 Company *Reading & Bates, Inc.*  
 Date *9-1-61*

I hereby certify that the well location shown on the plat in SECTION B was plotted from field notes of actual surveys made by me or under my supervision, and that the same is true and correct to the best of my knowledge and belief.

Date Surveyed  
*8/23/61*  
 Registered Professional Engineer  
 and/or Land Surveyor

*N. C. Yates*  
 Certificate No. *772*

0 330 660 990 1320 1650 1980 2310 2640 2000 1500 1000 500 0

### INSTRUCTIONS FOR COMPLETION OF FORM C-128

1. Operator shall furnish and certify to the information called for in Section A.
2. Operator shall outline the dedicated acreage for *both* oil and gas wells on the plat in Section B.
3. A registered professional engineer or land surveyor registered in the State of New Mexico or approved by the Commission shall show on the plat the location of the well and certify this information in the space provided.
4. All distances shown on the plat must be from the outer boundaries of the Section.
5. If additional space is needed for listing owners and their respective interests as required in question 3 of Section A, please use space below.