

(SUBMIT IN TRIPLICATE)

UNITED STATES
DEPARTMENT OF THE INTERIOR
GEOLOGICAL SURVEY

Land Office **Las Cruces**
Lease No. **029415(b)**
Unit **RECEIVED**

MAY 2 1960

SUNDRY NOTICES AND REPORTS ON WELLS **E. C. C.**
ARTESIA, OFFICE

NOTICE OF INTENTION TO DRILL.....	<input checked="" type="checkbox"/>	SUBSEQUENT REPORT OF WATER SHUT-OFF.....	
NOTICE OF INTENTION TO CHANGE PLANS.....		SUBSEQUENT REPORT OF SHOOTING OR ACIDIZING.....	
NOTICE OF INTENTION TO TEST WATER SHUT-OFF.....		SUBSEQUENT REPORT OF ALTERING CASING.....	
NOTICE OF INTENTION TO RE-DRILL OR REPAIR WELL.....		SUBSEQUENT REPORT OF RE-DRILLING OR REPAIR.....	
NOTICE OF INTENTION TO SHOOT OR ACIDIZE.....		SUBSEQUENT REPORT OF ABANDONMENT.....	
NOTICE OF INTENTION TO PULL OR ALTER CASING.....		SUPPLEMENTARY WELL HISTORY.....	
NOTICE OF INTENTION TO ABANDON WELL.....			

(INDICATE ABOVE BY CHECK MARK NATURE OF REPORT, NOTICE, OR OTHER DATA)

Puckett "B" April 25th, 19 **60**
Well No. **15** is located **1980** ft. from **[N]** line and **660** ft. from **[W]** line of sec. **25**
Range 25 **17S** **31E** **NMPN**
(1/4 Sec. and Sec. No.) (Twp.) (Range) (Meridian)
Maljamar **Edgy** **New Mexico**
(Field) (County or Subdivision) (State or Territory)

The elevation of the derrick floor above sea level is ft.

DETAILS OF WORK

(State names of and expected depths to objective sands; show sizes, weights, and lengths of proposed casings; indicate mudding jobs, cementing points, and all other important proposed work)

We will set approximately 600 feet of 8 5/8" 94# casing and cement with 50 sacks cement. We will set approximately 4,000 feet of 4 1/2" of 5 1/2 inch casing and cement with 200 sacks of cement. We will drill with cable tools to a depth of approximately 4,000 feet to test the San Andres Formation, and complete the well through perforations.

I understand that this plan of work must receive approval in writing by the Geological Survey before operations may be commenced.

Company **WILLIAM A. & EDWARD R. HUDSON**

Address **1810 Electric Building**

Fort Worth, Texas

By

Title

NEW MEXICO OIL CONSERVATION COMMISSION
WELL LOCATION AND ACREAGE DEDICATION PLAT

FORM C-128
 Revised 5/1/57

SEE INSTRUCTIONS FOR COMPLETING THIS FORM ON THE REVERSE SIDE

SECTION A

Operator William A. & Edward R. Hudson			Lease Puckett B		Well No. 15
Unit Letter E	Section 25	Township 17 South	Range 31 East	County Eddy	
Actual Footage Location of Well: 660 feet from the West line and 1980 feet from the North line					
Ground Level Elev. San Andres	Producing Formation San Andres		Pool Maljamar	Dedicated Acreage: 40 Acres	

1. Is the Operator the only owner in the dedicated acreage outlined on the plat below? YES ☒ NO ☐ . ("Owner" means the person who has the right to drill into and to produce from any pool and to appropriate the production either for himself or for himself and another. (65-3-29 (e) NMSA 1935 Comp.)
2. If the answer to question one is "no," have the interests of all the owners been consolidated by communitization agreement or otherwise? YES ☐ NO ☐ . If answer is "yes," Type of Consolidation _____
3. If the answer to question two is "no," list all the owners and their respective interests below:

Owner	Land Description

SECTION B

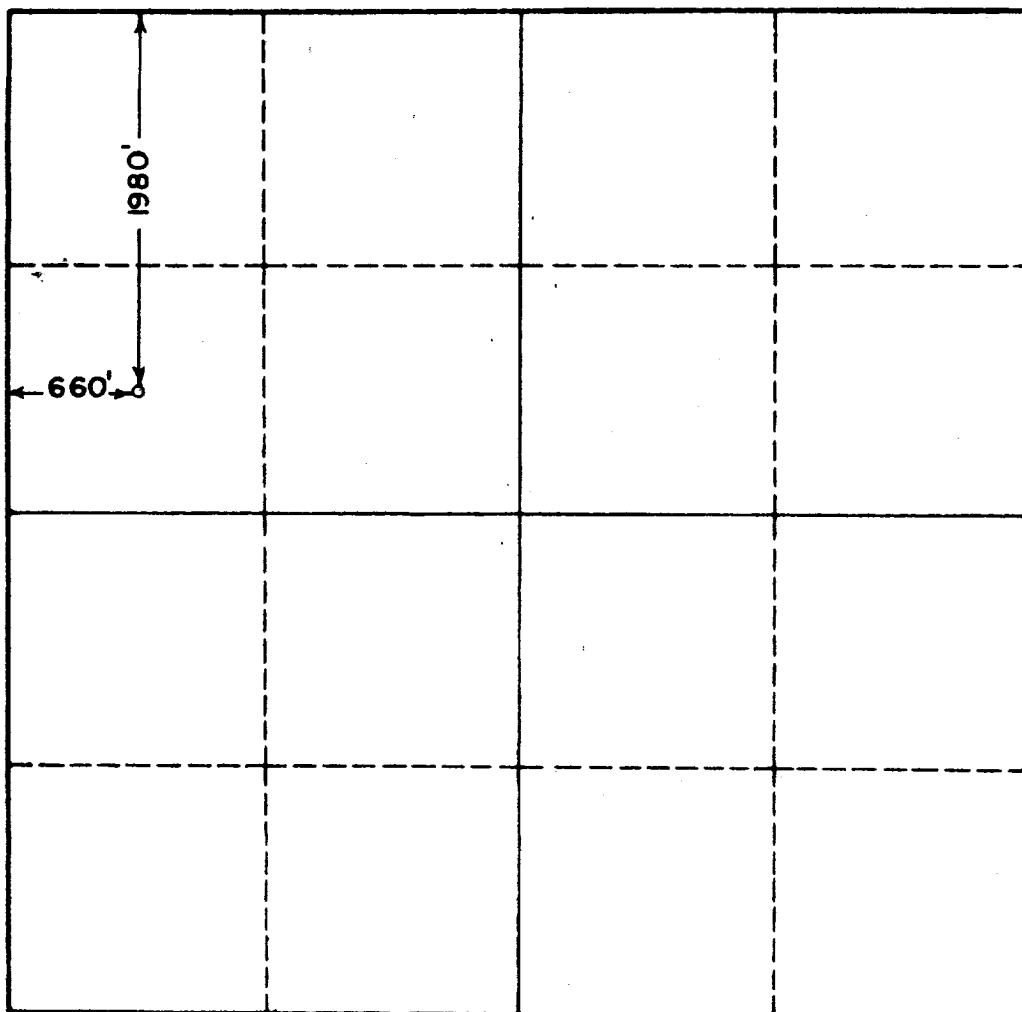

CERTIFICATION

I hereby certify that the information in SECTION A above is true and complete to the best of my knowledge and belief.

William A. & Edward R. Hudson

Name
Joint Operator

Position
William A. & Edward R. Hudson
 Company

Date
April 25, 1960

I hereby certify that the well location shown on the plat in SECTION B was plotted from field **676** of actual survey made by me or under my supervision, and that the same is true and correct to the best of my knowledge and belief.

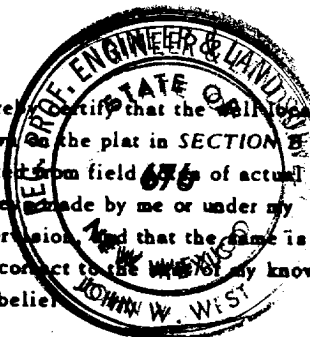

Date Surveyed
4-22-60
 Registered Professional Engineer and/or Land Surveyor, **JOHN W. WEST**

John W. West
 Certificate No.
N.M. - P.E. & L.S. NO. 676

0 330 660 990 1320 1650 1980 2310 2640 2970 3300 3630 3960 4290 4620 4950 5280 5610 5940 6270 6600