

(SUBMIT IN TRIPLICATE)

UNITED STATES
DEPARTMENT OF THE INTERIOR
GEOLOGICAL SURVEY

Land Office Las Cruces
Lease No. 029418 - (b)
Unit Lea "D"

RECEIVED
AUG 29 1960
C. C. ARTEZIA, OFFICE

SUNDRY NOTICES AND REPORTS ON WELLS

NOTICE OF INTENTION TO DRILL.....	<input checked="" type="checkbox"/>	SUBSEQUENT REPORT OF WATER SHUT-OFF.....	
NOTICE OF INTENTION TO CHANGE PLANS.....		SUBSEQUENT REPORT OF SHOOTING OR ACIDIZING.....	
NOTICE OF INTENTION TO TEST WATER SHUT-OFF.....		SUBSEQUENT REPORT OF ALTERING CASING.....	
NOTICE OF INTENTION TO RE-DRILL OR REPAIR WELL.....		SUBSEQUENT REPORT OF RE-DRILLING OR REPAIR.....	
NOTICE OF INTENTION TO SHOOT OR ACIDIZE.....		SUBSEQUENT REPORT OF ABANDONMENT.....	
NOTICE OF INTENTION TO PULL OR ALTER CASING.....		SUPPLEMENTARY WELL HISTORY.....	
NOTICE OF INTENTION TO ABANDON WELL.....			

(INDICATE ABOVE BY CHECK MARK NATURE OF REPORT, NOTICE, OR OTHER DATA)

Hobbs, New Mexico August 23, 1960

Lea "D"
Well No. 4 is located 1880 ft. from [N] line and 1980 ft. from [E] line of sec. 26

SW/4 NE/4 Sec. 26 17-S 31-E N.M.P.M.
(1/4 Sec. and Sec. No.) (Twp.) (Range) (Meridian)

Grayburg - Jackson Eddy New Mexico
(Field) (County or Subdivision) (State or Territory)

The elevation of the derrick floor above sea level is _____ ft.

DETAILS OF WORK

(State names of and expected depths to objective sands; show sizes, weights, and lengths of proposed casings; indicate mudding jobs, cementing points, and all other important proposed work)

Propose to drill with cable tools from surface to total depth of approximately 3900' in the San Andres formation. Casing program to be approximately as follows:

Size Hole	Size Casing	Casing Point	Sack Cement
10"	8-5/8"	825'	100
8"	5-1/2"	3833'	350

The Halliburton Pump & Plug Process will be used in cementing both strings of casing.

I understand that this plan of work must receive approval in writing by the Geological Survey before operations may be commenced.

Company Skelly Oil Company

Address P.O. Box 38

Hobbs, New Mexico

By [Signature]

Title Dist. Supt.

NEW MEXICO OIL CONSERVATION COMMISSION
WELL LOCATION AND ACREAGE DEDICATION PLAT

FORM C-128
Revised 5/1/57

SEE INSTRUCTIONS FOR COMPLETING THIS FORM ON THE REVERSE SIDE

SECTION A

Operator Skelly Oil Co			Lease Lea "D"			Well No. 4
Unit Letter G	Section 26	Township 17 S	Range 31 E	County Eddy		
Actual Footage Location of Well: 1880 feet from the North line and 1980 feet from the East line						
Ground Level Elev.	Producing Formation San Andres		Pool Grayburg - Jackson		Dedicated Acreage. 40 Acres	

1. Is the Operator the only owner in the dedicated acreage outlined on the plat below? YES ☒ NO ☐ ("Owner" means the person who has the right to drill into and to produce from any pool and to appropriate the production either for himself or for himself and another. (65-3-29 (e) NMSA 1955 Comp.)
2. If the answer to question one is "no," have the interests of all the owners been consolidated by communization or agreement, either in writing or otherwise? YES ☐ NO ☐ If answer is "yes," Type of Consolidation _____
3. If the answer to question two is "no," list all the owners and their respective interests below:

Owner	Land Description

SECTION B

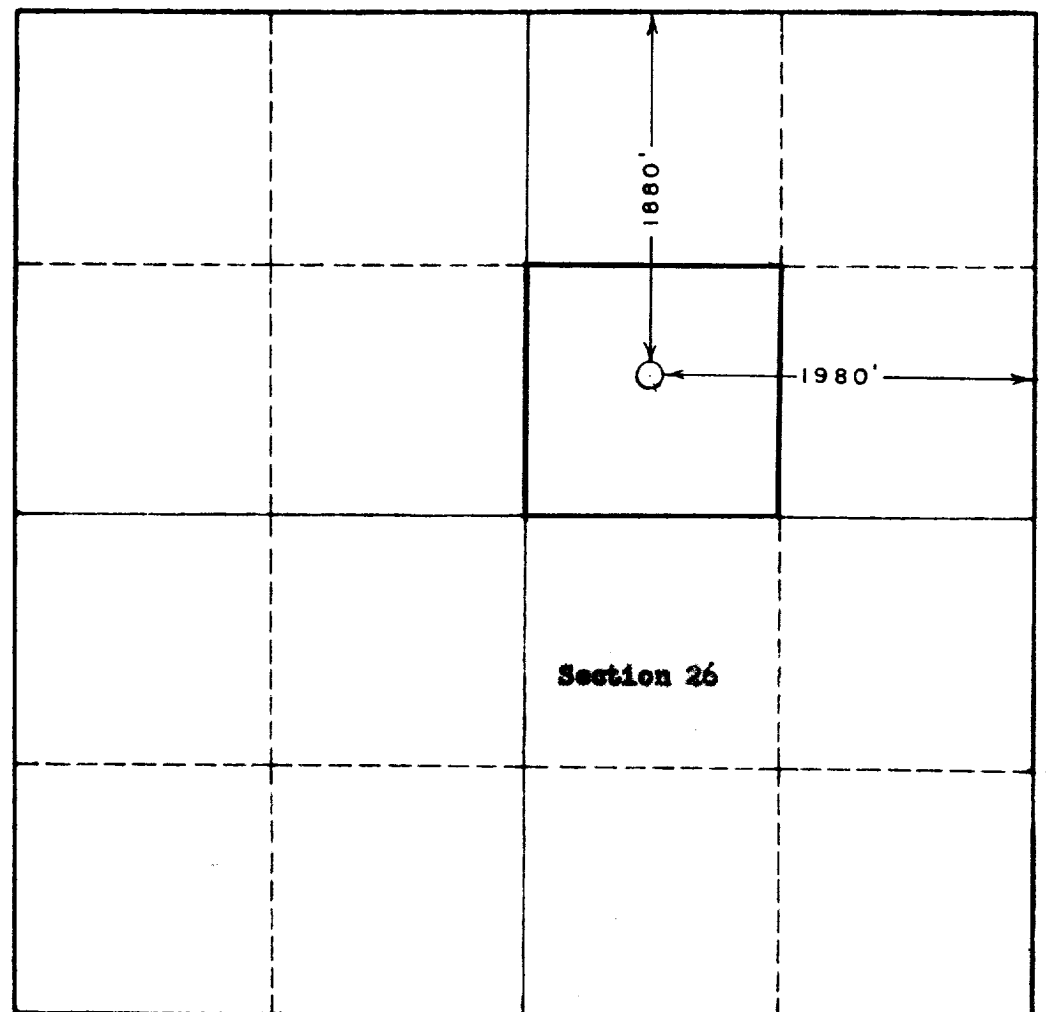

CERTIFICATION

I hereby certify that the information in SECTION A above is true and complete to the best of my knowledge and belief.

Name
[Signature]
Position
Dist. Supt.
Company
Skelly Oil Co.
Date
August 23, 1960

I hereby certify that the well location shown on the plat in SECTION B was plotted from field notes of actual surveys made by me or under my supervision, and that the same is true and correct to the best of my knowledge and belief.

Date Surveyed
Aug. 20, 1960
Registered Professional Engineer and/or Land Surveyor, **JOHN W. WEST**
[Signature]
Certificate No.
N.M. - P.E. & L.S. NO. 676

0 330 660 990 1320 1650 1980 2310 2640 2000 1500 1000 500 0