

NEW MEXICO  
OIL CONSERVATION COMMISSION  
~~EX-1028~~ 207 CARPER BUILDING  
~~MOBILE, NEW MEXICO~~ ARTESIA, NEW MEXICO

May, 1960  
No. A 66

SUPPLEMENT TO THE OIL PRORATION SCHEDULE

DATE May 17, 1960

PURPOSE: ALLOWABLE ASSIGNMENT FOR A NEW WELL

Effective May 11, 1960, an allowable of 33 barrels of oil per day or a total of 693 barrels for the month is hereby assigned to the Skelly Oil Co., Lea "B", S-D, 26-17-31, Grayburg-Jackson Pool.

MLA/bh

Skelly

T.N.M.

OIL CONSERVATION COMMISSION

*W. S. [Signature]*  
~~XXXXXXXXXXXX~~  
Supervisor, District No. 2

EXTRA COPY

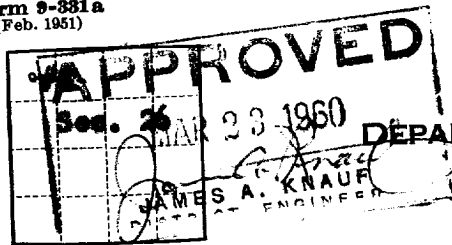
Form 9-381a  
(Feb. 1951)

(SUBMIT IN TRIPLICATE)

 UNITED STATES  
 DEPARTMENT OF THE INTERIOR  
 GEOLOGICAL SURVEY

 Land Office **Las Cruces**  
 Lease No. **029418 (B)**  
 Unit **Lea "B"**

RECEIVED

MAR 29 1960

## SUNDRY NOTICES AND REPORTS ON WELLS

		ARTESIA, OFFICE
NOTICE OF INTENTION TO DRILL	<input checked="" type="checkbox"/>	SUBSEQUENT REPORT OF WATER SHUT-OFF
NOTICE OF INTENTION TO CHANGE PLANS		SUBSEQUENT REPORT OF SHOOTING OR ACIDIZING
NOTICE OF INTENTION TO TEST WATER SHUT-OFF		SUBSEQUENT REPORT OF ALTERING CASING
NOTICE OF INTENTION TO RE-DRILL OR REPAIR WELL		SUBSEQUENT REPORT OF RE-DRILLING OR REPAIR
NOTICE OF INTENTION TO SHOOT OR ACIDIZE		SUBSEQUENT REPORT OF ABANDONMENT
NOTICE OF INTENTION TO PULL OR ALTER CASING		SUPPLEMENTARY WELL HISTORY
NOTICE OF INTENTION TO ABANDON WELL		

(INDICATE ABOVE BY CHECK MARK NATURE OF REPORT, NOTICE, OR OTHER DATA)

Hobbs, New Mexico

March 21, 19 60

Lea "B"

Well No. 8 is located 660 ft. from {N} line and 660 ft. from {E} line of sec. 26

NW/4 NW/4 Sec. 26 17-S 31-E N.M.P.M.

(1/4 Sec. and Sec. No.) (Twp.) (Range) (Meridian)

Grayburg Jackson Eddy New Mexico

(Field) (County or Subdivision) (State or Territory)

The elevation of the derrick floor above sea level is \_\_\_\_\_ ft.

## DETAILS OF WORK

(State names of and expected depths to objective sands; show sizes, weights, and lengths of proposed casings; indicate mudding jobs, cementing points, and all other important proposed work)

Propose to drill with cable tools from surface to total depth of approximately 3775' in the San Andres formation. Casing program to be approximately as follows:

Size Hole	Size Casing	Casing Point	Sacks Cement
10"	8-5/8"	780'	100
8"	5-1/2"	3665'	350

Halliburton Process will be used in cementing both strings of casing.

I understand that this plan of work must receive approval in writing by the Geological Survey before operations may be commenced.

Company Skelly Oil CompanyAddress Box 38Hobbs, New Mexico

By

Title

Dist. Supt.



**NEW MEXICO OIL CONSERVATION COMMISSION**  
**WELL LOCATION AND ACREAGE DEDICATION PLAT**

FORM C-128  
Revised 5/1/57

**SEE INSTRUCTIONS FOR COMPLETING THIS FORM ON THE REVERSE SIDE**

**SECTION A**

Operator <b>Skelly Oil Co.</b>			Lease <b>Lea "B"</b>		Well No. <b>8</b>
Unit Letter <b>D</b>	Section <b>26</b>	Township <b>17 South</b>	Range <b>31 East</b>	County <b>Eddy</b>	
Actual Footage Location of Well: <b>660</b> feet from the <b>North</b> line and <b>660</b> feet from the <b>West</b> line					
Ground Level Elev.	Producing Formation <b>San Andres</b>		Pool <b>Grayburg Jackson</b>		Dedicated Acreage: <b>40</b> Acres

1. Is the Operator the only owner in the dedicated acreage outlined on the plat below? YES ☒ NO \_\_\_\_\_. ("Owner" means the person who has the right to drill into and to produce from any pool and to appropriate the production either for himself or for himself and another. (65-3-29 (e) NMSA 1935 Comp.)
2. If the answer to question one is "no," have the interests of all the owners been consolidated by communitization agreement or otherwise? YES \_\_\_\_\_. If answer is "yes," Type of Consolidation \_\_\_\_\_
3. If the answer to question two is "no," list all the owners and their respective interests below:

Owner	Land Description

**SECTION B**

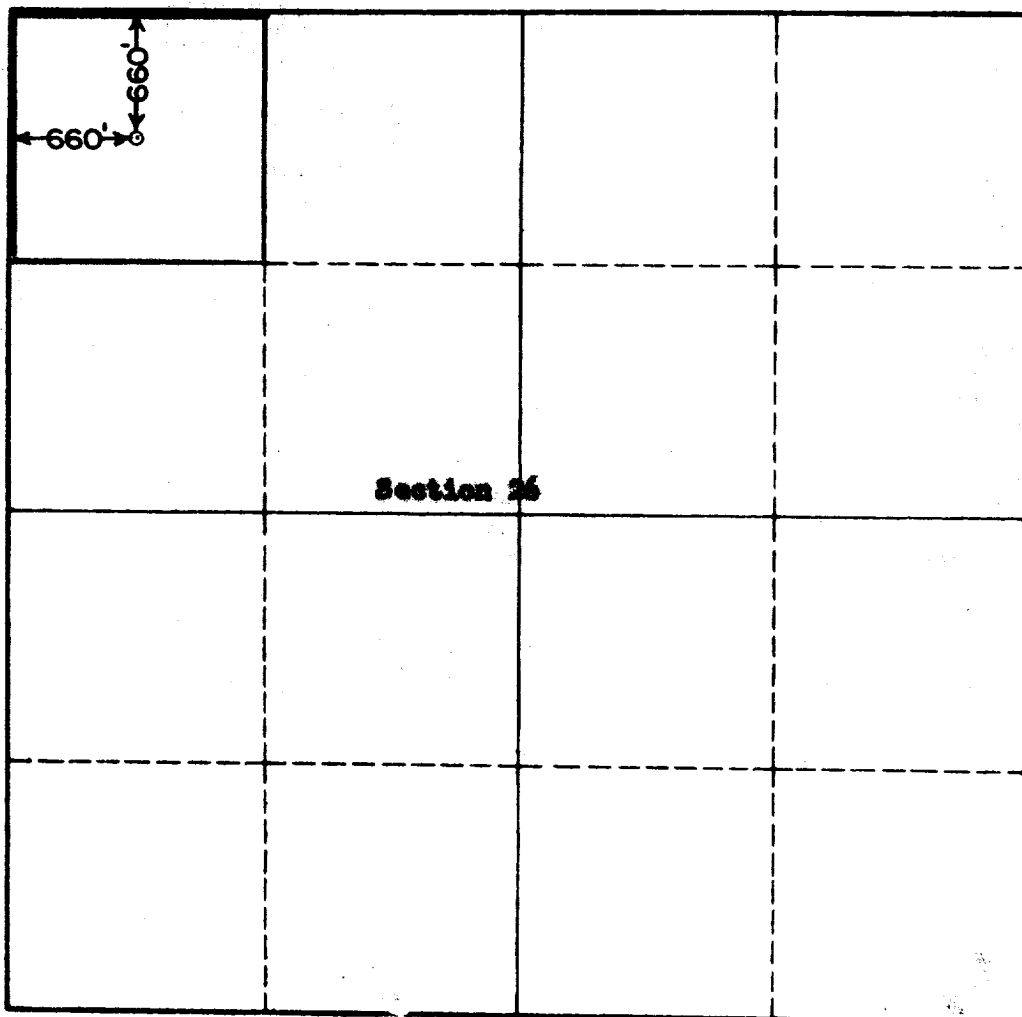

**CERTIFICATION**

I hereby certify that the information in SECTION A above is true and complete to the best of my knowledge and belief.

Name <i>J. J. Jackson</i>
Position <b>Dist. Supt.</b>
Company <b>Skelly Oil Company</b>
Date <b>March 21, 1960</b>

I hereby certify that the well location shown on the plat in SECTION B was plotted from field notes of actual surveys made by me or under my supervision, and that the same is true and correct to the best of my knowledge and belief.

Date Surveyed <b>3-19-60</b>
Registered Professional Engineer and/or Land Surveyor, <b>JOHN W. WEST</b>
<i>John W. West</i>
Certificate No. <b>N.M. - P.E. &amp; L.S. NO. 676</b>

