

(SUBMIT IN TRIPLICATE)

UNITED STATES  
DEPARTMENT OF THE INTERIOR  
GEOLOGICAL SURVEY

Land Office Las Cruces  
Lease No. 037375 (N)  
Unit Turner "B" SP

30-015-05444

SUNDRY NOTICES AND REPORTS ON WELLS

NOTICE OF INTENTION TO DRILL.....	<input checked="" type="checkbox"/>	SUBSEQUENT REPORT OF WATER SHUT-OFF.....	
NOTICE OF INTENTION TO CHANGE PLANS.....		SUBSEQUENT REPORT OF SHOOTING OR ACIDIZING.....	
NOTICE OF INTENTION TO TEST WATER SHUT-OFF.....		SUBSEQUENT REPORT OF ALTERING CASING.....	
NOTICE OF INTENTION TO RE-DRILL OR REPAIR WELL.....		SUBSEQUENT REPORT OF RE-DRILLING OR REPAIR.....	
NOTICE OF INTENTION TO SHOOT OR ACIDIZE.....		SUBSEQUENT REPORT OF ABANDONMENT.....	
NOTICE OF INTENTION TO PULL OR ALTER CASING.....		SUPPLEMENTARY WELL HISTORY.....	
NOTICE OF INTENTION TO ABANDON WELL.....			

(INDICATE ABOVE BY CHECK MARK NATURE OF REPORT, NOTICE, OR OTHER DATA)

August 14, 1958

Well No. 55 is located 1950 ft. from N line and 660 ft. from E line of sec. 29

NE 1/4 Sec. 29 17S 31E 104N  
(1/4 Sec. and Sec. No.) (Twp.) (Range) (Meridian)  
Grayburg-Jackson Edgar New Mexico  
(Field) (County or Subdivision) (State or Territory)

The elevation of the derrick floor above sea level is \_\_\_\_\_ ft.

DETAILS OF WORK

(State names of and expected depths to objective sands; show sizes, weights, and lengths of proposed casings; indicate mudding jobs, cementing points, and all other important proposed work)

Minclair Oil & Gas Company's Well No. 55, Turner "B" SP Lease

<u>10-3/4" Csg.</u>	<u>28.64</u>	<u>590'</u>	<u>350 cas</u>
<u>7" Csg.</u>	<u>17'</u>	<u>3650'</u>	<u>200 cas</u>

Propose to drill well with cable tools to depth of approximately 3650' to test the San Andres 3450' to Total Depth.

RECEIVED  
AUG 20 1958  
U. S. GEOLOGICAL SURVEY  
ARTESIA, NEW MEXICO

I understand that this plan of work must receive approval in writing by the Geological Survey before operations may be commenced.

Company Minclair Oil & Gas Company

Address P. O. Box 1490

Midland, Texas

By (H. L. Brown)

Title Division Clerk, Production Dept.

**APPROVED**

NEW MEXICO OIL CONSERVATION COMMISSION

AUG 20 1958

Well Location and Acreage Dedication Plat

Section A.

JOHN A. FROST  
DISTRICT ENGINEER

Date AUG 14, 1958

Operator SINCLAIR OIL & GAS COMPANY Lease TEXAS - 4.2.  
Well No. 95 Unit Letter B Section 29 Township 1400N Range 31E NMFM  
Located 1980 Feet From NORTH Line, 660 Feet From EAST Line  
County DEW G. L. Elevation \_\_\_\_\_ Dedicated Acreage 40 Acres  
Name of Producing Formation SAN ANTONIO Pool CLAYTON-JACKSON

1. Is the Operator the only owner\* in the dedicated acreage outlined on the plat below?  
Yes X No \_\_\_\_\_.
2. If the answer to question one is "no," have the interests of all the owners been consolidated by communitization agreement or otherwise? Yes \_\_\_\_\_ No \_\_\_\_\_. If answer is "yes," Type of Consolidation \_\_\_\_\_
3. If the answer to question two is "no," list all the owners and their respective interests below:

Owner

Land Description

_____	_____
_____	_____
_____	_____

Section B

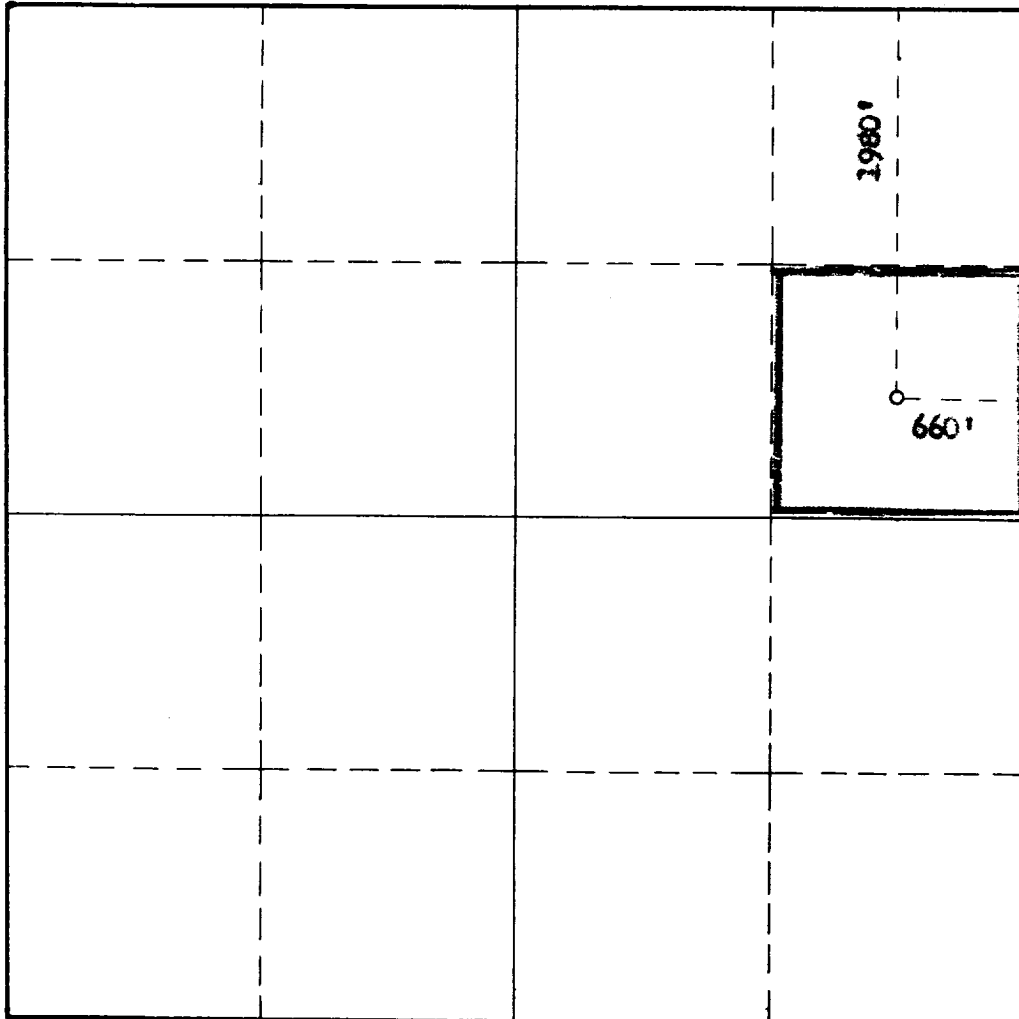

This is to certify that the information in Section A above is true and complete to the best of my knowledge and belief.

SINCLAIR OIL & GAS COMPANY

(Operator)

[Signature]  
(Representative) of Full

DEW, TEXAS

Address

This is to certify that the well location shown on the plat in Section B was plotted from field notes of actual surveys made by me or under my supervision and that the same is true and correct to the best of my knowledge and belief.

Date Surveyed 5/2/58

[Signature]  
Registered Professional  
Engineer and/or Land Surveyor.

Certificate No. 676

(See instructions for completing this form on the reverse side)

INSTRUCTIONS FOR COMPLETION:

1. Operator shall furnish and certify to the information called for in Section A.
2. Operator shall outline the dedicated acreage for both oil and gas wells on the plat in Section B.
3. A registered professional engineer or land surveyor registered in the State of New Mexico or approved by the Commission shall show on the plat the location of the well and certify this information in the space provided.
4. All distances shown on the plat must be from the outer boundaries of Section.
5. If additional space is needed for listing owners and their respective interests as required in question 3, Section A, please use space below

\* "Owner" means the person who has the right to drill into and to produce from any pool and to appropriate the production either for himself or for himself and another. (65-3-29 (e) NMSA 1953 Comp.)