

(SUBMIT IN TRIPLICATE)

UNITED STATES
DEPARTMENT OF THE INTERIOR
GEOLOGICAL SURVEYLand Office Las Cruces
Lease No. 029395 (b)
Unit Turner "B" SP
RECEIVED

JUL 26 1960

SUNDRY NOTICES AND REPORTS ON WELLS

ARTESIA OFFICE	
NOTICE OF INTENTION TO DRILL	<input checked="" type="checkbox"/> SUBSEQUENT REPORT OF WATER SHUT-OFF
NOTICE OF INTENTION TO CHANGE PLANS	SUBSEQUENT REPORT OF SHOOTING OR ACIDIZING
NOTICE OF INTENTION TO TEST WATER SHUT-OFF	SUBSEQUENT REPORT OF ALTERING CASING
NOTICE OF INTENTION TO RE-DRILL OR REPAIR WELL	SUBSEQUENT REPORT OF RE-DRILLING OR REPAIR
NOTICE OF INTENTION TO SHOOT OR ACIDIZE	SUBSEQUENT REPORT OF ABANDONMENT
NOTICE OF INTENTION TO PULL OR ALTER CASING	SUPPLEMENTARY WELL HISTORY
NOTICE OF INTENTION TO ABANDON WELL	

(INDICATE ABOVE BY CHECK MARK NATURE OF REPORT, NOTICE, OR OTHER DATA)

July 20, 1960

Well No. 69 is located 380 ft. from N line and 2010 ft. from E line of sec. 29
NE 1/4 Sec 29 17S 21E NMPM
(1/4 Sec. and Sec. No.) (Twp.) (Range) (Meridian)
Undesignated Eddy New Mexico
(Field) (County or Subdivision) (State or Territory)

The elevation of the derrick floor above sea level is _____ ft.

DETAILS OF WORK

(State names of and expected depths to objective sands; show sizes, weights, and lengths of proposed casings; indicate mudding jobs, cementing points, and all other important proposed work)

Sinclair Oil & Gas Company's Well No. 69, Turner "B" SP Lease

8-5/8" OD Casing	24#	1600' (or thru Salt)	650 sacks & Cure
4-1/2" OD Casing	9.5#	7400'	1000 sacks (or cement back into surface casing)

Propose to drill with rotary tools to a depth of approximately 7400' to test the Abo Reef 6900' to TD

I understand that this plan of work must receive approval in writing by the Geological Survey before operations may be commenced.

Company Sinclair Oil & Gas CompanyAddress P. O. Box 1470Midland, TexasBy R. D. Satterwhite
(R. D. Satterwhite)
Title Chief Clerk, Production Dept.

NEW MEXICO OIL CONSERVATION COMMISSION
WELL LOCATION AND ACREAGE DEDICATION PLAT

RECEIVED
FORM C-128
Revised 5/1/57

JUL 26 1960

SEE INSTRUCTIONS FOR COMPLETING THIS FORM ON THE REVERSE SIDE

SECTION A

Operator Sinclair Oil & Gas Company		Lease Turner "B" SP		ARTERIAL OFFICE Well No. 69	
Unit Letter B	Section 29	Township 17 South	Range 31 East	County Eddy	
Actual Footage Location of Well: 380 feet from the North line and 2310 feet from the East line					
Ground Level Elev.	Producing Formation Abo Reef		Pool	Dedicated Acreage: 40 Acres	

1. Is the Operator the only owner in the dedicated acreage outlined on the plat below? YES ☒ NO ____ . ("Owner" means the person who has the right to drill into and to produce from any pool and to appropriate the production either for himself or for himself and another. (65-3-29 (e) NMSA 1935 Comp.)
2. If the answer to question one is "no," have the interests of all the owners been consolidated by communitization agreement or otherwise? YES ____ NO ____ . If answer is "yes," Type of Consolidation ____
3. If the answer to question two is "no," list all the owners and their respective interests below:

Owner	Land Description

SECTION B

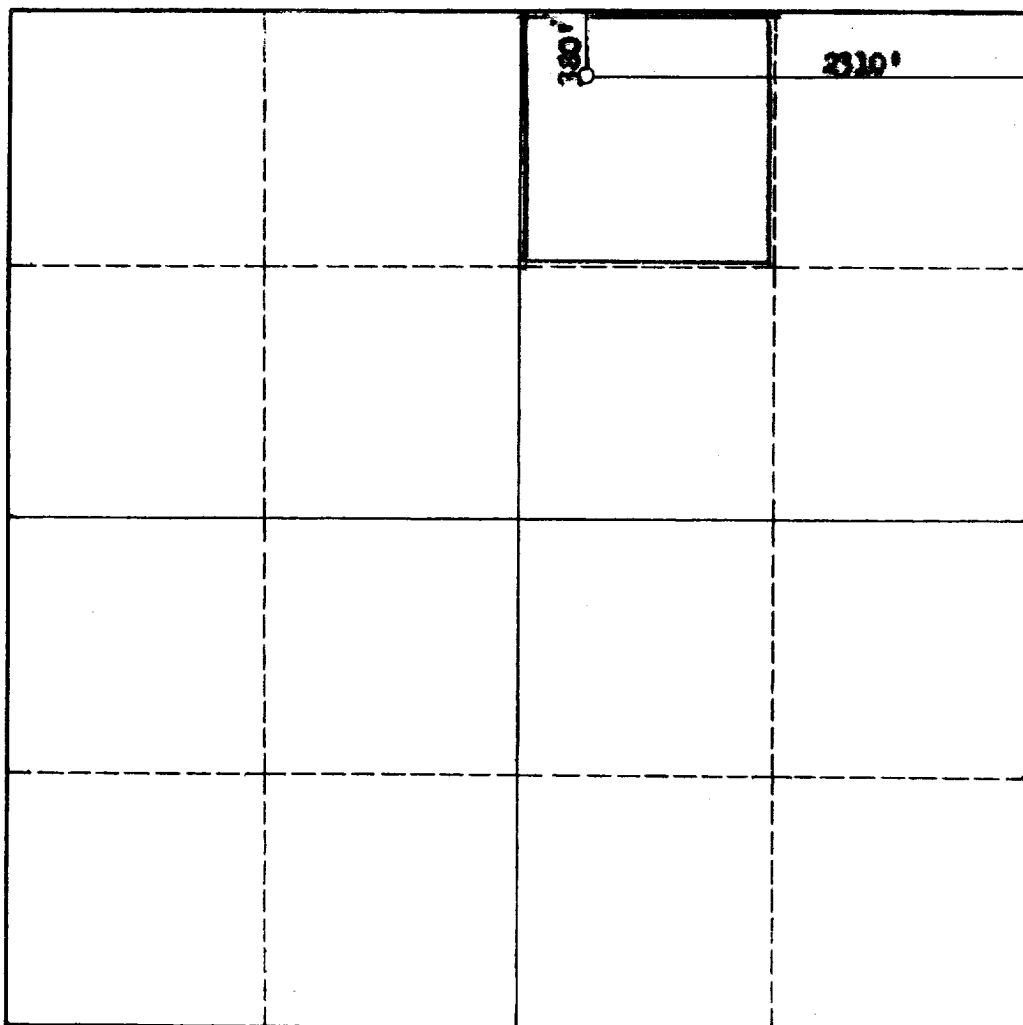

CERTIFICATION

I hereby certify that the information in SECTION A above is true and complete to the best of my knowledge and belief.

Name *[Signature]*
Position **Div. Clerk Prod. Dept.**
Company **Sinclair Oil & Gas Co.**
Date **July 20, 1960**

[Signature]
I hereby certify that the well location shown on the plat in SECTION B was plotted from field notes of actual surveys made by me or under my supervision, and that the same is true and correct to the best of my knowledge and belief.

Date Surveyed **7/20/60**
Registered Professional Engineer and/or Land Surveyor *[Signature]*

Certificate No.

676

0 330 660 990 1320 1650 1980 2310 2640 2000 1500 1000 500 0

INSTRUCTIONS FOR COMPLETION OF FORM C-128

1. Operator shall furnish and certify to the information called for in Section A.
2. Operator shall outline the dedicated acreage for *both* oil and gas wells on the plat in Section B.
3. A registered professional engineer or land surveyor registered in the State of New Mexico or approved by the Commission shall show on the plat the location of the well and certify ~~this~~ information in the space provided.
4. All distances shown on the plat must be from the outer boundaries of the Section.
5. If additional space is needed for listing owners and their respective interests as required in question 3 of Section A, please use space below.