

COPIES RECEIVED	
DISTRIBUTION	
SANTA FE	
FILE	
U.S.G.S.	
LAND OFFICE	
TRANSPORTER	OIL GAS
PRODUCTION OFFICE	
OPERATOR	

NEW MEXICO OIL CONSERVATION COMMISSION
Santa Fe, New Mexico

Form C-101
Revised (12/1/55)

NOTICE OF INTENTION TO DRILL

Notice must be given to the District Office of the Oil Conservation Commission and approval obtained before drilling or recompletion begins. If changes in the proposed plan are considered advisable, a copy of this notice showing such changes will be returned to the sender. Submit this notice in QUINTUPPLICATE. One copy will be returned following approval. See additional instructions in Rules and Regulations of the Commission. If State Land submit 6 Copies Attach Form C-128 in triplicate to first 3 copies of form C-101

Artesia, New Mexico
(Place)

November 22, 1961 E D
(Date)

OIL CONSERVATION COMMISSION
SANTA FE, NEW MEXICO

NOV 24 1961

Gentlemen:

You are hereby notified that it is our intention to commence the Drilling of a well to be known as

O. C. C.
ARTESIA, OFFICE

Yates Petroleum Corporation

(Company or Operator)

Culpepper
(Lease)

Well No. 1 NA-FW, in J The well is
(Unit)

located 1675 feet from the South line and 1725 feet from the

East

line of Section 30, T. 18N, R. 26E, NMPM.

(GIVE LOCATION FROM SECTION LINE) Wildcat Pool, Eddy County

If State Land the Oil and Gas Lease is No.

If patented land the owner is Frances Culpepper

Address Carlsbad, New Mexico

We propose to drill well with drilling equipment as follows: Cable Tool

The status of plugging bond is State-Wide

Drilling Contractor J. Lund

We intend to complete this well in the San Andres

formation at an approximate depth of 1000 feet.

D	C	B	A
E	F	G	H
L	K	<u>30</u> X J	I
M	N	O	P

1675 S & 1725 E

CASING PROGRAM

We propose to use the following strings of Casing and to cement them as indicated:

Size of Hole	Size of Casing	Weight per Foot	New or Second Hand	Depth	Sacks Cement
<u>12 1/2"</u>	<u>10"</u>	<u>32#</u>	<u>Second Hand</u>	<u>200'</u>	<u>Conductor</u>
<u>10"</u>	<u>7"</u>	<u>20#</u>	<u>New</u>	<u>960'</u>	<u>Landed</u>

If changes in the above plans become advisable we will notify you immediately.

ADDITIONAL INFORMATION (If recompletion give full details of proposed plan of work.)

Plans are to use 10" conductor only if cave and/or surface water make it necessary. The 7" casing will be landed just above pay zone. If production is indicated, the 10" conductor csg. will be pulled, (if any has been used) and the aforementioned 7" cemented sufficient to circulate.

Approved NOV 24 1961, 19.....
Except as follows:

Sincerely yours,

Yates Petroleum Corporation
(Company or Operator)

By R.W. Landenberger, Jr.

Position Co. Geologist

Send Communications regarding well to

Name R.W. Landenberger, Jr.

Address 309 Carper Bldg., Artesia, N. Mex.

OIL CONSERVATION COMMISSION

By M.L. Armstrong

NUMBER OF COPIES RECEIVED	
DISTRIBUTION	
SANTA FE	
FILE	
U.S.G.S.	
LAND OFFICE	
TRANSPORTER	OIL GAS
PRORATION OFFICE	
OPERATOR	

NEW MEXICO OIL CONSERVATION COMMISSION
WELL LOCATION AND ACREAGE DEDICATION PLAT
 SEE INSTRUCTIONS FOR COMPLETING THIS FORM ON THE REVERSE SIDE

FORM C-128
 Revised 5/1/57

NOV 24 1961

O. C. C.

SECTION A

ARTESIA, OFFICE

Operator Yates Petroleum Company		Lease Culpepper		Well No. 1 "A-F"	
Unit Letter J	Section 30	Township 18 N	Range 20 E	County Eddy	
Actual Footage Location of Well: 1675 feet from the S line and 1725 feet from the E line					
Ground Level Elev.	Producing Formation San Andres		Pool wildcat	Dedicated Acreage: 40 Acres	

1. Is the Operator the only owner in the dedicated acreage outlined on the plat below? YES ☒ NO ☐ . ("Owner" means the person who has the right to drill into and to produce from any pool and to appropriate the production either for himself or for himself and another. (65-3-29 (e) NMSA 1935 Comp.)
2. If the answer to question one is "no," have the interests of all the owners been consolidated by communitization agreement or otherwise? YES ☐ NO ☐ . If answer is "yes," Type of Consolidation _____
3. If the answer to question two is "no," list all the owners and their respective interests below:

Owner	Land Description

SECTION B

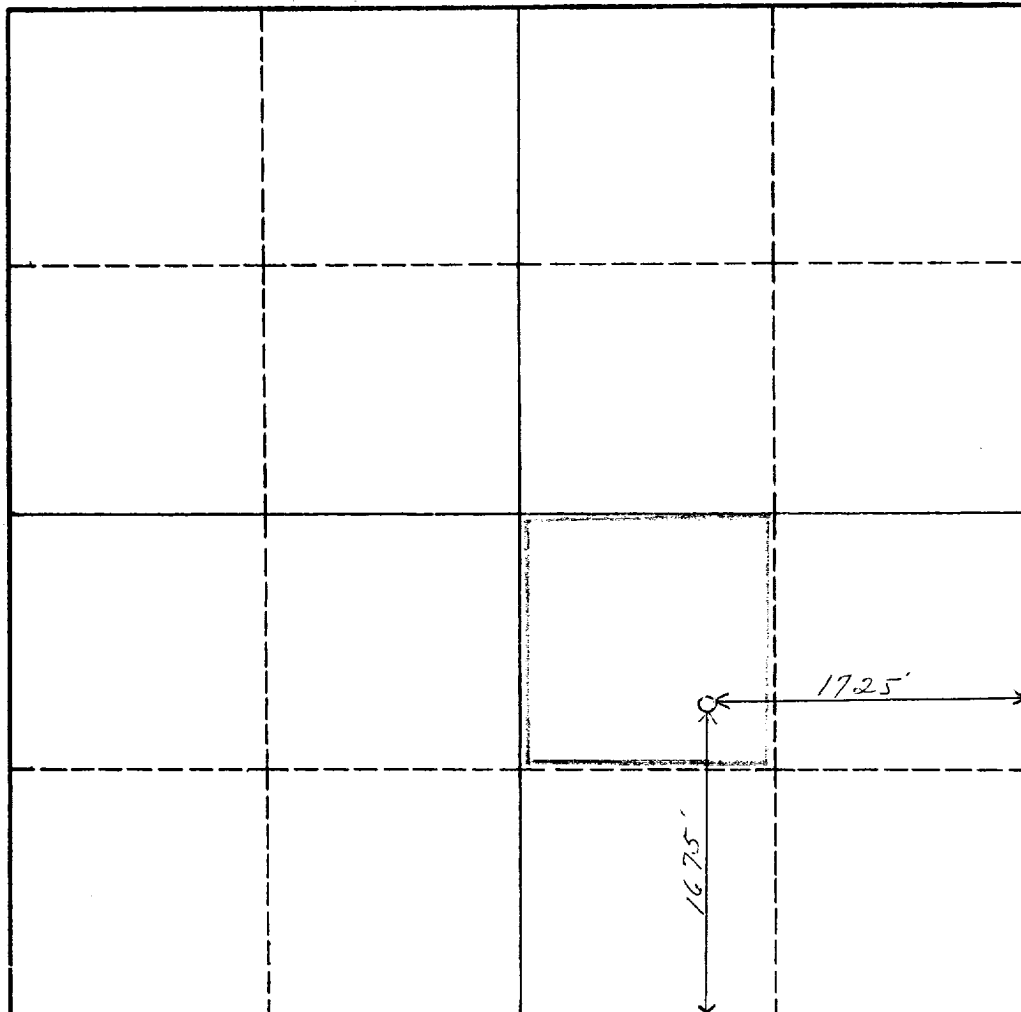

CERTIFICATION

I hereby certify that the information in SECTION A above is true and complete to the best of my knowledge and belief.

Name	<i>C. D. Zyma</i>
Position	<i>Agent</i>
Company	<i>Yates Pet. Co.</i>
Date	<i>11-23-61</i>

I hereby certify that the well location shown on the plat in SECTION B was plotted from field notes of actual surveys made by me or under my supervision, and that the same is true and correct to the best of my knowledge and belief.

Date Surveyed	<i>11/22/61</i>
Registered Professional Engineer and/or Land Surveyor	<i>B. E. Yates</i>
Certificate No.	<i>772</i>

0 330 660 990 1320 1650 1980 2310 2640 2000 1500 1000 500 0

INSTRUCTIONS FOR COMPLETION OF FORM C-128

1. Operator shall furnish and certify to the information called for in Section A.
2. Operator shall outline the dedicated acreage for *both* oil and gas wells on the plat in Section B.
3. A registered professional engineer or land surveyor registered in the State of New Mexico or approved by the Commission shall show on the plat the location of the well and certify this information in the space provided.
4. All distances shown on the plat must be from the outer boundaries of the Section.
5. If additional space is needed for listing owners and their respective interests as required in question 3 of Section A, please use space below.